

# TRANSPORTATION - EXECUTIVE SUMMARY

## Executive Summary

The Sacramento County Department of Transportation (SACDOT) is responsible for improving, operating and maintaining the transportation infrastructure of the Unincorporated Area of the County to ensure the safety and mobility of all users including motorists, pedestrians, bicyclists, and transit. SACDOT develops and constructs capital improvements to the county roadway, bikeway and pedestrian system, and carries out ongoing programs to operate, maintain and rehabilitate this system. The county's Transportation Capital Improvement Projects (CIP), including their scope, schedule and financing structure, are outlined in the seven-year Transportation Improvement Plan (TIP) which is updated annually and presented to the Board of Supervisors for adoption. SACDOT also prepares the Maintenance and Operations Program, which defines the programs and funding for maintaining the county transportation system. This is also presented to the Board of Supervisors for adoption each year.

The Five-Year CIP estimated cost of \$564.7 million is based on the 2007-14 TIP, as adopted by the Board of Supervisors. This CIP includes only the capital improvement projects that are currently being implemented by SACDOT. Maintenance and operations activities carried out by SACDOT, including major contracts for pavement rehabilitation and sidewalk/curb/gutter replacement, are not included in the CIP. These programs and activities are set forth in the annual Maintenance and Operations Program described above. Some of the projects included in the Transportation CIP will result in impacts to the Department's Operation and Maintenance Programs and budget. The cost of this impact is unknown at this time.

The Transportation CIP includes improvements to all components of the county's transportation system including roadways, pedestrian facilities, bikeways, and traffic signal systems. The projects include the construction of new facilities as well as the modification and expansion of existing facilities.

### Major transportation projects currently under construction or scheduled for construction include the following:

- 47<sup>th</sup> Avenue Transportation Improvements. **Estimated Total Cost: \$1,505,000**
- Americans with Disabilities Act (ADA) Transition Plan Implementation. **Estimated Total Cost: \$1,827,000**
- Asphalt Concrete Overlay Project, Phase I. **Estimated Total Cost: \$3,902,000**
- Bradshaw Road - Calvine Road to Florin Road. **Estimated Total Cost: \$19,571,000**
- Countywide Sidewalk Continuity Project, Phase IIB. **Estimated Total Cost: \$3,301,000**
- Florin Road Enhancements. **Estimated Total Cost: \$3,368,000**
- Franklin Boulevard Streetscape. **Estimated Total Cost: \$6,030,000**
- Hazel Avenue – U.S. Highway 50 to Curragh Downs Drive, Phase I. **Estimated Total Cost: \$28,676,000**
- Hedge Avenue at State Route 16 (Jackson Road). **Estimated Total Cost: \$1,029,000**
- Intersection Improvements - Disabled Access 05/06. **Estimated Total Cost: \$2,596,000**

- MacReady Avenue Reconstruction. **Estimated Total Cost: \$4,509,000**
- McClellan Economic Development Areas (EDA) Grant Project. **Estimated Total Cost: \$9,420,000**
- North Kiefer Boulevard - Closure at Kiefer Boulevard. **Estimated Total Cost: \$1,029,000**
- North Vineyard Traffic Signals. **Estimated Total Cost: \$3,630,000**
- Pavement Maintenance Project 06/07. **Estimated Total Cost: \$7,860,000**
- Pedestrian Master Plan Implementation Project - Various Locations. **Estimated Total Cost: \$6,000,000**
- South Watt Avenue - State Route 16 (Jackson Road) to Kiefer Boulevard. **Estimated Total Cost: \$6,237,000**
- Tobacco Pavement Maintenance Project. **Estimated Total Cost: \$1,650,000**
- Vineyard Road Bridge at Laguna Creek. **Estimated Total Cost: \$5,431,000**
- Vintage Park - Churchill Downs Traffic Calming Project. **Estimated Total Cost: \$296,000**
- Waterman Road Landscaping Project. **Estimated Total Cost: \$1,878,000**
- Watt Avenue at Light Rail Transit (LRT) - Grade Separation. **Estimated Total Cost: \$22,515,000**
- Watt Avenue Enhancements, Phase II. **Estimated Total Cost: \$9,492,000**

**Projects currently in development include the following:**

- Construction of new on and off-street bikeways to implement the county's Bikeway Master Plan.
- Installation of disabled access improvements.
- Widening and construction of pedestrian, bicycle and aesthetic improvements on several major county roadways including Hazel Avenue, Fair Oaks Boulevard, Elkhorn Boulevard, Greenback Lane, Madison Avenue, and Bradshaw Road.
- Development and implementation of a Pedestrian Master Plan and Americans with Disabilities (ADA) Transition Plan for the Unincorporated Area of Sacramento County.
- Construction of improvements to enhance safety, capacity and bicycle, pedestrian and transit access on Watt Avenue between Highway 50 and Folsom Boulevard.
- Construction of streetscape and other transportation enhancements in the Folsom Boulevard, Florin Road, Franklin Boulevard and Watt Avenue corridors.

Transportation projects are financed by various funding sources including the Measure A Sales Tax, the countywide roadway development fee, special roadway financing districts, and state and federal funds. These sources are dedicated for transportation uses and fully fund the projects described in this CIP.

# TRANSPORTATION

## SUMMARY

PROJ. #	PROJECT	PRIOR YEARS	FISCAL YEAR 2007-08	FISCAL YEAR 2008-09	FISCAL YEAR 2009-10	FISCAL YEAR 2010-11	FISCAL YEAR 2011-12	TOTAL
1	47th Avenue Transportation Improvements	\$275,000	\$1,230,000	\$0	\$0	\$0	\$0	<b>\$1,505,000</b>
2	Americans with Disabilities Act (ADA) Transition Plan Implementation	100,000	335,000	1,392,000	0	0	0	<b>1,827,000</b>
3	Asphalt Concrete Overlay Project - Phase I	150,000	3,752,000	0	0	0	0	<b>3,902,000</b>
4	Asphalt Concrete Overlay Project - Phase II	0	150,000	3,583,000	0	0	0	<b>3,733,000</b>
5	Asphalt Concrete Overlay Project - Transportation Bond, Phase I	0	150,000	3,350,000	0	0	0	<b>3,500,000</b>
6	Auburn Boulevard Enhancements	0	0	292,000	150,000	549,000	473,000	<b>1,464,000</b>
7	Bikeway Master Plan Construction, Phase II	296,000	0	1,333,000	313,000	0	0	<b>1,942,000</b>
8	Bikeway Master Plan Implementation - Various Locations	580,000	240,000	240,000	240,000	240,000	240,000	<b>1,780,000</b>
9	Bikeway Master Plan Update	0	880,000	0	0	0	0	<b>880,000</b>
10	Bradshaw Road - Calvine Road to Florin Road	2,317,000	4,482,000	9,103,000	3,669,000	0	0	<b>19,571,000</b>
11	Countywide Sidewalk Continuity Project, Phase II	781,000	309,000	1,461,000	750,000	0	0	<b>3,301,000</b>
12	Countywide Sidewalk Continuity Project, Phase III	157,000	72,000	230,000	495,000	2,088,000	0	<b>3,042,000</b>
13	Countywide Street Beautification Project	0	103,000	404,000	144,000	556,000	200,000	<b>1,407,000</b>
14	Elk Grove-Florin Road Bridge Replacement	120,000	185,000	1,088,000	630,000	0	0	<b>2,023,000</b>
15	Elk Grove-Florin Road - Gerber Road to Florin Road	478,000	277,000	3,037,000	3,871,000	0	0	<b>7,663,000</b>
16	Elkhorn Boulevard - Watt Avenue to Don Julio Boulevard	2,094,000	0	3,670,000	3,825,000	0	0	<b>9,589,000</b>
17	Elverta Road - Dutch Haven Boulevard to Watt Avenue	1,512,000	3,085,000	6,916,000	0	0	0	<b>11,513,000</b>

PROJ. #	PROJECT	PRIOR YEARS	FISCAL YEAR 2007-08	FISCAL YEAR 2008-09	FISCAL YEAR 2009-10	FISCAL YEAR 2010-11	FISCAL YEAR 2011-12	TOTAL
18	Elverta Road - Rio Linda Boulevard to Dutch Haven Boulevard	\$0	\$0	\$0	\$0	\$665,000	\$2,649,000	\$3,314,000
19	Fair Oaks Boulevard - Marconi Avenue to Engle Road	958,000	73,000	2,181,000	5,581,000	2,868,000	0	11,661,000
20	Florin Road Enhancements	1,393,000	1,975,000	0	0	0	0	3,368,000
21	Franklin Boulevard Streetscape	2,245,000	3,785,000	0	0	0	0	6,030,000
22	Freedom Park Drive / Watt Avenue Enhancements	81,000	850,000	917,000	2,752,000	0	0	4,600,000
23	Freeport Regional Water Authority Median Landscaping Improvements	456,000	1,150,000	1,725,000	0	0	0	3,331,000
24	Fruitridge Road and South Watt Avenue Intersection	83,000	327,000	1,110,000	0	0	0	1,520,000
25	Gerber Road - Elk Grove-Florin Road to Gerber Creek Crossing #3	1,000,000	3,198,000	4,371,000	3,074,000	0	0	11,643,000
26	Greenback Lane - Fair Oaks Boulevard to Hazel Avenue	346,000	150,000	1,000,000	3,199,000	9,673,000	10,791,000	25,159,000
27	Hazel Avenue - Curragh Downs Drive to Madison Avenue, Phase II	0	0	564,000	3,556,000	7,344,000	18,136,000	29,600,000
28	Hazel Avenue - U.S. Highway 50 to Curragh Downs Drive, Phase I	7,720,000	6,104,000	14,852,000	0	0	0	28,676,000
29	Hazel Avenue Intelligent Transportation System (ITS) Project	0	75,000	183,000	182,000	183,000	182,000	805,000
30	Hazel Avenue Soundwall and Demolition	0	6,263,000	6,424,000	7,454,000	453,000	0	20,594,000
31	Hedge Avenue at State Route 16 (Jackson Road)	99,000	930,000	0	0	0	0	1,029,000
32	Hurley Way Revitalization Planning Study - Watt Avenue to American River Parkway	83,000	77,000	0	0	0	0	160,000
33	Interstate 5 (I-5) at Metro Air Parkway Interchange	1,946,000	582,000	1,870,000	4,988,000	13,681,000	0	23,067,000
34	Intersection Improvements - Disabled Access 05/06	968,000	1,628,000	0	0	0	0	2,596,000
35	Intersection Improvements - Disabled Access, Phase III	118,000	844,000	505,000	0	0	0	1,467,000

PROJ. #	PROJECT	PRIOR YEARS	FISCAL YEAR 2007-08	FISCAL YEAR 2008-09	FISCAL YEAR 2009-10	FISCAL YEAR 2010-11	FISCAL YEAR 2011-12	TOTAL
36	Left-Turn Lane Projects - Various Locations	\$0	\$25,000	\$80,000	\$60,000	\$240,000	\$60,000	\$465,000
37	MacReady Avenue Reconstruction	298,000	1,656,000	2,555,000	0	0	0	4,509,000
38	Madison Avenue - Fair Oaks Boulevard to Hazel Avenue	456,000	202,000	678,000	1,790,000	3,594,000	10,332,000	17,052,000
39	Madison Avenue - Hazel Avenue to Greenback Lane	0	0	0	694,000	2,379,000	4,237,000	7,310,000
40	Madison Avenue Tree Planting Project	41,000	899,000	0	0	0	0	940,000
41	Major Intersection Projects - Various Locations	0	100,000	200,000	1,400,000	100,000	200,000	2,000,000
42	McClellan Economic Development Areas (EDA) Grant Project	545,000	3,754,000	5,121,000	0	0	0	9,420,000
43	Neighborhood Traffic Management Program	300,000	500,000	750,000	1,000,000	1,000,000	1,000,000	4,550,000
44	North Kiefer Boulevard - Closure at Kiefer Boulevard	134,000	370,000	525,000	0	0	0	1,029,000
45	North Vineyard Traffic Signals	703,000	822,000	2,105,000	0	0	0	3,630,000
46	Pavement Maintenance Project 06/07	123,000	7,737,000	0	0	0	0	7,860,000
47	Pedestrian Master Plan Implementation Project - Various Locations	116,000	449,000	5,435,000	0	0	0	6,000,000
48	Power Inn Road - Florin Road to Elder Creek Road	0	0	193,000	326,000	1,143,000	0	1,662,000
49	Sloughhouse Road at Grantline Road Traffic Signal	45,000	605,000	0	0	0	0	650,000
50	South Mather Roadways Improvements	1,000,000	2,965,000	8,585,000	20,012,000	15,813,000	15,812,000	64,187,000
51	South Sacramento Traffic Calming Project, Phase II	35,000	155,000	0	0	0	0	190,000
52	South Watt Avenue - Florin Road to State Route 16 (Jackson Road)	0	0	363,000	781,000	1,255,000	7,704,000	10,103,000
53	South Watt Avenue - State Route 16 (Jackson Road) to Kiefer Boulevard	1,107,000	4,460,000	670,000	0	0	0	6,237,000

PROJ. #	PROJECT	PRIOR YEARS	FISCAL YEAR 2007-08	FISCAL YEAR 2008-09	FISCAL YEAR 2009-10	FISCAL YEAR 2010-11	FISCAL YEAR 2011-12	TOTAL
54	State Route 99 at Elverta Road Interchange	\$ 14,000	\$ 250,000	\$ 1,800,000	\$ 3,360,000	\$ 12,200,000	\$ 12,200,000	\$ 29,824,000
55	Tobacco Pavement Maintenance Project	74,000	1,576,000	0	0	0	0	1,650,000
56	Vineyard Road Bridge at Laguna Creek	114,000	625,000	2,016,000	2,676,000	0	0	5,431,000
57	Vineyard Road Improvement Project	0	0	0	113,000	622,000	3,915,000	4,650,000
58	Vintage Park - Churchill Downs Traffic Calming Project	35,000	261,000	0	0	0	0	296,000
59	Walerga Road Corridor Improvements	0	250,000	1,475,000	0	0	0	1,725,000
60	Waterman Road Landscaping Project - Calvine Road to Vintage Park Drive	90,000	222,000	1,566,000	0	0	0	1,878,000
61	Watt Avenue at Light Rail Transit (LRT) - Grade Separation	14,554,000	7,961,000	0	0	0	0	22,515,000
62	Watt Avenue at Light Rail Transit (LRT) - Grade Separation Landscaping Project	0	75,000	650,000	0	0	0	725,000
63	Watt Avenue at Roseville Road - Pedestrian and Bicycle Access Improvements	30,000	120,000	0	0	0	0	150,000
64	Watt Avenue at U.S. Highway 50 Interchange	1,393,000	2,882,000	3,141,000	26,227,000	18,877,000	0	52,520,000
65	Watt Avenue Enhancements, Phase II	6,616,000	2,876,000	0	0	0	0	9,492,000
66	Watt Avenue Queue Jump and Right Turn Lane Project	306,000	1,380,000	524,000	0	0	0	2,210,000
67	White Rock Road Improvements	100,000	1,300,000	100,000	6,000,000	8,300,000	10,800,000	26,600,000
	<b>TOTAL</b>	<b>\$54,585,000</b>	<b>\$87,738,000</b>	<b>\$110,333,000</b>	<b>\$109,312,000</b>	<b>\$103,823,000</b>	<b>\$98,931,000</b>	<b>\$564,722,000</b>

**PRIOR-YEAR COMPLETED/CANCELLED PROJECTS SUMMARY**

PROJ. #	PROJECT	PRIOR YEARS	FISCAL YEAR 2006-07	FISCAL YEAR 2007-08	FISCAL YEAR 2008-09	FISCAL YEAR 2009-10	FISCAL YEAR 2010-11	TOTAL	REASON DROPPED
3	Antelope North Road Project	\$0	\$0	\$0	\$368,000	\$683,000	\$2,353,000	<b>\$3,404,000</b>	Developer Changed
4	Arden Way Intelligent Transportation System (ITS) Corridor Project	233,000	2,129,000	0	0	0	0	<b>2,362,000</b>	Project Completed
10	Bradshaw Road - Florin Road to Morrison Creek	6,441,000	7,168,000	0	0	0	0	<b>13,609,000</b>	Project Completed
11	Calvine Road - Kingsbridge Drive to Vineyard Road	13,619,000	1,901,000	0	0	0	0	<b>15,520,000</b>	Project Completed
14	Elder Creek Road at South Watt Avenue	263,000	1,275,000	0	0	0	0	<b>1,538,000</b>	Project Completed
19	Excelsior Road at State Route 16 (Jackson Road)	1,949,000	5,396,000	0	0	0	0	<b>7,345,000</b>	Project Completed
21	Florin Road Enhancements - Stockton Boulevard to Elk Grove-Florin Road	975,000	2,364,000	0	0	0	0	<b>3,339,000</b>	Project Completed
22	Franklin Boulevard Streetscape - Fruitridge Road to Florin Road	970,000	2,511,000	0	0	0	0	<b>3,481,000</b>	Name Change to Franklin Boulevard Streetscape
23	Freedom Park Drive - Pedestrian and Streetscape Project	439,000	1,028,000	0	0	0	0	<b>1,467,000</b>	Name Change to Freedom Park Drive / Watt Avenue Enhancements
25	Fulton Avenue Enhancements, Phase II	2,718,000	5,139,000	0	0	0	0	<b>7,857,000</b>	Project Completed
35	Intersection Improvements - Disabled Access 04/05	447,000	757,000	0	0	0	0	<b>1,204,000</b>	Project Completed
38	MacReady Avenue Reconstruction - Old Placerville Road to Bleckley Street	153,000	344,000	3,153,000	0	0	0	<b>3,650,000</b>	Name Change to MacReady Avenue Reconstruction
46	North Watt Avenue Enhancements, Phase II - Poplar Boulevard to Freedom Park Drive	1,982,000	3,331,000	0	0	0	0	<b>5,313,000</b>	Project Completed

PROJ. #	PROJECT	PRIOR YEARS	FISCAL YEAR 2006-07	FISCAL YEAR 2007-08	FISCAL YEAR 2008-09	FISCAL YEAR 2009-10	FISCAL YEAR 2010-11	TOTAL	REASON DROPPED
47	North Watt Avenue Enhancements, Phase III - Antelope Road to Capital City Freeway	\$0	\$555,000	\$628,000	\$2,350,000	\$0	\$0	\$3,533,000	Combined with project 22, Freedom Park Drive / Watt Avenue Enhancements
52	State Route 99 at Elverta Road Intersection Improvements and State Route 99 at Elkhorn Boulevard Interchange Signalization	313,000	256,000	0	2,507,000	0	0	3,076,000	For Future Improvements
53	Sunset Avenue/Main Avenue Bikeway Project	306,000	754,000	0	0	0	0	1,060,000	Project Completed
54	U.S. Highway 50 at Watt Avenue Interchange	1,159,000	727,000	924,000	1,159,000	16,883,000	7,804,000	28,656,000	Name Change to Watt Avenue at U.S. Highway 50 Interchange
56	Vineyard Rd Improvement Project - Calvine Road to Mission Hill Drive	735,000	3,915,000	1,333,000	0	0	0	5,983,000	Name Change to Vineyard Road Improvement Project
62	Watt Ave Transit Priority and Mobility Enhancements, Phase III	200,000	2,525,000	0	0	0	0	2,725,000	Name Change to Watt Avenue Enhancements, Phase II
<b>TOTAL</b>		<b>\$32,902,000</b>	<b>\$42,075,000</b>	<b>\$6,038,000</b>	<b>\$6,384,000</b>	<b>\$17,566,000</b>	<b>\$10,157,000</b>	<b>\$115,122,000</b>	



**47<sup>th</sup> Avenue Transportation Improvements**

**Department:** Transportation

**Estimated Project Cost:** \$1,505,000

**Expected Completion Date:** 2008

**Funding Sources:** SAFETEA-LU (CMAQ)  
New Faze Dev.

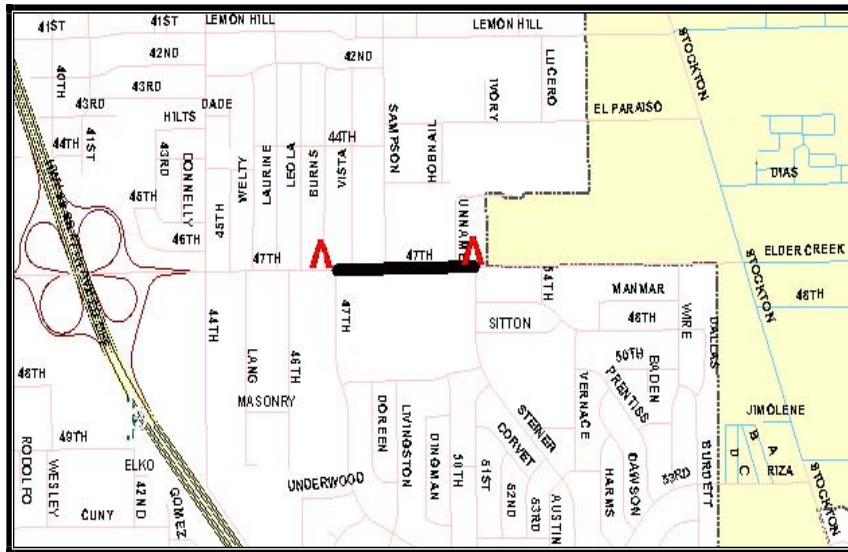

**Project Description:**

This project has requested grant funds for public transportation improvements (sidewalks, landscaping and streetscape enhancements, parking improvements, accessibility improvements, and other bicycle, pedestrian and transit access enhancements) for 47<sup>th</sup> Avenue corridor.

**Operating Budget Impact:**

The operating cost impact of this project is unknown at this time.

**47th Avenue Transportation Improvements**

Project Costs	Prior Years	Fiscal Year 2007-08	Fiscal Year 2008-09	Fiscal Year 2009-10	Fiscal Year 2010-11	Fiscal Year 2011-12	Total
Construction Costs	0	1,082,000	0	0	0	0	1,082,000
Project Management/ Design	275,000	0	0	0	0	0	275,000
Construction Inspection	0	148,000	0	0	0	0	148,000
<b>TOTAL</b>	<b>275,000</b>	<b>1,230,000</b>	<b>0</b>	<b>0</b>	<b>0</b>	<b>0</b>	<b>1,505,000</b>

Funding Sources	Prior Years	Fiscal Year 2007-08	Fiscal Year 2008-09	Fiscal Year 2009-10	Fiscal Year 2010-11	Fiscal Year 2011-12	Total
SAFETEA-LU (CMAQ)	0	1,082,000	0	0	0	0	1,082,000
New Faze Dev.	275,000	148,000	0	0	0	0	423,000
<b>TOTAL</b>	<b>275,000</b>	<b>1,230,000</b>	<b>0</b>	<b>0</b>	<b>0</b>	<b>0</b>	<b>1,505,000</b>

**Americans with Disabilities Act (ADA) Transition Plan Implementation**

**Department:** Transportation

**Estimated Project Cost:** \$1,827,000

**Expected Completion Date:** 2009

**Funding Sources:** Measure A Sales Tax

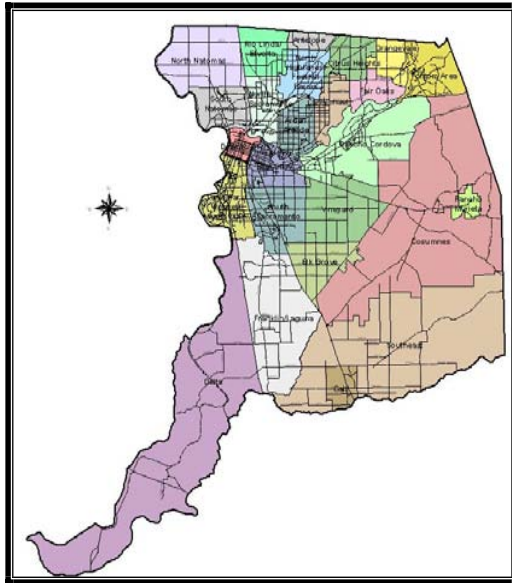

**Project Description:**

Sacramento County's Americans with Disabilities Act (ADA) Transition Plan provides for the installation of new curb ramps as well as the modification of existing curb ramps, and other street and sidewalk access improvements to ensure that accessibility is provided to all users of the sidewalk, walkways, and multipurpose lanes (roadway shoulders) within the unincorporated county public rights-of-way.

ADA requires that all public agencies develop a transition plan for the installations of curb ramps or other sloped areas at all locations where walkways cross curbs. The plan is required to give a schedule for curb ramp installation as well as other improvements necessary to achieve accessibility for persons with disabilities. The main purpose of this transition plan is to describe the curb ramp and other pedestrian facility needs in the unincorporated County and to outline the recommended procedures for implementing and scheduling remedial work to provide a complying system of curb ramps, pedestrian signals, and sidewalks.

Americans with Disabilities Act (ADA) Transition Plan Implementation							
Project Costs	Prior Years	Fiscal Year 2007-08	Fiscal Year 2008-09	Fiscal Year 2009-10	Fiscal Year 2010-11	Fiscal Year 2011-12	Total
Construction Costs	0	0	1,100,000	0	0	0	1,100,000
Project Management/ Design	100,000	296,000	31,000	0	0	0	427,000
Right-of-Way Purchase	0	39,000	140,000	0	0	0	179,000
Construction Inspection	0	0	121,000	0	0	0	121,000
<b>TOTAL</b>	<b>100,000</b>	<b>335,000</b>	<b>1,392,000</b>	<b>0</b>	<b>0</b>	<b>0</b>	<b>1,827,000</b>

Funding Sources	Prior Years	Fiscal Year 2007-08	Fiscal Year 2008-09	Fiscal Year 2009-10	Fiscal Year 2010-11	Fiscal Year 2011-12	Total
Measure A Sales Tax	100,000	335,000	1,392,000	0	0	0	1,827,000

**Asphalt Concrete Overlay Project - Phase I**

**Department:** Transportation

**Estimated Project Cost:** \$3,902,000

**Expected Completion Date:** 2008

**Funding Sources:** Road Fund  
Federal (SAFETEA-LU)

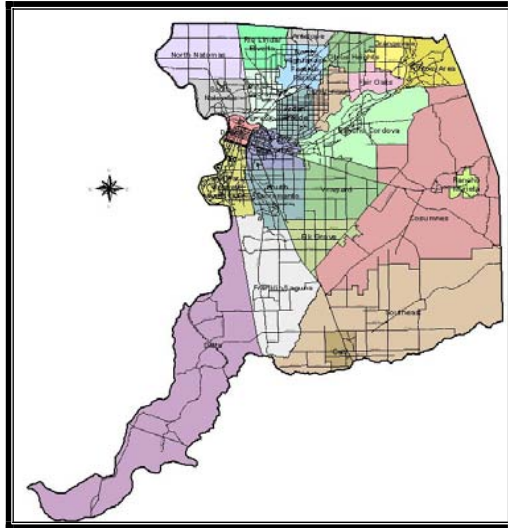

**Project Description:**

This project consists of placing a 2-inch thick rubberized asphalt concrete pavement overlay, repairing failed pavement (base repair), cold planing the pavement to accommodate the overlay, curb and gutter key cuts, adjusting manholes to grade, removing and replacing concrete curb, gutter, and sidewalk, installing sidewalk accessibility curb ramps, replacing inductive loop detectors, installing hand holes, modifying pedestrian pushbuttons, and re-striping.

**Project locations:**

- 47<sup>th</sup> Avenue - Franklin Boulevard to 44<sup>th</sup> Street
- Coloma Road - Sunrise Boulevard to Gold Meadow Way
- Fair Oaks Boulevard - Munroe Street to Watt Avenue
- Fair Oaks Boulevard - San Juan Avenue to Sunrise Boulevard
- Fair Oaks Boulevard - Sunset Avenue to Madison Avenue

**Operating Budget Impact:**

The operating cost impact of this project is unknown at this time.

**Asphalt Concrete Overlay Project - Phase I**

Project Costs	Prior Years	Fiscal Year 2007-08	Fiscal Year 2008-09	Fiscal Year 2009-10	Fiscal Year 2010-11	Fiscal Year 2011-12	Total
Construction Costs	0	3,502,000	0	0	0	0	3,502,000
Project Management/Design	150,000	0	0	0	0	0	150,000
Construction Inspection	0	250,000	0	0	0	0	250,000
<b>TOTAL</b>	<b>150,000</b>	<b>3,752,000</b>	<b>0</b>	<b>0</b>	<b>0</b>	<b>0</b>	<b>3,902,000</b>

Funding Sources	Prior Years	Fiscal Year 2007-08	Fiscal Year 2008-09	Fiscal Year 2009-10	Fiscal Year 2010-11	Fiscal Year 2011-12	Total
Road Fund	75,000	250,000	0	0	0	0	325,000
Federal (SAFETEA-LU)	75,000	3,502,000	0	0	0	0	3,577,000
<b>TOTAL</b>	<b>150,000</b>	<b>3,752,000</b>	<b>0</b>	<b>0</b>	<b>0</b>	<b>0</b>	<b>3,902,000</b>

**Asphalt Concrete Overlay Project - Phase II**

**Department:** Transportation

**Estimated Project Cost:** \$3,733,000

**Expected Completion Date:** 2009

**Funding Sources:** Road Fund  
Federal (SAFETEA-LU)

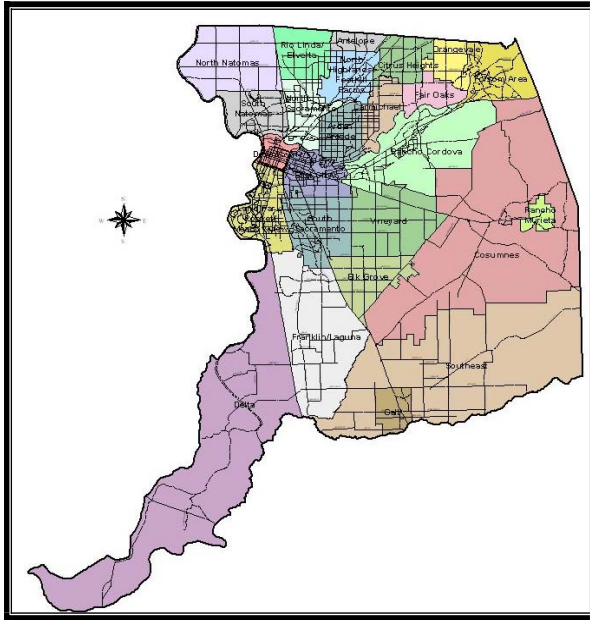

**Project Description:**

This project consists of placing a 2-inch thick rubberized asphalt concrete pavement overlay, repairing failed pavement (base repair), cold planing the pavement to accommodate the overlay, curb and gutter key cuts, adjusting manholes to grade, removing and replacing concrete curb, gutter, and sidewalk, installing sidewalk accessibility curb ramps, replacing inductive loop detectors, installing hand holes, modifying pedestrian pushbuttons, and re-striping. The project locations are not yet determined.

**Asphalt Concrete Overlay Project - Phase II**

Project Costs	Prior Years	Fiscal Year 2007-08	Fiscal Year 2008-09	Fiscal Year 2009-10	Fiscal Year 2010-11	Fiscal Year 2011-12	Total
Construction Costs	0	0	3,433,000	0	0	0	3,433,000
Project Management/ Design	0	150,000	0	0	0	0	150,000
Construction Inspection	0	0	150,000	0	0	0	150,000
<b>TOTAL</b>	<b>0</b>	<b>150,000</b>	<b>3,583,000</b>	<b>0</b>	<b>0</b>	<b>0</b>	<b>3,733,000</b>

Funding Sources	Prior Years	Fiscal Year 2007-08	Fiscal Year 2008-09	Fiscal Year 2009-10	Fiscal Year 2010-11	Fiscal Year 2011-12	Total
Road Fund	0	75,000	246,000	0	0	0	321,000
Federal (SAFETEA-LU)	0	75,000	3,337,000	0	0	0	3,412,000
<b>TOTAL</b>	<b>0</b>	<b>150,000</b>	<b>3,583,000</b>	<b>0</b>	<b>0</b>	<b>0</b>	<b>3,733,000</b>

**Asphalt Concrete Overlay Project - Transportation Bond, Phase I**

**Department:** Transportation

**Estimated Project Cost:** \$3,500,000

**Expected Completion Date:** 2009

**Funding Sources:** Transportation Bond

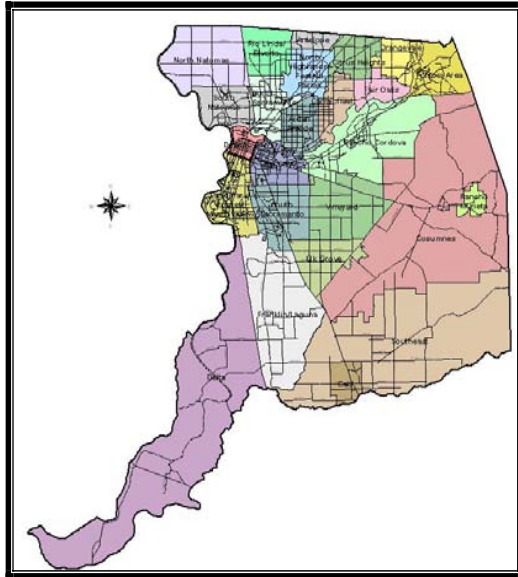

**Project Description:**

This project consists of placing a 2-inch thick rubberized asphalt concrete pavement overlay, repairing failed pavement (base repair), cold planing the pavement to accommodate the overlay, curb and gutter key cuts, adjusting manholes to grade, removing and replacing concrete curb, gutter, and sidewalk, installing sidewalk accessibility curb ramps, replacing inductive loop detectors, installing hand holes, modifying pedestrian pushbuttons, and re-striping.

**Project locations:**

- Q Street - 34<sup>th</sup> Street to Watt Avenue
- Tuolumne Drive - La Riviera Drive to La Riviera Drive
- La Riviera Drive - Salmon Falls Drive to Folsom Boulevard
- Main Avenue - Greenback Lane to Madison Avenue

**A.C. Overlay Project - Transportation Bond, Phase I**

<b>Project Costs</b>	<b>Prior Years</b>	<b>Fiscal Year 2007-08</b>	<b>Fiscal Year 2008-09</b>	<b>Fiscal Year 2009-10</b>	<b>Fiscal Year 2010-11</b>	<b>Fiscal Year 2011-12</b>	<b>Total</b>
Construction Costs	0	0	3,100,000	0	0	0	3,100,000
Project Management/Design	0	150,000	0	0	0	0	150,000
Construction Inspection	0	0	250,000	0	0	0	250,000
<b>TOTAL</b>	<b>0</b>	<b>150,000</b>	<b>3,350,000</b>	<b>0</b>	<b>0</b>	<b>0</b>	<b>3,500,000</b>

<b>Funding Sources</b>	<b>Prior Years</b>	<b>Fiscal Year 2007-08</b>	<b>Fiscal Year 2008-09</b>	<b>Fiscal Year 2009-10</b>	<b>Fiscal Year 2010-11</b>	<b>Fiscal Year 2011-12</b>	<b>Total</b>
Transportation Bond	0	150,000	3,350,000	0	0	0	3,500,000

**Auburn Boulevard Enhancements**

**Department:** Transportation

**Estimated Project Cost:** \$1,464,000

**Expected Completion Date:** 2012

**Funding Sources:** Other (SHRA)

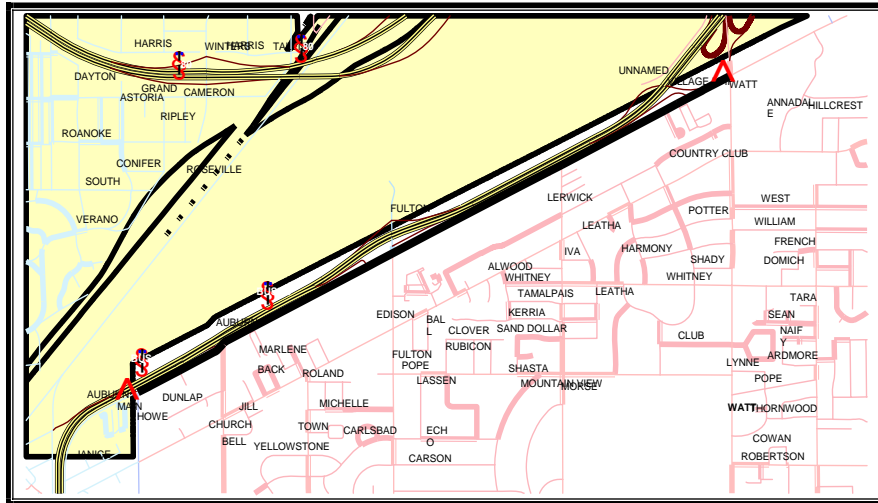

**Project Description:**

The Sacramento Housing and Redevelopment Agency (SHRA) and the County have initiated a study to develop a special planning area ordinance and streetscape master plan for the Auburn Boulevard corridor between Howe Avenue and Watt Avenue. The proposed master plan will include various transportation enhancements within the corridor including landscaping, streetscape, lighting enhancements, bicycle/pedestrian improvements, and other enhancements to support all modes of travel. The streetscape master plan is scheduled to be completed in 2007, and will set forth concepts for enhancement projects to be implemented by SHRA and the County. This project provides for the design and construction of a first phase project based on the streetscape master plan.

**Auburn Boulevard Enhancements**

Project Costs	Prior Years	Fiscal Year 2007-08	Fiscal Year 2008-09	Fiscal Year 2009-10	Fiscal Year 2010-11	Fiscal Year 2011-12	Total
Construction Costs	0	0	0	0	486,000	419,000	905,000
Project Management/ Design	0	0	292,000	150,000	0	0	442,000
Construction Inspection	0	0	0	0	63,000	54,000	117,000
<b>TOTAL</b>	<b>0</b>	<b>0</b>	<b>292,000</b>	<b>150,000</b>	<b>549,000</b>	<b>473,000</b>	<b>1,464,000</b>

Funding Sources	Prior Years	Fiscal Year 2007-08	Fiscal Year 2008-09	Fiscal Year 2009-10	Fiscal Year 2010-11	Fiscal Year 2011-12	Total
Other (SHRA)	0	0	292,000	150,000	549,000	473,000	1,464,000

**Bikeway Master Plan Construction, Phase II**

**Department:** Transportation

**Estimated Project Cost:** \$1,942,000

**Expected Completion Date:** 2010

**Funding Sources:** Measure A Sales Tax

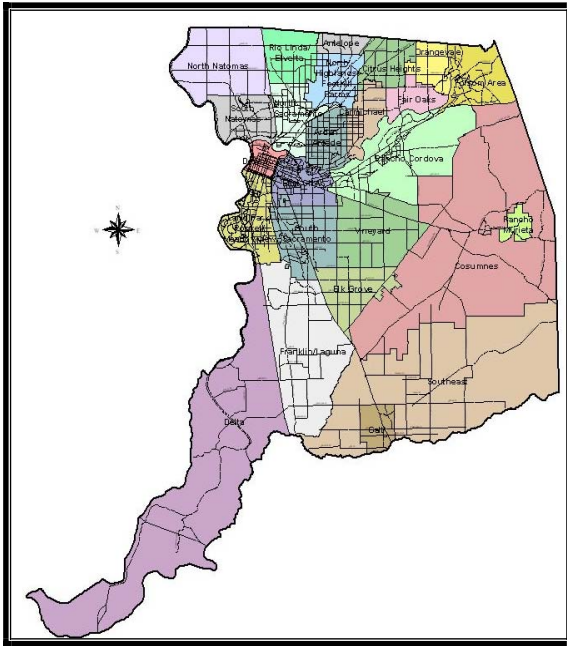

**Project Description:**

This project will construct on-street bikeways in various locations throughout Sacramento County as set forth in the 2010 Sacramento City/County Bikeway Master Plan. The project includes improvements to existing roadways to provide Class II bikeways (bike lanes). Improvements will include roadway widening to provide paved shoulder areas, the installation of bike lane signing, striping and markings, and improvements to intersections including traffic signal detection for bicycles. All improvements will be constructed in compliance with current Caltrans bikeway design standards.

**Bikeway Master Plan Construction, Phase II**

Project Costs	Prior Years	Fiscal Year 2007-08	Fiscal Year 2008-09	Fiscal Year 2009-10	Fiscal Year 2010-11	Fiscal Year 2011-12	Total
Construction Costs	0	0	1,025,000	280,000	0	0	1,305,000
Project Management/Design	296,000	0	127,000	0	0	0	423,000
Right-of-Way Purchase	0	0	121,000	0	0	0	121,000
Construction Inspection	0	0	60,000	33,000	0	0	93,000
<b>TOTAL</b>	<b>296,000</b>	<b>0</b>	<b>1,333,000</b>	<b>313,000</b>	<b>0</b>	<b>0</b>	<b>1,942,000</b>

Funding Sources	Prior Years	Fiscal Year 2007-08	Fiscal Year 2008-09	Fiscal Year 2009-10	Fiscal Year 2010-11	Fiscal Year 2011-12	Total
Measure A Sales Tax	296,000	0	1,333,000	313,000	0	0	1,942,000



**Bikeway Master Plan Implementation - Various Locations**

**Department:** Transportation

**Estimated Project Cost:** \$1,780,000

**Expected Completion Date:** Ongoing

**Funding Sources:** Measure A Sales Tax  
New Measure A Sales Tax

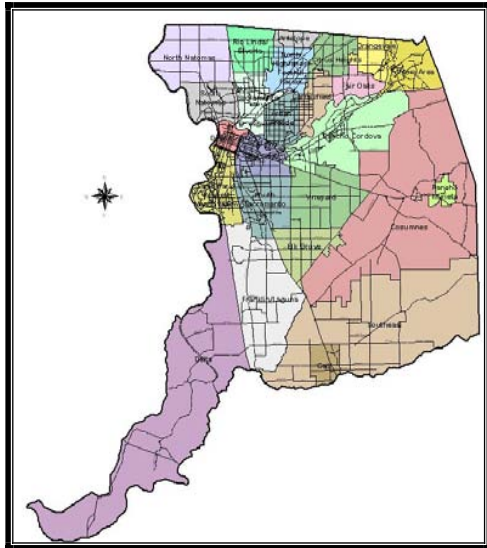

**Project Description:**

This is an ongoing program to install bike lane signing, striping and markings in various locations countywide. Bike lane improvements will be installed on approximately 400 miles of county roadways.

**Bikeway Master Plan Implementation - Various Locations**

<b>Project Costs</b>	<b>Prior Years</b>	<b>Fiscal Year 2007-08</b>	<b>Fiscal Year 2008-09</b>	<b>Fiscal Year 2009-10</b>	<b>Fiscal Year 2010-11</b>	<b>Fiscal Year 2011-12</b>	<b>Total</b>
Project Management/ Design	80,000	40,000	40,000	40,000	40,000	40,000	280,000
Construction							
Inspection	500,000	200,000	200,000	200,000	200,000	200,000	1,500,000
<b>TOTAL</b>	<b>580,000</b>	<b>240,000</b>	<b>240,000</b>	<b>240,000</b>	<b>240,000</b>	<b>240,000</b>	<b>1,780,000</b>

<b>Funding Sources</b>	<b>Prior Years</b>	<b>Fiscal Year 2007-08</b>	<b>Fiscal Year 2008-09</b>	<b>Fiscal Year 2009-10</b>	<b>Fiscal Year 2010-11</b>	<b>Fiscal Year 2011-12</b>	<b>Total</b>
Measure A Sales Tax	580,000	240,000	240,000	0	0	0	1,060,000
New Measure A Sales Tax	0	0	0	240,000	240,000	240,000	720,000
<b>TOTAL</b>	<b>580,000</b>	<b>240,000</b>	<b>240,000</b>	<b>240,000</b>	<b>240,000</b>	<b>240,000</b>	<b>1,780,000</b>





**Bradshaw Road - Calvin Road to Florin Road**

**Department:** Transportation

**Estimated Project Cost:** \$19,571,000

**Expected Completion Date:** 2010

**Funding Sources:** Developer Fees  
Measure A Sales Tax

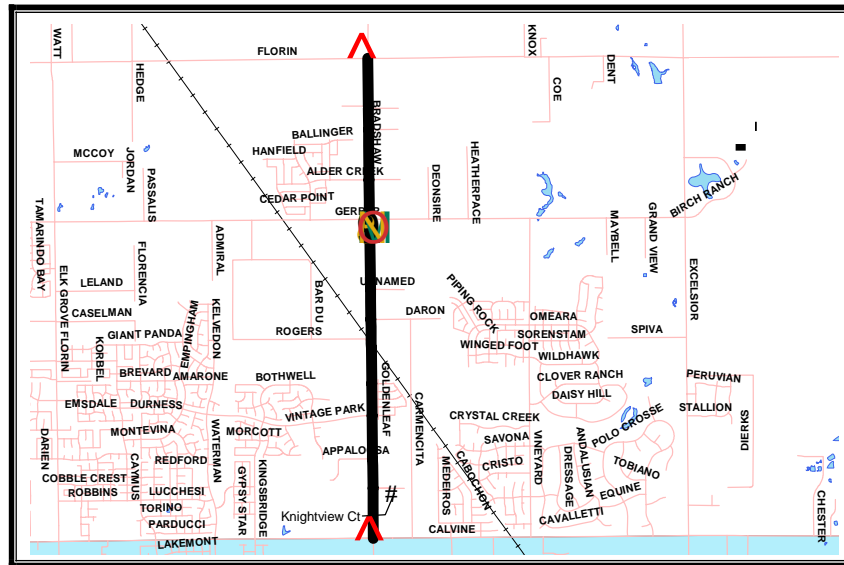

**Project Description:**

This project will widen Bradshaw Road from two lanes to four lanes between Calvin Road and Florin Road in the Vineyard area. The project proposes to construct two additional traffic lanes, a raised landscaped median, and paved shoulders to accommodate bicycle and pedestrian facilities. The project will also replace the bridges at Laguna Creek and at Gerber Creek. A separate cooperative project between the County and developer is proposed for the widening of the roadway and the modification of the traffic signal at the intersection of Bradshaw Road and Gerber Road. The projects are part of the Roadway Development Fee Capital Improvement Plan.

**Bradshaw Road - Calvin Road to Florin Road**

Project Costs	Prior Years	Fiscal Year 2007-08	Fiscal Year 2008-09	Fiscal Year 2009-10	Fiscal Year 2010-11	Fiscal Year 2011-12	Total
Construction Costs	124,000	800,000	8,300,000	3,137,000	0	0	12,361,000
Project Management/Design	1,696,000	14,000	0	0	0	0	1,710,000
Right-of-Way							
Purchase	497,000	3,408,000	0	0	0	0	3,905,000
Construction Inspection	0	260,000	803,000	532,000	0	0	1,595,000
<b>TOTAL</b>	<b>2,317,000</b>	<b>4,482,000</b>	<b>9,103,000</b>	<b>3,669,000</b>	<b>0</b>	<b>0</b>	<b>19,571,000</b>

Funding Sources	Prior Years	Fiscal Year 2007-08	Fiscal Year 2008-09	Fiscal Year 2009-10	Fiscal Year 2010-11	Fiscal Year 2011-12	Total
Developer Fees	1,000,000	2,151,000	4,369,000	2,446,000	0	0	9,966,000
Measure A Sales Tax	1,317,000	2,331,000	4,734,000	1,223,000	0	0	9,605,000
<b>TOTAL</b>	<b>2,317,000</b>	<b>4,482,000</b>	<b>9,103,000</b>	<b>3,669,000</b>	<b>0</b>	<b>0</b>	<b>19,571,000</b>

**Countywide Sidewalk Continuity Project, Phase II**

**Department:** Transportation

**Estimated Project Cost:** \$3,301,000

**Expected Completion Date:** 2010

**Funding Sources:** Measure A Sales Tax  
SHRA

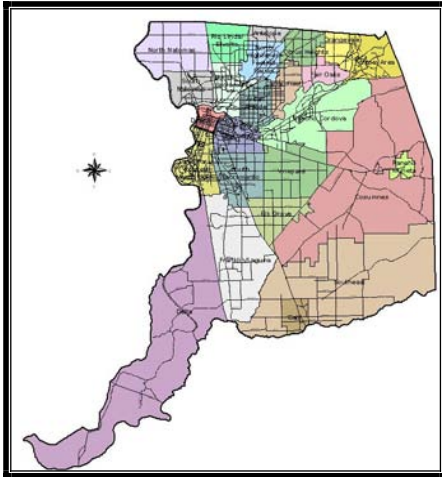

**Project Description:**

This project will construct sidewalks to fill in gaps at up to 11 locations in District 3 in accordance with the Sidewalk Construction Project Priority List. These include locations where pedestrian volumes and adjacent vehicle volumes are relatively high, and where it is unlikely that property development or redevelopment will occur in the near future. The locations are:

**Project Locations:**

- Annadale Lane - Auburn Boulevard to Edison Avenue
- Auburn Boulevard - west of Annadale Lane
- Edison Avenue - east of Watt Avenue
- Edison Avenue - west of Watt Avenue
- El Camino Avenue - Burgundy Way to Chicken Ranch Slough
- Fulton Avenue at Carson Way
- Northrop Avenue - Howe Avenue to Bell Avenue
- Watt Avenue - Greenview Lane to Robertson Avenue
- Watt Avenue - Kentfield Drive to Chenu Avenue
- Watt Avenue - west Way to north of Sierra View Lane
- Watt Avenue at Edison - north east corner

**Countywide Sidewalk Continuity Project, Phase II**

<b>Project Costs</b>	<b>Prior Years</b>	<b>Fiscal Year 2007-08</b>	<b>Fiscal Year 2008-09</b>	<b>Fiscal Year 2009-10</b>	<b>Fiscal Year 2010-11</b>	<b>Fiscal Year 2011-12</b>	<b>Total</b>
Construction Costs	0	0	1,141,000	623,000	0	0	1,764,000
Project Management/Design	719,000	217,000	0	0	0	0	936,000
Right-of-Way Purchase	62,000	92,000	0	0	0	0	154,000
Construction Inspection	0	0	320,000	127,000	0	0	447,000
<b>TOTAL</b>	<b>781,000</b>	<b>309,000</b>	<b>1,461,000</b>	<b>750,000</b>	<b>0</b>	<b>0</b>	<b>3,301,000</b>

<b>Funding Sources</b>	<b>Prior Years</b>	<b>Fiscal Year 2007-08</b>	<b>Fiscal Year 2008-09</b>	<b>Fiscal Year 2009-10</b>	<b>Fiscal Year 2010-11</b>	<b>Fiscal Year 2011-12</b>	<b>Total</b>
Measure A Sales Tax	781,000	309,000	661,000	750,000	0	0	2,501,000
SHRA	0	0	800,000	0	0	0	800,000
<b>TOTAL</b>	<b>781,000</b>	<b>309,000</b>	<b>1,461,000</b>	<b>750,000</b>	<b>0</b>	<b>0</b>	<b>3,301,000</b>

**Countywide Sidewalk Continuity Project, Phase III**

**Department:** Transportation

**Estimated Project Cost:** \$3,042,000

**Expected Completion Date:** 2011

**Funding Sources:** Measure A Sales Tax  
Other (None Identified)  
SHRA

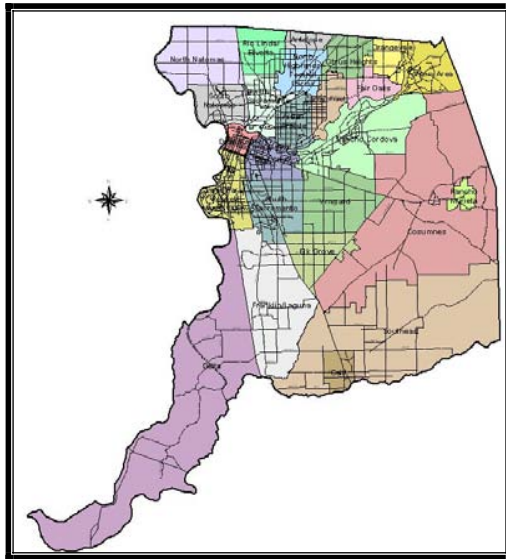

**Project Description:**

This project will construct sidewalks to fill in gaps at up to six locations in accordance with the Sidewalk Construction Project Priority List. These include locations where pedestrian volumes and adjacent vehicle volumes are relatively high, and where it is unlikely that property development or redevelopment will occur in the near future. The locations are:

**Project Locations:**

- Alta Arden Expressway at Morse Avenue
- East Parkway - south of Florin Road
- Fair Oaks Boulevard - east of Miles Lane
- Fair Oaks Boulevard at Orange Tree Court
- Gerber Road at Power Inn Road
- Sierra Boulevard - Fulton Avenue to Howe Avenue

**Countywide Sidewalk Continuity Project, Phase III**

Project Costs	Prior Years	Fiscal Year 2007-08	Fiscal Year 2008-09	Fiscal Year 2009-10	Fiscal Year 2010-11	Fiscal Year 2011-12	Total
Construction Costs	0	0	0	0	1,733,000	0	1,733,000
Project Management/							
Design	157,000	72,000	230,000	0	0	0	459,000
Right-of-Way							
Purchase	0	0	0	495,000	0	0	495,000
Construction							
Inspection	0	0	0	0	355,000	0	355,000
<b>TOTAL</b>	<b>157,000</b>	<b>72,000</b>	<b>230,000</b>	<b>495,000</b>	<b>2,088,000</b>	<b>0</b>	<b>3,042,000</b>

Funding Sources	Prior Years	Fiscal Year 2007-08	Fiscal Year 2008-09	Fiscal Year 2009-10	Fiscal Year 2010-11	Fiscal Year 2011-12	Total
Measure A Sales Tax	157,000	72,000	230,000	0	0	0	459,000
Other (None							
Identified)	0	0	0	495,000	2,088,000	0	2,583,000
<b>TOTAL</b>	<b>157,000</b>	<b>72,000</b>	<b>230,000</b>	<b>495,000</b>	<b>2,088,000</b>	<b>0</b>	<b>3,042,000</b>

**Countywide Street Beautification Project**

**Department:** Transportation

**Estimated Project Cost:** \$1,407,000

**Expected Completion Date:** Ongoing

**Funding Sources:** Measure A Sales Tax  
New Measure A Sales Tax

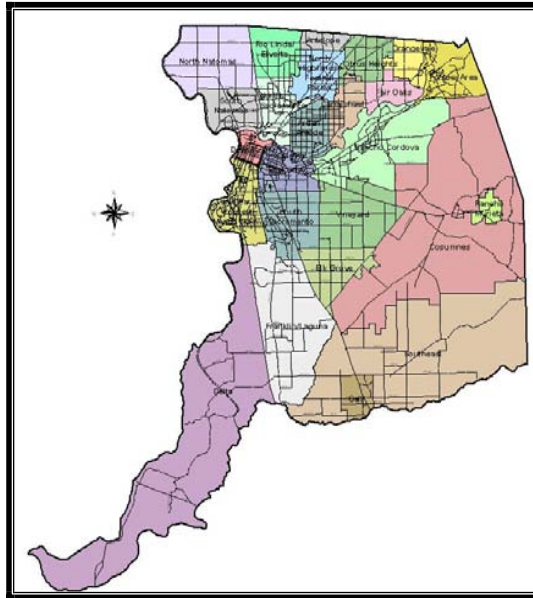

**Project Description:**

This project will construct landscaping and streetscaping improvements in various street corridors throughout Sacramento County in accordance with the countywide street beautification priority list. These projects propose to fully landscape medians and frontage road planters with trees, shrubs and groundcovers, and install hardscape improvements such as textured/colored interlocking pavers and/or concrete. The construction of all landscaping improvements will include installation of automatic irrigation systems where needed. The funding source for this project is Measure A Sales Tax.

**Countywide Street Beautification Project**

<b>Project Costs</b>	<b>Prior Years</b>	<b>Fiscal Year 2007-08</b>	<b>Fiscal Year 2008-09</b>	<b>Fiscal Year 2009-10</b>	<b>Fiscal Year 2010-11</b>	<b>Fiscal Year 2011-12</b>	<b>Total</b>
Construction Costs	0	0	345,000	0	483,000	0	828,000
Project Management/Design	0	103,000	0	144,000	0	200,000	447,000
Construction Inspection	0	0	59,000	0	73,000	0	132,000
<b>TOTAL</b>	<b>0</b>	<b>103,000</b>	<b>404,000</b>	<b>144,000</b>	<b>556,000</b>	<b>200,000</b>	<b>1,407,000</b>

<b>Funding Sources</b>	<b>Prior Years</b>	<b>Fiscal Year 2007-08</b>	<b>Fiscal Year 2008-09</b>	<b>Fiscal Year 2009-10</b>	<b>Fiscal Year 2010-11</b>	<b>Fiscal Year 2011-12</b>	<b>Total</b>
Measure A Sales Tax	0	103,000	404,000	0	0	0	507,000
New Measure A Sales Tax	0	0	0	144,000	556,000	200,000	900,000
<b>TOTAL</b>	<b>0</b>	<b>103,000</b>	<b>404,000</b>	<b>144,000</b>	<b>556,000</b>	<b>200,000</b>	<b>1,407,000</b>

**Elk Grove-Florin Road Bridge Replacement**

**Department:** Transportation

**Estimated Project Cost:** \$2,023,000

**Expected Completion Date:** 2009

**Funding Sources:** Financing District (VIN)  
Federal (HBP)

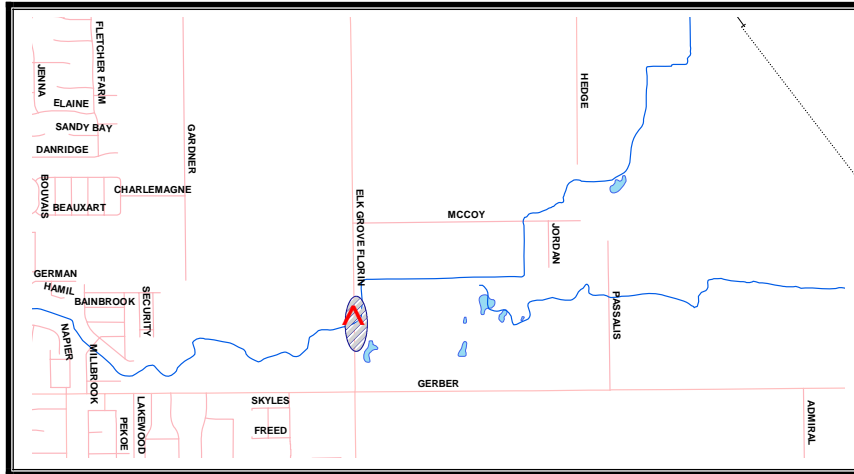

**Project Description:**

Concurrent with the design of the widening of the Elder Creek Bridge, the Sacramento County Department of Transportation will be preparing plans to improve Elk Grove-Florin Road from Gerber Road to Florin Road. The proposed project will widen the existing roadway and reconstruct the pavement section as necessary to accommodate a total of four traffic lanes, two (2) lanes in each direction, with a fully landscaped, raised center median. Six foot wide Class II bike lanes will be installed on Elk Grove-Florin Road as part of this project. New roadside ditches and driveway culverts will be constructed on both the east and west sides of Elk Grove-Florin Road. Rubberized Asphalt Concrete will be used on this project. Traffic signals will be modified at the intersections of Elk Grove-Florin Road with Gerber Road and Florin Road.

The bridge widening/replacement plans prepared by the consultant will be incorporated into the Elk Grove-Florin Road Improvement Project plans. The project is tentatively scheduled for construction during the summer season of 2008 with a tentative construction bid award date in February 2008.

**Elk Grove-Florin Road Bridge Replacement**

<b>Project Costs</b>	<b>Prior Years</b>	<b>Fiscal Year 2007-08</b>	<b>Fiscal Year 2008-09</b>	<b>Fiscal Year 2009-10</b>	<b>Fiscal Year 2010-11</b>	<b>Fiscal Year 2011-12</b>	<b>Total</b>
Construction Costs	0	0	900,000	360,000	0	0	1,260,000
Project Management/ Design	120,000	185,000	0	0	0	0	305,000
Right-of-Way Purchase	0	0	10,000	0	0	0	10,000
Construction Inspection	0	0	178,000	270,000	0	0	448,000
<b>TOTAL</b>	<b>120,000</b>	<b>185,000</b>	<b>1,088,000</b>	<b>630,000</b>	<b>0</b>	<b>0</b>	<b>2,023,000</b>

<b>Funding Sources</b>	<b>Prior Years</b>	<b>Fiscal Year 2007-08</b>	<b>Fiscal Year 2008-09</b>	<b>Fiscal Year 2009-10</b>	<b>Fiscal Year 2010-11</b>	<b>Fiscal Year 2011-12</b>	<b>Total</b>
Financing District (VIN)	25,000	10,000	117,000	74,000	0	0	226,000
Federal (HBP)	95,000	175,000	971,000	556,000	0	0	1,797,000
<b>TOTAL</b>	<b>120,000</b>	<b>185,000</b>	<b>1,088,000</b>	<b>630,000</b>	<b>0</b>	<b>0</b>	<b>2,023,000</b>

**Elk Grove-Florin Road - Gerber Road to Florin Road**

**Department:** Transportation

**Estimated Project Cost:** \$7,663,000

**Expected Completion Date:** 2010

**Funding Sources:** Financing District (VIN and NVS)  
Federal (HBP)

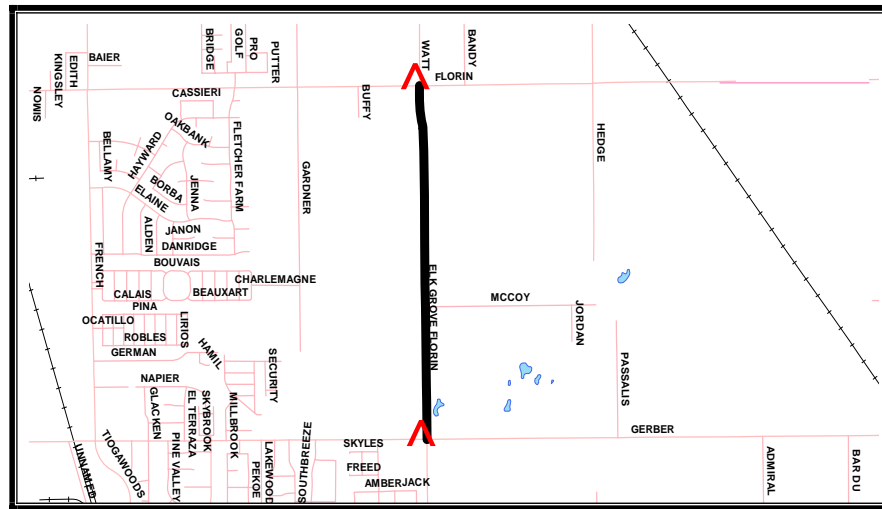

**Project Description:**

This project will widen Elk Grove-Florin Road from two to four lanes between Gerber Road and Florin Road. Widening of the Bridge over Elder Creek may become a separate project if federal funding is acquired through the Highway Bridge Rehabilitation and Replacement Program (HBRR). The project has been added to the Vineyard Public Facilities Financing Plan (VPFFP) for funding, and is also included in the proposed North Vineyard Station (NVS) capital improvement program for funding.

This project is Number 5 on the Department's 2007 Major Highway Improvements Project Priority List with a volume/capacity ratio of 1.57 and 24-hour traffic volume of 23,525 vehicles.

**Elk Grove-Florin Road - Gerber Road to Florin Road**

Project Costs	Prior Years	Fiscal Year 2007-08	Fiscal Year 2008-09	Fiscal Year 2009-10	Fiscal Year 2010-11	Fiscal Year 2011-12	Total
Construction Costs	0	154,000	2,058,000	3,332,000	0	0	5,544,000
Project Management/ Design	459,000	123,000	8,000	0	0	0	590,000
Right-of-Way Purchase	19,000	0	758,000	0	0	0	777,000
Construction Inspection	0	0	213,000	539,000	0	0	752,000
<b>TOTAL</b>	<b>478,000</b>	<b>277,000</b>	<b>3,037,000</b>	<b>3,871,000</b>	<b>0</b>	<b>0</b>	<b>7,663,000</b>

Funding Sources	Prior Years	Fiscal Year 2007-08	Fiscal Year 2008-09	Fiscal Year 2009-10	Fiscal Year 2010-11	Fiscal Year 2011-12	Total
Financing District (VIN and NVS)	208,000	268,000	2,281,000	3,115,000	0	0	5,872,000
Federal (HBP)	270,000	9,000	756,000	756,000	0	0	1,791,000
<b>TOTAL</b>	<b>478,000</b>	<b>277,000</b>	<b>3,037,000</b>	<b>3,871,000</b>	<b>0</b>	<b>0</b>	<b>7,663,000</b>

**Elkhorn Boulevard - Watt Avenue to Don Julio Boulevard**

Department: Transportation

Estimated Project Cost: \$9,589,000

Expected Completion Date: 2009

Funding Sources: Measure A Sales Tax  
Financing District (APFFP)  
Other (None Identified)

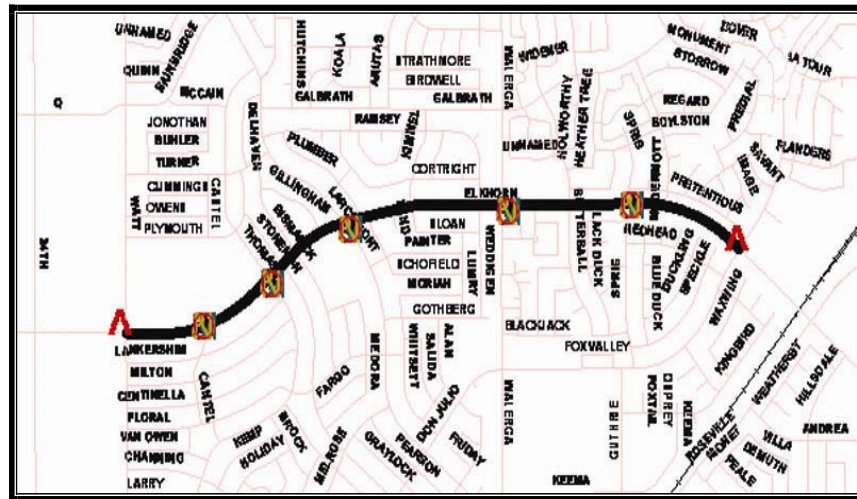

**Project Description:**

This project is to widen Elkhorn Boulevard from four lanes to six lanes including raised 12-foot median between Watt Avenue and Don Julio Boulevard in North Highlands-Foothill Farms. The project also proposes traffic signal modifications at the intersections of Elkhorn Boulevard with Watt Avenue, Cantel Way, Thomas Drive, Larchmont Drive, Walerga Road, and Sprig Drive.

This project is Number 12 on the Department’s 2007 Major Highway Improvements Project Priority List with a volume/capacity ratio of 0.61 and 24-hour traffic volume of 22,204 vehicles.

Elkhorn Boulevard - Watt Avenue to Don Julio Boulevard

Project Costs	Prior Years	Fiscal Year 2007-08	Fiscal Year 2008-09	Fiscal Year 2009-10	Fiscal Year 2010-11	Fiscal Year 2011-12	Total
Construction Costs	0	0	2,625,000	3,480,000	0	0	6,105,000
Project Management/Design	1,765,000	0	14,000	0	0	0	1,779,000
Right-of-Way Purchase	100,000	0	608,000	0	0	0	708,000
Construction Inspection	229,000	0	423,000	345,000	0	0	997,000
<b>TOTAL</b>	<b>2,094,000</b>	<b>0</b>	<b>3,670,000</b>	<b>3,825,000</b>	<b>0</b>	<b>0</b>	<b>9,589,000</b>

Funding Sources	Prior Years	Fiscal Year 2007-08	Fiscal Year 2008-09	Fiscal Year 2009-10	Fiscal Year 2010-11	Fiscal Year 2011-12	Total
Measure A Sales Tax	1,984,000	0	3,495,000	0	0	0	5,479,000
Financing District (APFFP)	110,000	0	0	0	0	0	110,000
Other (None Identified)	0	0	175,000	3,825,000	0	0	4,000,000
<b>TOTAL</b>	<b>2,094,000</b>	<b>0</b>	<b>3,670,000</b>	<b>3,825,000</b>	<b>0</b>	<b>0</b>	<b>9,589,000</b>



**Elverta Road - Dutch Haven Boulevard to Watt Avenue**

**Department:** Transportation

**Estimated Project Cost:** \$11,513,000

**Expected Completion Date:** 2008

**Funding Sources:** Measure A Sales Tax Financing District (APFFP)  
Other Federal (HBRRP)  
STIP (APDE)

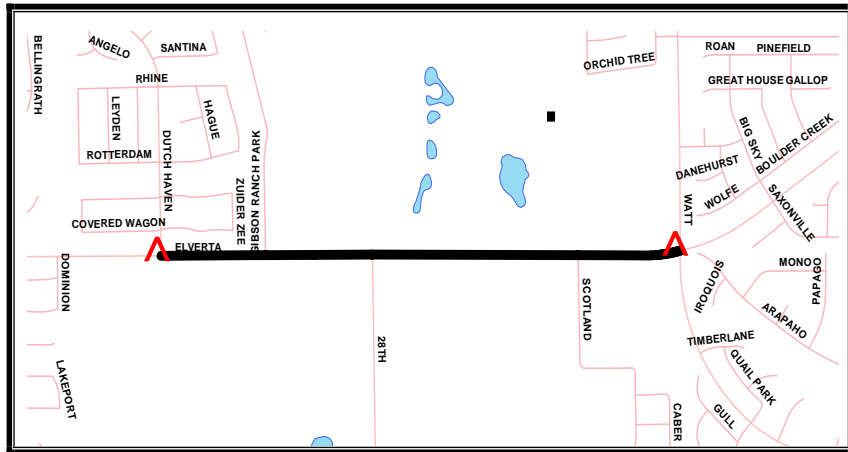

**Project Description:**

This project, which is part of the Antelope Public Facilities Financing Plan Capital Improvement Program, is to widen Elverta Road from two to four lanes between Dutch Haven Boulevard and Watt Avenue, including the bridge over Dry Creek. Proposed improvements include a raised landscaped median, improvements for Americans with Disabilities Act (ADA) compliance, transit access improvements, and bicycle and pedestrian facilities. This project also includes the removal of the existing two-lane Elverta Road bridge at Dry Creek and the construction of a new six-lane reinforced concrete bridge. The new bridge will accommodate bicycle and pedestrian facilities throughout its entire length.

Federal Regional Surface Transportation Program (RSTP) funds were approved in 2001 and State Transportation Improvement Program (STIP) funding was approved in 2002 to finance project development elements of the project including completion of environmental studies and permits and the preparation of plans and specifications. It is anticipated that future funding from federal sources will be needed to finance construction of this project.

Elverta Road - Dutch Haven Boulevard to Watt Avenue							
Project Costs	Prior Years	Fiscal Year 2007-08	Fiscal Year 2008-09	Fiscal Year 2009-10	Fiscal Year 2010-11	Fiscal Year 2011-12	Total
Construction Costs	0	2,367,000	6,083,000	0	0	0	8,450,000
Project Management/ Design	1,349,000	101,000	0	0	0	0	1,450,000
Right-of-Way Purchase	163,000	408,000	0	0	0	0	571,000
Construction Inspection	0	209,000	833,000	0	0	0	1,042,000
<b>TOTAL</b>	<b>1,512,000</b>	<b>3,085,000</b>	<b>6,916,000</b>	<b>0</b>	<b>0</b>	<b>0</b>	<b>11,513,000</b>

Funding Sources	Prior Years	Fiscal Year 2007-08	Fiscal Year 2008-09	Fiscal Year 2009-10	Fiscal Year 2010-11	Fiscal Year 2011-12	Total
Measure A Sales Tax Financing District (APFFP)	148,000	0	1,287,000	0	0	0	1,435,000
Other Federal (HBRRP)	732,000	885,000	3,334,000	0	0	0	4,951,000
STIP (APDE)	205,000	2,200,000	2,295,000	0	0	0	4,700,000
<b>TOTAL</b>	<b>1,512,000</b>	<b>3,085,000</b>	<b>6,916,000</b>	<b>0</b>	<b>0</b>	<b>0</b>	<b>11,513,000</b>



**Fair Oaks Boulevard - Marconi Avenue to Engle Road**

Department: Transportation

Estimated Project Cost: \$11,661,000

Expected Completion Date: 2011

Funding Sources: Developer Fees  
Other (Non Identified)  
Measure A Sales Tax

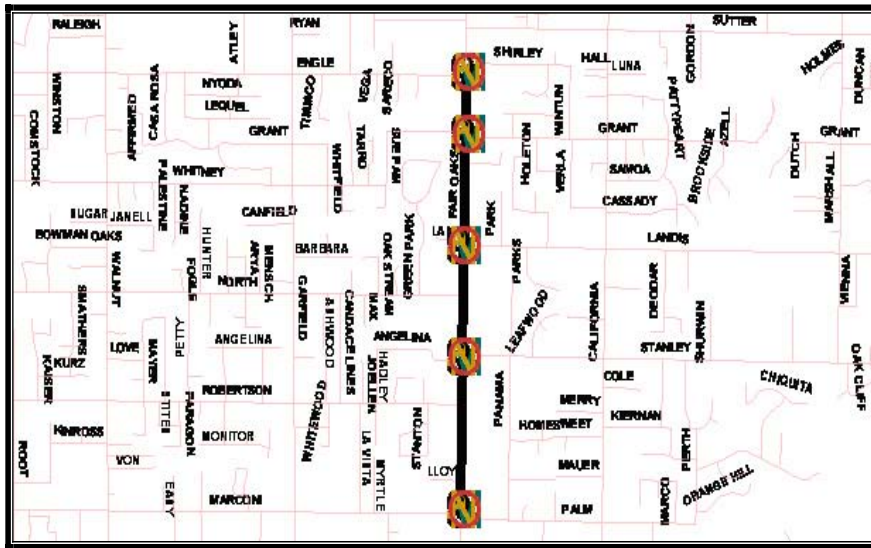

**Project Description:**

This project proposes to widen Fair Oaks Boulevard from four to six lanes including raised landscaped medians between Marconi Avenue and Engle Road in Carmichael. Proposed improvements include widening Fair Oaks Boulevard, installation of landscaping, improvements for Americans with Disabilities Act (ADA) compliance, transit access improvements, bicycle and pedestrian facilities, and signal modifications at Marconi Avenue, Stanley Avenue, Grant Avenue, and Engle Road.

This project is Number 4 on the Department’s 2007 Major Highway Improvements Project Priority List. Volume/Capacity ratio is 1.44 and 24-hour traffic volume is 43,159 vehicles.

**Fair Oaks Boulevard - Marconi Avenue to Engle Road**

Project Costs	Prior Years	Fiscal Year 2007-08	Fiscal Year 2008-09	Fiscal Year 2009-10	Fiscal Year 2010-11	Fiscal Year 2011-12	Total
Construction Costs	0	0	0	2,975,000	2,525,000	0	5,500,000
Project Management/ Design	958,000	73,000	133,000	8,000	0	0	1,172,000
Right-of-Way Purchase	0	0	2,048,000	2,374,000	0	0	4,422,000
Construction Inspection	0	0	0	224,000	343,000	0	567,000
<b>TOTAL</b>	<b>958,000</b>	<b>73,000</b>	<b>2,181,000</b>	<b>5,581,000</b>	<b>2,868,000</b>	<b>0</b>	<b>11,661,000</b>

Funding Sources	Prior Years	Fiscal Year 2007-08	Fiscal Year 2008-09	Fiscal Year 2009-10	Fiscal Year 2010-11	Fiscal Year 2011-12	Total
Developer Fees	833,000	73,000	567,000	1,451,000	1,390,000	0	4,314,000
Measure A Sales Tax	125,000	0	1,614,000	4,092,000	0	0	5,831,000
Other (None Identified)	0	0	0	38,000	1,478,000	0	1,516,000
<b>TOTAL</b>	<b>958,000</b>	<b>73,000</b>	<b>2,181,000</b>	<b>5,581,000</b>	<b>2,868,000</b>	<b>0</b>	<b>11,661,000</b>

**Florin Road Enhancements**

**Department:** Transportation

**Estimated Project Cost:** \$3,368,000

**Expected Completion Date:** 2007

**Funding Sources:** Measure A Sales Tax  
STIP (STEA), SHRA  
TEA-21

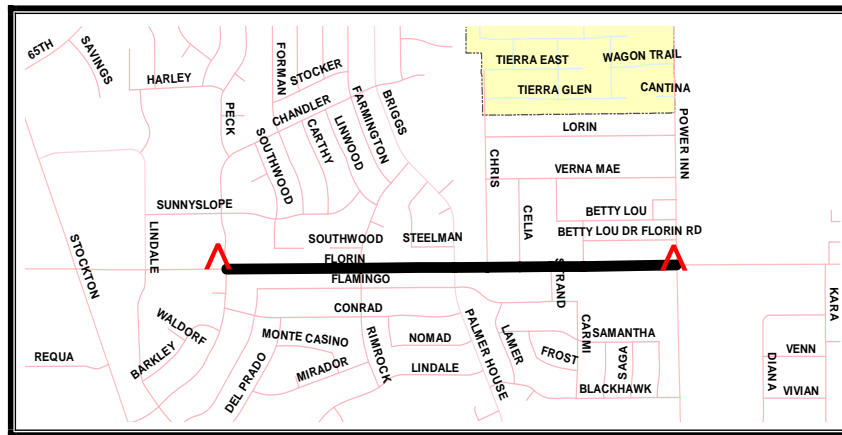

**Project Description:**

The County of Sacramento and Sacramento Housing and Redevelopment Agency (SHRA) are currently developing a master plan to enhance the Florin Road corridor between Stockton Boulevard to Elk Grove-Florin Road. Enhancements will include the construction of sidewalks, bikeways, medians, street lighting, and landscape and streetscape improvements, and gateway monuments at the southeast corner of Florin Road and Power Inn Road and at the northwest corner of Florin Road and Florin Perkins Road. This project will implement an initial phase of improvements recommended in the corridor enhancement master plan.

State Transportation Improvement Program (STIP) funding was allocated in June 2006 to assist in financing the construction phase of the project.

**Operating Budget Impact:**

The operating cost impact of this project is unknown at this time.

**Florin Road Enhancements**

Project Costs	Prior Years	Fiscal Year 2007-08	Fiscal Year 2008-09	Fiscal Year 2009-10	Fiscal Year 2010-11	Fiscal Year 2011-12	Total
Construction Costs	705,000	1,605,000	0	0	0	0	2,310,000
Project Management/Design	460,000	0	0	0	0	0	460,000
Right-of-Way Purchase	224,000	0	0	0	0	0	224,000
Construction Inspection	4,000	370,000	0	0	0	0	374,000
<b>TOTAL</b>	<b>1,393,000</b>	<b>1,975,000</b>	<b>0</b>	<b>0</b>	<b>0</b>	<b>0</b>	<b>3,368,000</b>

Funding Sources	Prior Years	Fiscal Year 2007-08	Fiscal Year 2008-09	Fiscal Year 2009-10	Fiscal Year 2010-11	Fiscal Year 2011-12	Total
Measure A Sales Tax	268,000	375,000	0	0	0	0	643,000
STIP (STEA)	700,000	1,600,000	0	0	0	0	2,300,000
TEA-21	400,000	0	0	0	0	0	400,000
SHRA	25,000	0	0	0	0	0	25,000
<b>TOTAL</b>	<b>1,393,000</b>	<b>1,975,000</b>	<b>0</b>	<b>0</b>	<b>0</b>	<b>0</b>	<b>3,368,000</b>

**Franklin Boulevard Streetscape**

**Department:** Transportation

**Estimated Project Cost:** \$6,030,000

**Expected Completion Date:** 2007

**Funding Sources:** Road Fund  
TEA-21(RSTP; TEA)  
SHRA

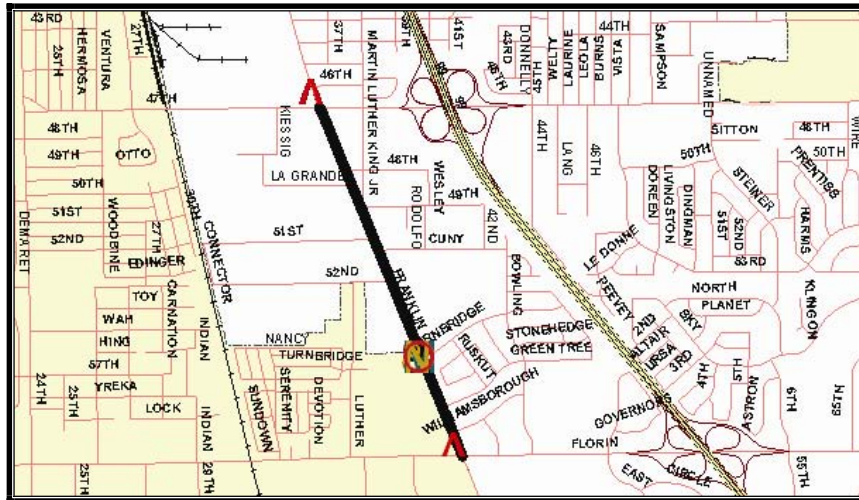

**Project Description:**

This project proposes streetscape, landscape and gateway enhancements along the Franklin Boulevard corridor between 47<sup>th</sup> Avenue and Florin Road. These improvements are recommended by, and the project is being developed in cooperation with the Sacramento Housing and Redevelopment Agency's (SHRA) Franklin Boulevard Urban Design/Streetscape Master Plan.

Federal funding from the Regional Surface Transportation Program (RSTP) has been approved for the development of the proposed project, design and construction of the proposed improvements.

**Operating Budget Impact:**

The operating cost impact of this project is unknown at this time.

**Franklin Boulevard Streetscape**

Project Costs	Prior Years	Fiscal Year 2007-08	Fiscal Year 2008-09	Fiscal Year 2009-10	Fiscal Year 2010-11	Fiscal Year 2011-12	Total
Construction Costs	332,000	3,208,000	0	0	0	0	3,540,000
Project Management/Design	1,322,000	0	0	0	0	0	1,322,000
Right-of-Way Purchase	531,000	0	0	0	0	0	531,000
Construction Inspection	60,000	577,000	0	0	0	0	637,000
<b>TOTAL</b>	<b>2,245,000</b>	<b>3,785,000</b>	<b>0</b>	<b>0</b>	<b>0</b>	<b>0</b>	<b>6,030,000</b>

Funding Sources	Prior Years	Fiscal Year 2007-08	Fiscal Year 2008-09	Fiscal Year 2009-10	Fiscal Year 2010-11	Fiscal Year 2011-12	Total
Road Fund	365,000	0	0	0	0	0	365,000
TEA-21 (RSTP; TEA)	821,000	1,517,000	0	0	0	0	2,338,000
SHRA	1,059,000	2,268,000	0	0	0	0	3,327,000
<b>TOTAL</b>	<b>2,245,000</b>	<b>3,785,000</b>	<b>0</b>	<b>0</b>	<b>0</b>	<b>0</b>	<b>6,030,000</b>

**Freedom Park Drive / Watt Avenue Enhancements**

Department: Transportation

Estimated Project Cost: \$4,600,000

Expected Completion Date: 2010

Funding Sources: STIP (STEA)  
SHRA  
Federal (RSTP)

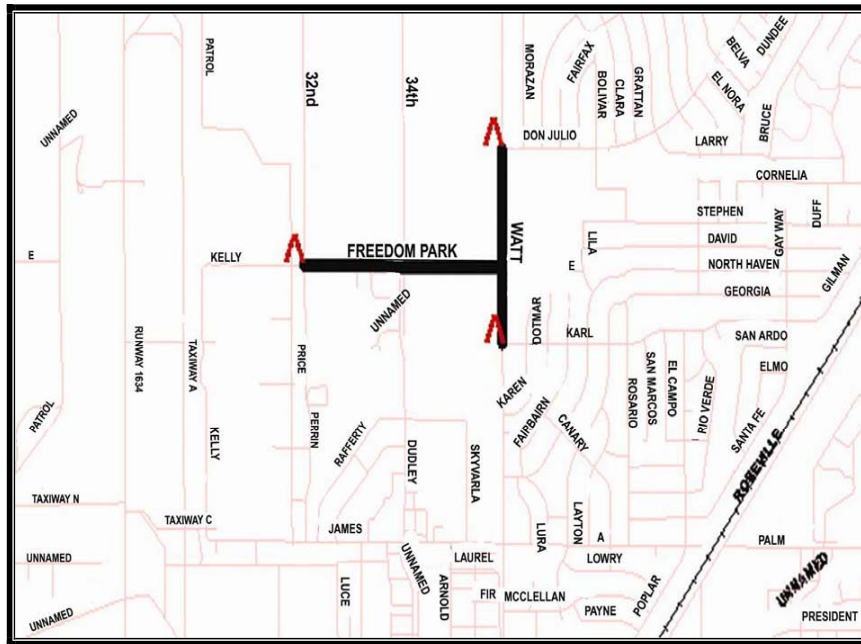

**Project Description:**

This project proposes the installation of sidewalks and bike lanes along Freedom Park Drive. Streetscape improvements such as decorative street lamps, landscaping, and a small public pedestrian plaza on Watt Avenue between Karl Drive and Don Julio Boulevard, and Freedom Park Drive between Watt Avenue and 32<sup>nd</sup> Street that would include wide sidewalks, a decorative bus facility to improve transit use for community's existing and proposed development, kiosk, benches, and an artistic monument for community identity in the Freedom Park Drive corridor.

Freedom Park Drive / Watt Avenue Enhancements

Project Costs	Prior Years	Fiscal Year 2007-08	Fiscal Year 2008-09	Fiscal Year 2009-10	Fiscal Year 2010-11	Fiscal Year 2011-12	Total
Construction Costs	0	0	805,000	2,414,000	0	0	3,219,000
Project Management/ Design	81,000	600,000	0	0	0	0	681,000
Right-of-Way Purchase	0	250,000	0	0	0	0	250,000
Construction Inspection	0	0	112,000	338,000	0	0	450,000
<b>TOTAL</b>	<b>81,000</b>	<b>850,000</b>	<b>917,000</b>	<b>2,752,000</b>	<b>0</b>	<b>0</b>	<b>4,600,000</b>

Funding Sources	Prior Years	Fiscal Year 2007-08	Fiscal Year 2008-09	Fiscal Year 2009-10	Fiscal Year 2010-11	Fiscal Year 2011-12	Total
STIP (STEA)	81,000	19,000	917,000	1,683,000	0	0	2,700,000
SHRA	0	431,000	0	1,069,000	0	0	1,500,000
Federal (RSTP)	0	400,000	0	0	0	0	400,000
<b>TOTAL</b>	<b>81,000</b>	<b>850,000</b>	<b>917,000</b>	<b>2,752,000</b>	<b>0</b>	<b>0</b>	<b>4,600,000</b>

**Freeport Regional Water Authority Median Landscaping Improvements**

Department: Transportation

Estimated Project Cost: \$3,331,000

Expected Completion Date: 2009

Funding Sources: Freeport Water Authority,  
Department of Water Resources

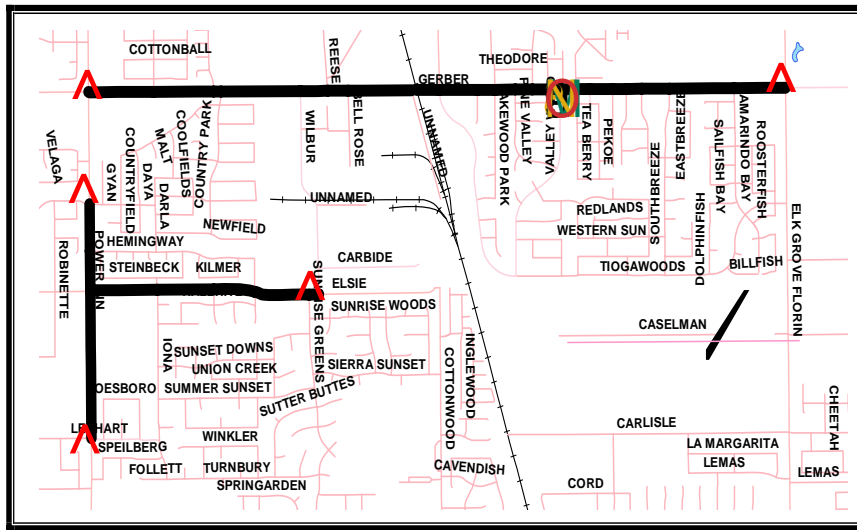

**Project Description:**

The project proposes to add raised landscaped medians along Power Inn Road between Lenhart Road and Skywoods Way - Haystack Drive, along Elsie Avenue between Power Inn Road and Wilbur Way along Gerber Road between Power Inn Road and Elk Grove-Florin Road and a new traffic signal at Gerber Road/Valley Wood Drive as part of the Freeport Regional Water Authority (FRWA) water transmission pipeline project that will carry water diverted from the Sacramento River at the new FRWA intake near Freeport Boulevard to the Sacramento County Water Agency (SCWA) Zone 40 Surface Water Treatment Plant (SWTP) and to the Folsom South Canal (FSC).

**Freeport Regional Water Authority Median Landscaping Improvements**

Project Costs	Prior Years	Fiscal Year 2007-08	Fiscal Year 2008-09	Fiscal Year 2009-10	Fiscal Year 2010-11	Fiscal Year 2011-12	Total
Construction Costs	0	1,000,000	1,500,000	0	0	0	2,500,000
Project Management/Design	425,000	0	0	0	0	0	425,000
Right-of-Way Purchase	31,000	0	0	0	0	0	31,000
Construction Inspection	0	150,000	225,000	0	0	0	375,000
<b>TOTAL</b>	<b>456,000</b>	<b>1,150,000</b>	<b>1,725,000</b>	<b>0</b>	<b>0</b>	<b>0</b>	<b>3,331,000</b>

Funding Sources	Prior Years	Fiscal Year 2007-08	Fiscal Year 2008-09	Fiscal Year 2009-10	Fiscal Year 2010-11	Fiscal Year 2011-12	Total
Department of Water Resources	3000	18000	28,000	0	0	0	49,000
Freeport Water Authority	453,000	1,132,000	1,697,000	0	0	0	3,282,000
<b>TOTAL</b>	<b>456,000</b>	<b>1,150,000</b>	<b>1,725,000</b>	<b>0</b>	<b>0</b>	<b>0</b>	<b>3,331,000</b>



**Fruitridge Road and South Watt Avenue Intersection**

Department: Transportation

Estimated Project Cost: \$1,520,000

Expected Completion Date: 2009

Funding Sources: Other (City of Sacramento)  
Other (None Identified)

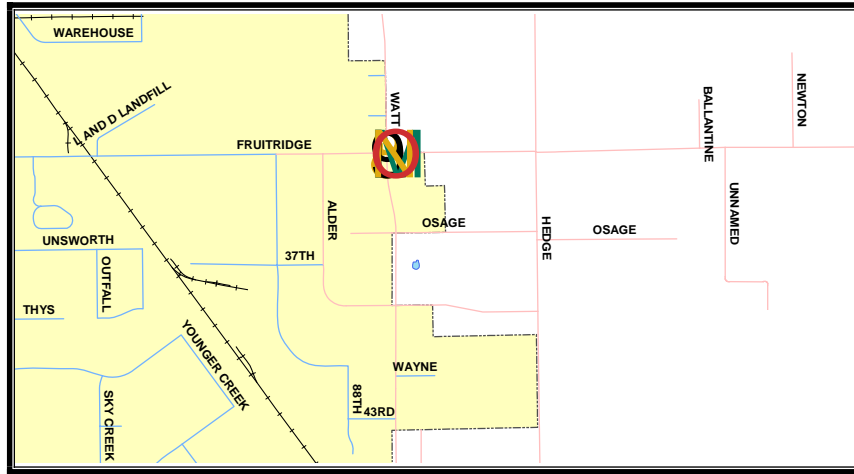

**Project Description:**

This project will install a traffic signal at the intersection of Fruitridge Road and South Watt Avenue. The design will consist of minor road widening with re-striping to accommodate turn lanes and multipurpose lanes.

The County of Sacramento entered into a cooperative agreement with the City of Sacramento regarding the intersection of Fruitridge Road at South Watt Avenue. The City of Sacramento will be preparing plans, specifications and estimates, and will secure all necessary environmental and right-of-way clearances for the project. The City of Sacramento will also advertise, award and administer the construction contract. The County Department of Transportation will provide engineering and construction oversight and support.

Fruitridge Road and South Watt Avenue Intersection							
Project Costs	Prior Years	Fiscal Year 2007-08	Fiscal Year 2008-09	Fiscal Year 2009-10	Fiscal Year 2010-11	Fiscal Year 2011-12	Total
Construction Costs	0	0	855,000	0	0	0	855,000
Project Management/Design	83,000	307,000	0	0	0	0	390,000
Right-of-Way Purchase	0	20,000	0	0	0	0	20,000
Construction Inspection	0	0	255,000	0	0	0	255,000
<b>TOTAL</b>	<b>83,000</b>	<b>327,000</b>	<b>1,110,000</b>	<b>0</b>	<b>0</b>	<b>0</b>	<b>1,520,000</b>

Funding Sources	Prior Years	Fiscal Year 2007-08	Fiscal Year 2008-09	Fiscal Year 2009-10	Fiscal Year 2010-11	Fiscal Year 2011-12	Total
Other ( City of Sacramento)	83,000	327,000	40,000	0	0	0	450,000
Other (None Identified)	0	0	1,070,000	0	0	0	1,070,000
<b>TOTAL</b>	<b>83,000</b>	<b>327,000</b>	<b>1,110,000</b>	<b>0</b>	<b>0</b>	<b>0</b>	<b>1,520,000</b>



**Gerber Road - Elk Grove-Florin Road to Gerber Creek Crossing #3**

Department: Transportation

Estimated Project Cost: \$11,643,000

Expected Completion Date: 2009

Funding Sources: Financing District (NVS)  
Other (FRWA)

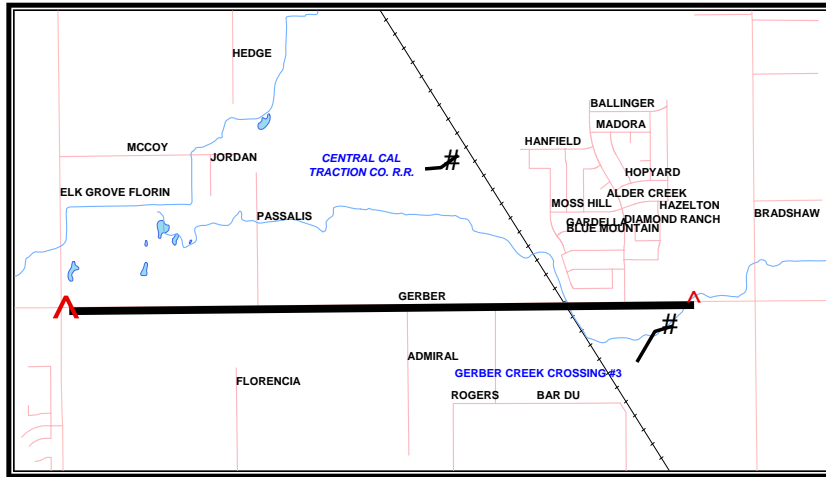

**Project Description:**

This project will widen Gerber Road from two lanes to three lanes between Elk Grove – Florin Road and Gerber Creek Crossing #3 in the Vineyard area. The project proposes to reconstruct two traffic lanes, add a new west bound lane, a new raised landscaped median, and new paved shoulders to accommodate bicycle and pedestrian facilities. The project will also include a box bridge/culvert improvement at Gerber Creek Crossing #4. This project is part of the North Vineyard Station Specific Public Facilities Financing Plan Impact Fee Program.

Gerber Road - Elk Grove-Florin Road to Gerber Creek Crossing #3

Project Costs	Prior Years	Fiscal Year 2007-08	Fiscal Year 2008-09	Fiscal Year 2009-10	Fiscal Year 2010-11	Fiscal Year 2011-12	Total
Construction Costs	0	1,856,000	3,691,000	2,596,000	0	0	8,143,000
Project Management/ Design	1,000,000	1,000,000	0	0	0	0	2,000,000
Construction Inspection	0	342,000	680,000	478,000	0	0	1,500,000
<b>TOTAL</b>	<b>1,000,000</b>	<b>3,198,000</b>	<b>4,371,000</b>	<b>3,074,000</b>	<b>0</b>	<b>0</b>	<b>11,643,000</b>

Funding Sources	Prior Years	Fiscal Year 2007-08	Fiscal Year 2008-09	Fiscal Year 2009-10	Fiscal Year 2010-11	Fiscal Year 2011-12	Total
Financing District (NVS)	250,000	3,198,000	4,371,000	3,074,000	0	0	10,893,000
Other (FRWA)	750,000	0	0	0	0	0	750,000
<b>TOTAL</b>	<b>1,000,000</b>	<b>3,198,000</b>	<b>4,371,000</b>	<b>3,074,000</b>	<b>0</b>	<b>0</b>	<b>11,643,000</b>

**Greenback Lane - Fair Oaks Boulevard to Hazel Avenue**

Department: Transportation

Estimated Project Cost: \$25,159,000

Expected Completion Date: 2012

Funding Sources: Developer Fees  
Other (None Identified)  
New Measure A Sales Tax

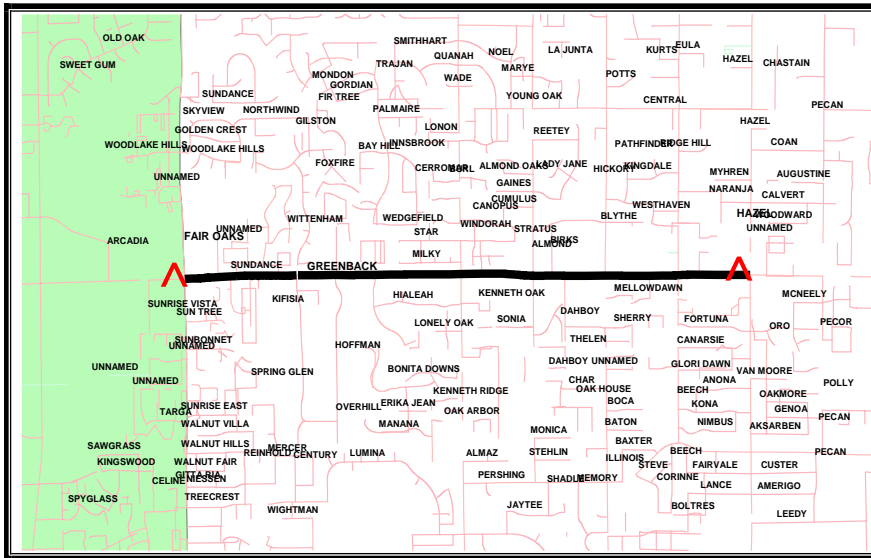

**Project Description:**

This study investigates alternatives and prepares estimates to widen Greenback Lane from four to six lanes between Fair Oaks Boulevard and Hazel Avenue in the City of Citrus Heights and the Orangevale area. Project implementation requires a cooperative agreement with the City of Citrus Heights.

This project is Number 5 on the Department's 2007 Major Highway Improvement Project Priority List. Volume/Capacity ratio is 1.33 and 24-hour traffic volume is 39,807 vehicles.

Greenback Lane - Fair Oaks Boulevard to Hazel Avenue

Project Costs	Prior Years	Fiscal Year 2007-08	Fiscal Year 2008-09	Fiscal Year 2009-10	Fiscal Year 2010-11	Fiscal Year 2011-12	Total
Construction Costs	0	0	0	0	3,009,000	9,452,000	12,461,000
Project Management/ Design	346,000	150,000	976,000	438,000	4,000	0	1,914,000
Right-of-Way Purchase	0	0	24,000	2,761,000	6,352,000	0	9,137,000
Construction Inspection	0	0	0	0	308,000	1,339,000	1,647,000
<b>TOTAL</b>	<b>346,000</b>	<b>150,000</b>	<b>1,000,000</b>	<b>3,199,000</b>	<b>9,673,000</b>	<b>10,791,000</b>	<b>25,159,000</b>

Funding Sources	Prior Years	Fiscal Year 2007-08	Fiscal Year 2008-09	Fiscal Year 2009-10	Fiscal Year 2010-11	Fiscal Year 2011-12	Total
Developer Fees	346,000	150,000	0	592,000	3,829,000	3,073,000	7,990,000
Other (None Identified)	0	0	0	592,000	3,829,000	3,074,000	7,495,000
New Measure A Sales Tax	0	0	1,000,000	2,015,000	2,015,000	4,644,000	9,674,000
<b>TOTAL</b>	<b>346,000</b>	<b>150,000</b>	<b>1,000,000</b>	<b>3,199,000</b>	<b>9,673,000</b>	<b>10,791,000</b>	<b>25,159,000</b>

**Hazel Avenue - Curragh Downs Drive to Madison Avenue, Phase II**

Department: Transportation

Estimated Project Cost: \$31,478,000\*

Expected Completion Date: 2012

Funding Sources: Developer Fees  
New Measure A Sales Tax  
Other Federal Funds  
STIP

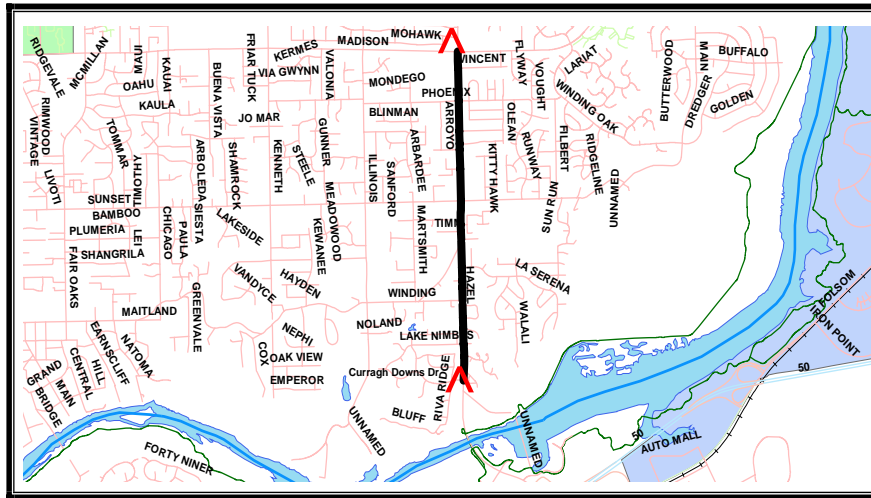

**Project Description:**

This second phase project will widen Hazel Avenue from four to six lanes from Curragh Downs Drive to Madison Avenue. This phase will also accomplish the appraisals and acquisitions of properties adjacent to the proposed improvements along with a concerted relocation effort for disposed property owners. Traffic signal modifications are proposed at Curragh Downs Drive, Winding Way, La Serena Drive, the fire station at Roediger Lane and a new signal at Phoenix Avenue. This project will improve existing and projected traffic congestion; enhance pedestrian and bicycle mobility in the corridor, address safety concerns; and generally improve the aesthetics of the corridor.

\*The total estimated project schedule exceeds the 5 year plan, therefore the project budget is greater than the five year plan shown on the following page.

Hazel Avenue - Curragh Downs Drive to Madison Avenue, Phase II

Project Costs	Prior Years	Fiscal Year 2007-08	Fiscal Year 2008-09	Fiscal Year 2009-10	Fiscal Year 2010-11	Fiscal Year 2011-12	Total
Construction Costs	0	0	0	0	3,923,000	16,518,000	20,441,000
Project Management/ Design	0	0	563,000	2,092,000	465,000	0	3,120,000
Right-of-Way Purchase	0	0	1,000	1,464,000	2,424,000	8,000	3,897,000
Construction Inspection	0	0	0	0	532,000	1,610,000	2,142,000
<b>TOTAL</b>	<b>0</b>	<b>0</b>	<b>564,000</b>	<b>3,556,000</b>	<b>7,344,000</b>	<b>18,136,000</b>	<b>29,600,000</b>

Funding Sources	Prior Years	Fiscal Year 2007-08	Fiscal Year 2008-09	Fiscal Year 2009-10	Fiscal Year 2010-11	Fiscal Year 2011-12	Total
Developer Fees	0	0	564,000	1,185,000	2,448,000	2,091,000	6,288,000
New Measure A Sales Tax	0	0	0	1,185,000	2,448,000	6,045,000	9,678,000
Other Federal Funds	0	0	0	1,186,000	2,448,000	5,000,000	8,634,000
STIP	0	0	0	0	0	5,000,000	5,000,000
<b>TOTAL</b>	<b>0</b>	<b>0</b>	<b>564,000</b>	<b>3,556,000</b>	<b>7,344,000</b>	<b>18,136,000</b>	<b>29,600,000</b>

**Hazel Avenue - U.S. Highway 50 to Curragh Downs Drive, Phase I**

**Department:** Transportation

**Estimated Project Cost:** \$28,676,000

**Expected Completion Date:** 2009

**Funding Sources:** Developer Fees  
TEA-21(RSTP)  
New Measure A Sales Tax  
Measure A Sales Tax  
STIP (APDE)  
Other (T-3 RSTP)

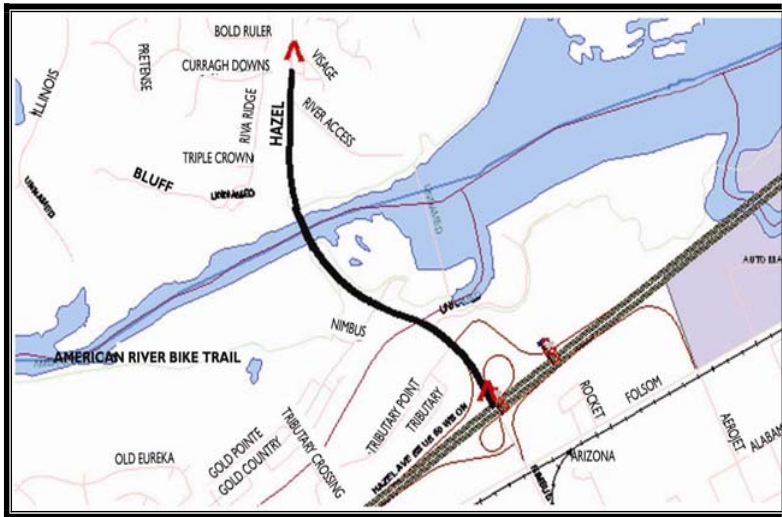

**Project Description:**

This project will widen Hazel Avenue from four to six lanes over the American River Bridge from US Highway 50 Interchange to Curragh Downs Drive. The project includes the construction of new bicycle and pedestrian facilities including bike lanes, and a barrier separating bicycle/pedestrian/equestrian modes from vehicle traffic on the bridge over the American River. The project also includes traffic signal modifications at Curragh Downs Drive.

Hazel Avenue - U.S. Highway 50 to Curragh Downs Drive, Phase I

Project Costs	Prior Years	Fiscal Year 2007-08	Fiscal Year 2008-09	Fiscal Year 2009-10	Fiscal Year 2010-11	Fiscal Year 2011-12	Total
Construction Costs	0	3,912,000	13,870,000	0	0	0	17,782,000
Project Management/Design	7,601,000	1,500,000	0	0	0	0	9,101,000
Right-of-Way Purchase	119,000	141,000	0	0	0	0	260,000
Construction Inspection	0	551,000	982,000	0	0	0	1,533,000
<b>TOTAL</b>	<b>7,720,000</b>	<b>6,104,000</b>	<b>14,852,000</b>	<b>0</b>	<b>0</b>	<b>0</b>	<b>28,676,000</b>

Funding Sources	Prior Years	Fiscal Year 2007-08	Fiscal Year 2008-09	Fiscal Year 2009-10	Fiscal Year 2010-11	Fiscal Year 2011-12	Total
Developer Fees	3,289,000	525,000	0	0	0	0	3,814,000
New Measure A Sales Tax	0	4,579,000	4,852,000	0	0	0	9,431,000
Measure A Sales Tax	901,000	1,000,000	0	0	0	0	1,901,000
TEA-21 (RSTP)	1,530,000	0	0	0	0	0	1,530,000
Other (T-3 RSTP)	0	0	10,000,000	0	0	0	10,000,000
STIP (APDE)	2,000,000	0	0	0	0	0	2,000,000
<b>TOTAL</b>	<b>7,720,000</b>	<b>6,104,000</b>	<b>14,852,000</b>	<b>0</b>	<b>0</b>	<b>0</b>	<b>28,676,000</b>

**Hazel Avenue Intelligent Transportation System (ITS) Project**

**Department:** Transportation

**Estimated Project Cost:** \$805,000

**Expected Completion Date:** 2012

**Funding Sources:** Measure A Sales Tax  
TEA-21 (ITS)

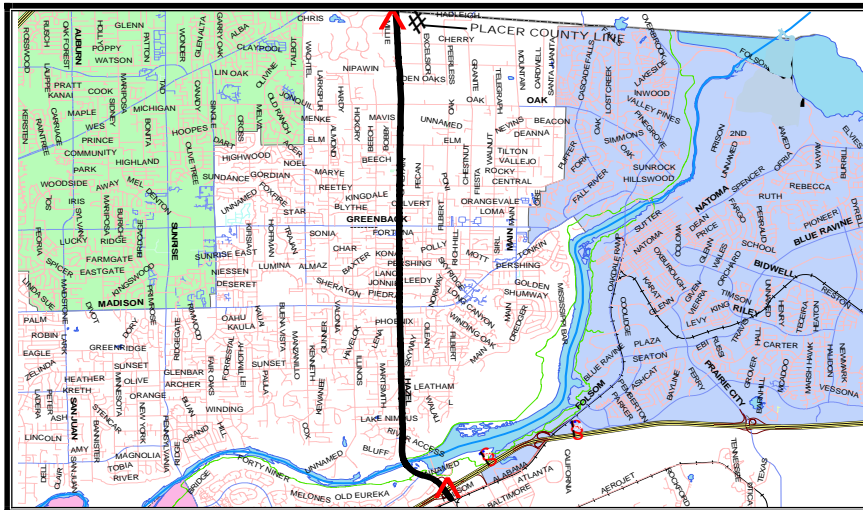

**Project Description:**

This project will provide an expansion of the county’s existing Intelligent Transportation System (ITS) program while adding a key component to the regions ITS development. It will install fiber optic and wireless communications, traffic surveillance cameras, changeable message signs, traffic data collection stations and an advanced traffic signal system along the entire corridor. Monitoring and control of traffic will be available through the existing Traffic Operations Center (TOC) using real-time data to effectively manage incidents and congestion, with the data being readily available to multiple jurisdictional partners for purposes of coordinating transportation management throughout the region. Sacramento and Placer County have already cooperated on a corridor project that provides connectivity between the existing signal systems such that upgrading the signal system would then allow for the opportunity to provide seamless progression across jurisdictional boundaries. Installation of the advanced signal system will also allow further implementation of Transit Signal Priority (TSP), which has already been incorporated on several major corridors, and increase the coverage of Emergency Vehicle Preemption (EVP) infrastructure desired by the fire protection agencies. Portions of this project will be implemented with the Hazel Avenue Phase I and II projects.

**Hazel Avenue Intelligent Transportation System (ITS) Project**

Project Costs	Prior Years	Fiscal Year 2007-08	Fiscal Year 2008-09	Fiscal Year 2009-10	Fiscal Year 2010-11	Fiscal Year 2011-12	Total
Construction Costs	0	0	178,000	177,000	178,000	177,000	710,000
Project Management/Design	0	75,000	0	0	0	0	75,000
Construction Inspection	0	0	5,000	5,000	5,000	5,000	20,000
<b>TOTAL</b>	<b>0</b>	<b>75,000</b>	<b>183,000</b>	<b>182,000</b>	<b>183,000</b>	<b>182,000</b>	<b>805,000</b>

Funding Sources	Prior Years	Fiscal Year 2007-08	Fiscal Year 2008-09	Fiscal Year 2009-10	Fiscal Year 2010-11	Fiscal Year 2011-12	Total
Measure A Sales Tax	0	40,000	92,000	91,000	91,000	91,000	405,000
TEA-21 (ITS)	0	35,000	91,000	91,000	92,000	91,000	400,000
<b>TOTAL</b>	<b>0</b>	<b>75,000</b>	<b>183,000</b>	<b>182,000</b>	<b>183,000</b>	<b>182,000</b>	<b>805,000</b>

**Hazel Avenue Soundwall and Demolition**

Department: Transportation

Estimated Project Cost: \$20,594,000

Expected Completion Date: 2010

Funding Sources: Developer Fees  
New Measure A Sales Tax  
Other Federal  
Federal  
TEA-21  
STIP

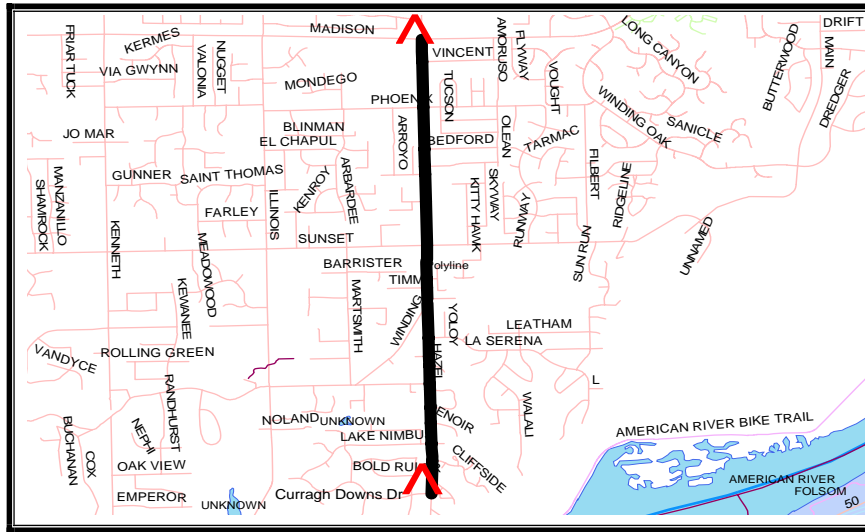

**Project Description:**

This intermediate phase of the Hazel Avenue projects will focus on two parallel construction efforts necessary to accommodate the proposed improvements in the Phase II project from Curragh Downs Drive to Madison Avenue. This phase will accomplish the removal of existing structures within the new proposed Rights-of-Way along with utility trench and soundwall construction.

**Hazel Avenue Soundwall and Demolition**

Project Costs	Prior Years	Fiscal Year 2007-08	Fiscal Year 2008-09	Fiscal Year 2009-10	Fiscal Year 2010-11	Fiscal Year 2011-12	Total
Construction Costs	0	0	0	3,238,000	282,000	0	3,520,000
Project Management/Design	0	28,000	127,000	1,490,000	98,000	0	1,743,000
Right-of-Way Purchase	0	6,235,000	6,297,000	80,000	0	0	12,612,000
Construction Inspection	0	0	0	2,646,000	73,000	0	2,719,000
<b>TOTAL</b>	<b>0</b>	<b>6,263,000</b>	<b>6,424,000</b>	<b>7,454,000</b>	<b>453,000</b>	<b>0</b>	<b>20,594,000</b>

Funding Sources	Prior Years	Fiscal Year 2007-08	Fiscal Year 2008-09	Fiscal Year 2009-10	Fiscal Year 2010-11	Fiscal Year 2011-12	Total
Developer Fees	0	913,000	818,000	248,000	0	0	1,979,000
New Measure A Sales Tax	0	0	3,206,000	3,206,000	453,000	0	6,865,000
STIP	0	1,450,000	0	0	0	0	1,450,000
Federal	0	0	2,400,000	0	0	0	2,400,000
Other Federal	0	0	0	4,000,000	0	0	4,000,000
TEA-21	0	3,900,000	0	0	0	0	3,900,000
<b>TOTAL</b>	<b>0</b>	<b>6,263,000</b>	<b>6,424,000</b>	<b>7,454,000</b>	<b>453,000</b>	<b>0</b>	<b>20,594,000</b>

**Hedge Avenue at State Route 16 (Jackson Road)**

Department: Transportation

Estimated Project Cost: \$1,029,000

Expected Completion Date: 2007

Funding Sources: Measure A Sales Tax  
TEA-21 (HES)  
Other (Caltrans)

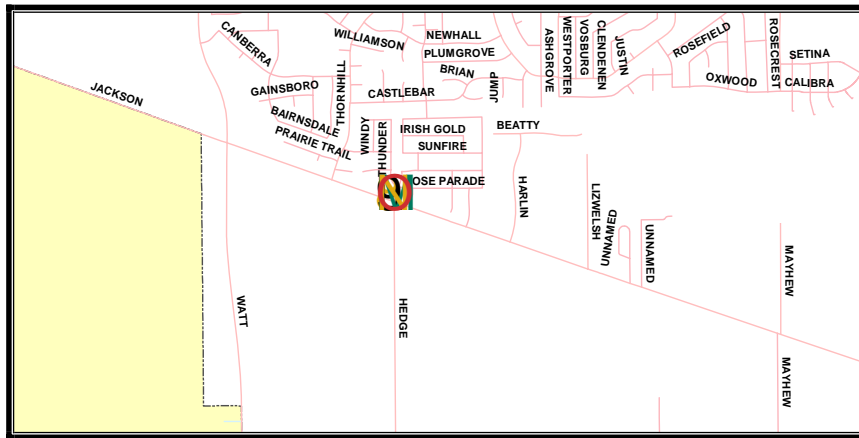

**Project Description:**

The project proposes to install a new four-way traffic signal with a right turn lane at the southwest corner onto Hedge Avenue and a right turn lane at the southeast corner onto State Route 16 (Jackson Road). The work is also including, but not limited to, the placement of traffic signal poles, detector loops, controller cabinet, electrical conduit, pedestrian pushbuttons, minor pavement widening, slurry seal, and striping. Also, the project proposes to reconstruct the existing corner returns to accommodate and meet the requirements of the Americans with Disabilities Act (ADA).

**Operating Budget Impact:**

The operating cost impact of this project is unknown at this time.

**Hedge Avenue at State Route 16 (Jackson Road)**

Project Costs	Prior Years	Fiscal Year 2007-08	Fiscal Year 2008-09	Fiscal Year 2009-10	Fiscal Year 2010-11	Fiscal Year 2011-12	Total
Construction Costs	0	869,000	0	0	0	0	869,000
Project Management/ Design	74,000	6,000	0	0	0	0	80,000
Right-of-Way Purchase	25,000	5,000	0	0	0	0	30,000
Construction Inspection	0	50,000	0	0	0	0	50,000
<b>TOTAL</b>	<b>99,000</b>	<b>930,000</b>	<b>0</b>	<b>0</b>	<b>0</b>	<b>0</b>	<b>1,029,000</b>

Funding Sources	Prior Years	Fiscal Year 2007-08	Fiscal Year 2008-09	Fiscal Year 2009-10	Fiscal Year 2010-11	Fiscal Year 2011-12	Total
Measure A Sales Tax	0	194,000	0	0	0	0	194,000
TEA-21 (HES)	0	328,000	0	0	0	0	328,000
Other (Caltrans)	99,000	408,000	0	0	0	0	507,000
<b>TOTAL</b>	<b>99,000</b>	<b>930,000</b>	<b>0</b>	<b>0</b>	<b>0</b>	<b>0</b>	<b>1,029,000</b>



**Hurley Way Revitalization Planning Study – Watt Avenue to American River Parkway**

**Department:** Transportation

**Estimated Project Cost:** \$160,000

**Expected Completion Date:** 2007

**Funding Sources:** TEA-21 (TEA)  
Other (ECOS)

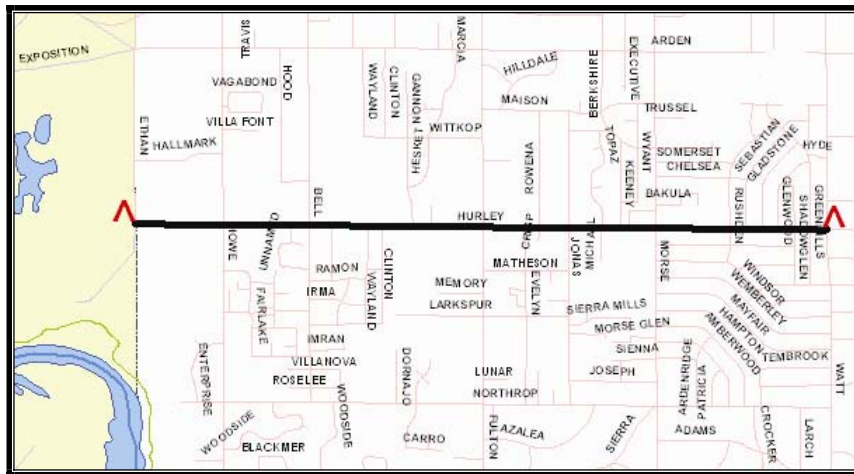

**Project Description:**

The project will perform planning for the reconfiguration of the street, including analysis, design and planning of sidewalk infrastructure, pedestrian crosswalks, transit facilities, intersection and drainage improvements, landscaping and bicycle lanes.

**Operating Budget Impact:**

The operating cost impact of this project is unknown at this time.

**Hurley Way Revitalization Planning Study – Watt Avenue to American River Parkway**

Project Costs	Prior Years	Fiscal Year 2007-08	Fiscal Year 2008-09	Fiscal Year 2009-10	Fiscal Year 2010-11	Fiscal Year 2011-12	Total
Project Management/Design	83,000	77,000	0	0	0	0	160,000

Funding Sources	Prior Years	Fiscal Year 2007-08	Fiscal Year 2008-09	Fiscal Year 2009-10	Fiscal Year 2010-11	Fiscal Year 2011-12	Total
TEA-21 (TEA)	73,000	67,000	0	0	0	0	140,000
Other (ECOS)	10,000	10,000	0	0	0	0	20,000
<b>TOTAL</b>	<b>83,000</b>	<b>77,000</b>	<b>0</b>	<b>0</b>	<b>0</b>	<b>0</b>	<b>160,000</b>



**Interstate 5 (I-5) at Metro Air Parkway Interchange**

**Department:** Transportation

**Estimated Project Cost:** \$23,067,000

**Expected Completion Date:** 2011

**Funding Sources:** Measure A Sales Tax  
Financing District (Metro AP)

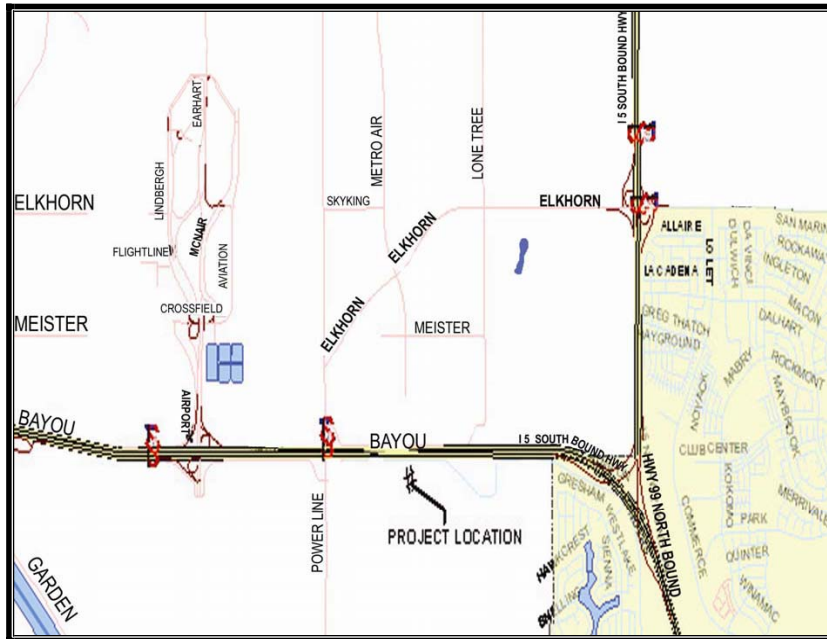

**Project Description:**

This project is a State Highway project to construct an interchange at the intersection of Interstate 5 and Metro Air Parkway. The first phase of this project includes the Bayou Way realignment to provide right-of-way for partial completion of two-quadrant partial cloverleaf interchange, single-lane northbound I-5 exit ramp and diagonal entrance ramp, single-lane southbound I-5 exit ramp, two-lane southbound I-5 loop entrance ramp with auxillary lane, and three-lane overcrossing and roadway with connection to the north with Metro Air Parkway and terminating to the south with a cul-de-sac. Connection deferred to later phase.

The project is scheduled to begin construction in 2009 and to be completed in 2011.

**Interstate 5 (I-5) at Metro Air Parkway Interchange**

Project Costs	Prior Years	Fiscal Year 2007-08	Fiscal Year 2008-09	Fiscal Year 2009-10	Fiscal Year 2010-11	Fiscal Year 2011-12	Total
Construction Costs	0	0	0	4,294,000	12,881,000	0	17,175,000
Project Management/Design	1,946,000	582,000	1,151,000	0	0	0	3,679,000
Right-of-Way	0	0	719,000	0	0	0	719,000
Purchase Construction	0	0	0	694,000	800,000	0	1,494,000
Inspection	0	0	0	0	0	0	0
<b>TOTAL</b>	<b>1,946,000</b>	<b>582,000</b>	<b>1,870,000</b>	<b>4,988,000</b>	<b>13,681,000</b>	<b>0</b>	<b>23,067,000</b>

Funding Sources	Prior Years	Fiscal Year 2007-08	Fiscal Year 2008-09	Fiscal Year 2009-10	Fiscal Year 2010-11	Fiscal Year 2011-12	Total
Measure A Sales Tax	539,000	0	0	0	0	0	539,000
Financing District (Metro AP)	1,407,000	582,000	1,870,000	4,988,000	13,681,000	0	22,528,000
<b>TOTAL</b>	<b>1,946,000</b>	<b>582,000</b>	<b>1,870,000</b>	<b>4,988,000</b>	<b>13,681,000</b>	<b>0</b>	<b>23,067,000</b>

**Intersection Improvements - Disabled Access 05/06**

**Department:** Transportation

**Estimated Project Cost:** \$2,596,000

**Expected Completion Date:** 2008

**Funding Sources:** Measure A Sales Tax

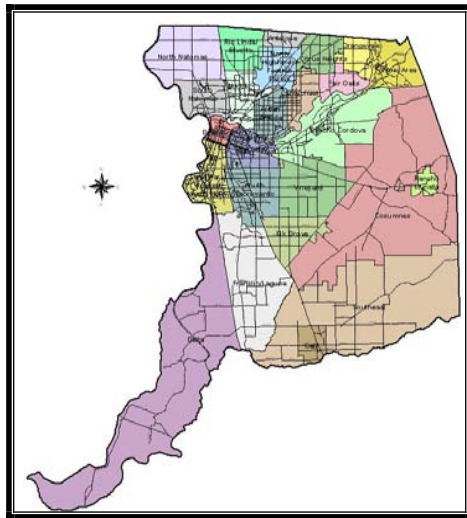

**Project Description:**

This project provides for the development and implementation of audible signals and other Americans with Disabilities Act (ADA) compliant upgrades at various locations throughout the County of Sacramento. The audible signals will be installed in accordance with the latest County Standards and current ADA requirements. The locations are based on citizens' requests and recommended by the County's Physical Access Subcommittee (PASC) of the Disability Advisory Committee. The locations are:

- Antelope Road at Watt Avenue
- Auburn Boulevard at Hemlock Street
- Auburn Boulevard at Garfield Avenue
- Fulton Avenue at Hurley Way

- Arden Way at Professional Drive
- Auburn Boulevard at Palm Avenue
- Cottage Way at Bell Street
- Howe Avenue at Hurley Way

Locations may be added or deleted based on the PASC's subsequent recommendations.

**Operating Budget Impact:**

The operating cost impact of this project is unknown at this time.

Intersection Improvements - Disabled Access 05/06							
Project Costs	Prior Years	Fiscal Year 2007-08	Fiscal Year 2008-09	Fiscal Year 2009-10	Fiscal Year 2010-11	Fiscal Year 2011-12	Total
Construction Costs	300,000	1,480,000	0	0	0	0	1,780,000
Project Management/ Design	464,000	0	0	0	0	0	464,000
Right-of-Way Purchase	154,000	0	0	0	0	0	154,000
Construction Inspection	50,000	148,000	0	0	0	0	198,000
<b>TOTAL</b>	<b>968,000</b>	<b>1,628,000</b>	<b>0</b>	<b>0</b>	<b>0</b>	<b>0</b>	<b>2,596,000</b>

Funding Sources	Prior Years	Fiscal Year 2007-08	Fiscal Year 2008-09	Fiscal Year 2009-10	Fiscal Year 2010-11	Fiscal Year 2011-12	Total
Measure A Sales Tax	968,000	1,628,000	0	0	0	0	2,596,000

**Intersection Improvements - Disabled Access, Phase III**

**Department:** Transportation

**Estimated Project Cost:** \$1,467,000

**Expected Completion Date:** 2008

**Funding Sources:** Measure A Sales Tax

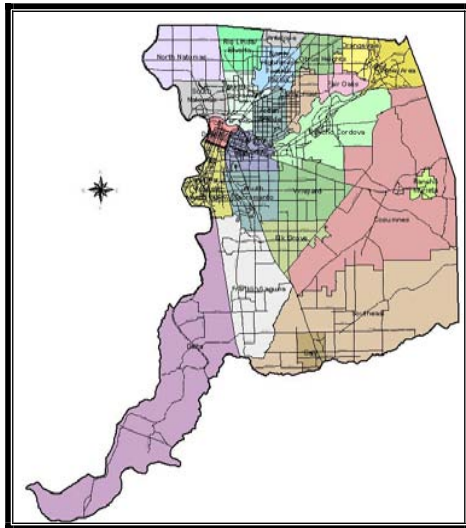

**Project Description:**

This project provides for the development and implementation of audible signals and other Americans with Disabilities Act (ADA) compliant upgrades at various locations throughout the County of Sacramento. The audible signals will be installed in accordance with the latest County Standards and current ADA requirements. The locations are based on citizens' requests and recommended by the County's Physical Access Subcommittee (PASC) of the Disability Advisory Committee. The locations are:

El Camino Avenue at Country Club  
 El Camino Avenue at Howe Avenue  
 Southport Drive at Kiefer Boulevard

Fair Oaks Boulevard at California Avenue  
 Fulton Avenue at Alta Arden Expressway  
 Walnut Avenue at Whitney Avenue

Locations may be added or deleted based on the PASC's subsequent recommendations.

Intersection Improvements - Disabled Access, Phase III							
Project Costs	Prior Years	Fiscal Year 2007-08	Fiscal Year 2008-09	Fiscal Year 2009-10	Fiscal Year 2010-11	Fiscal Year 2011-12	Total
Construction Cost	0	559,000	441,000	0	0	0	1,000,000
Project Management/Design	111,000	201,000	23,000	0	0	0	335,000
Right-of-Way							
Purchase Construction	7,000	33,000	0	0	0	0	40,000
Inspection	0	51,000	41,000	0	0	0	92,000
<b>TOTAL</b>	<b>118,000</b>	<b>844,000</b>	<b>505,000</b>	<b>0</b>	<b>0</b>	<b>0</b>	<b>1,467,000</b>

Funding Sources	Prior Years	Fiscal Year 2007-08	Fiscal Year 2008-09	Fiscal Year 2009-10	Fiscal Year 2010-11	Fiscal Year 2011-12	Total
Measure A Sales Tax	118,000	844,000	505,000	0	0	0	1,467,000

**Left -Turn Lane Projects - Various Locations**

**Department:** Transportation

**Estimated Project Cost:** \$765,000\*

**Expected Completion Date:** Ongoing

**Funding Sources:** Measure A Sales Tax  
New Measure A Sales Tax

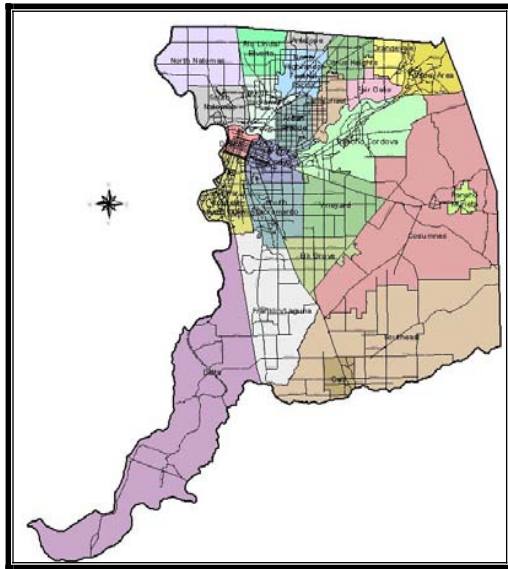

**Project Description:**

This project provides for the installation of left turn lanes in accordance with the Project Priority List. Specific locations will be approved by the Board of Supervisors when funding is committed and project development begins.

\*The total estimated project schedule exceeds the 5 year plan, therefore the project budget is greater than the five year plan shown on the following page.

**Left -Turn Lane Projects - Various Locations**

<b>Project Costs</b>	<b>Prior Years</b>	<b>Fiscal Year 2007-08</b>	<b>Fiscal Year 2008-09</b>	<b>Fiscal Year 2009-10</b>	<b>Fiscal Year 2010-11</b>	<b>Fiscal Year 2011-12</b>	<b>Total</b>
Construction Costs	0	0	20,000	0	40,000	0	60,000
Project Management/Design	0	25,000	0	60,000	0	60,000	145,000
Construction Inspection	0	0	60,000	0	200,000	0	260,000
<b>TOTAL</b>	<b>0</b>	<b>25,000</b>	<b>80,000</b>	<b>60,000</b>	<b>240,000</b>	<b>60,000</b>	<b>465,000</b>

<b>Funding Sources</b>	<b>Prior Years</b>	<b>Fiscal Year 2007-08</b>	<b>Fiscal Year 2008-09</b>	<b>Fiscal Year 2009-10</b>	<b>Fiscal Year 2010-11</b>	<b>Fiscal Year 2011-12</b>	<b>Total</b>
Measure A Sales Tax	0	25,000	80,000	0	0	0	105,000
New Measure A Sales Tax	0	0	0	60,000	240,000	60,000	360,000
<b>TOTAL</b>	<b>0</b>	<b>25,000</b>	<b>80,000</b>	<b>60,000</b>	<b>240,000</b>	<b>60,000</b>	<b>465,000</b>

**MacReady Avenue Reconstruction**

**Department:** Transportation

**Estimated Project Cost:** \$4,509,000

**Expected Completion Date:** 2009

**Funding Sources:** Other (Dept of Airports)

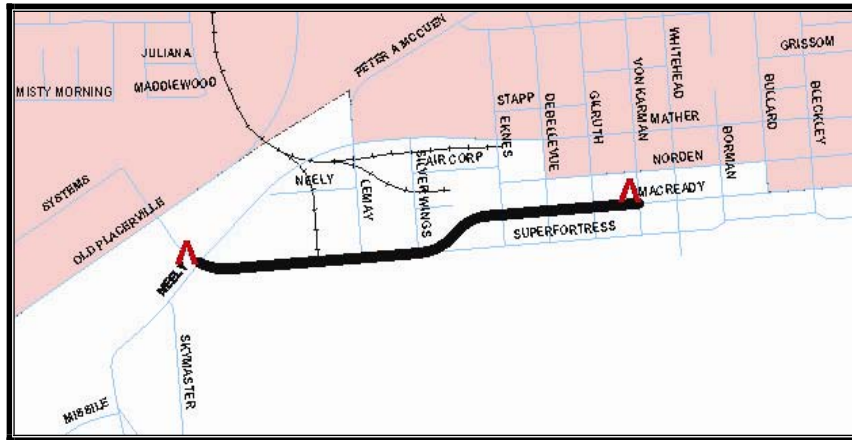

**Project Description:**

This project will be a two-phased effort. Phase I will engineer the interior roadway rehabilitation for MacReady Avenue between Neely Way/Mather Boulevard to Von Karmen Street. The engineering effort will examine needs for utilities, curbs, drainage, etc. Phase II will utilize the results of the engineering analysis and will include the physical rehabilitation of the pavement and modifying the utilities as necessary.

**MacReady Avenue Reconstruction**

Project Costs	Prior Years	Fiscal Year 2007-08	Fiscal Year 2008-09	Fiscal Year 2009-10	Fiscal Year 2010-11	Fiscal Year 2011-12	Total
Construction Costs	0	1,376,000	2,153,000	0	0	0	3,529,000
Project Management/ Design	298,000	131,000	0	0	0	0	429,000
Construction Inspection	0	149,000	402,000	0	0	0	551,000
<b>TOTAL</b>	<b>298,000</b>	<b>1,656,000</b>	<b>2,555,000</b>	<b>0</b>	<b>0</b>	<b>0</b>	<b>4,509,000</b>

Funding Sources	Prior Years	Fiscal Year 2007-08	Fiscal Year 2008-09	Fiscal Year 2009-10	Fiscal Year 2010-11	Fiscal Year 2011-12	Total
Other (Dept Airports)	298,000	1,656,000	2,555,000	0	0	0	4,509,000





**Madison Avenue Tree Planting Project**

**Department:** Transportation

**Estimated Project Cost:** \$940,000

**Expected Completion Date:** 2008

**Funding Sources:** Tree Preservation Fund

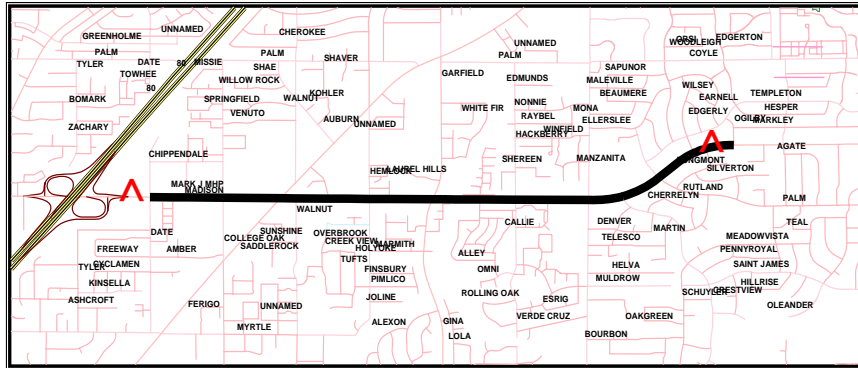

**Project Description:**

This project is a landscape installation project in the existing medians along Madison Avenue. A majority of the funding will come from the Sacramento Housing and Redevelopment Agency (SHRA) through a block grant. The Tree Preservation Fund money is being used to enhance the commercial corridor of Madison Avenue. Sacramento County Department of Transportation (SacDOT) will enter into an agreement with SHRA to provide design, bidding assistance, and construction oversight services on the project from Date Avenue to Hackberry Lane. SacDOT will also include oak tree planting and mulch cover in the medians between Manzanita Avenue and Ogilby Way by using Tree Preservation Fund money. This project is within County right-of-way.

The objectives of the project are:

- 1) Improve the overall aesthetic enhancement and economic viability of the Madison Avenue Corridor.
- 2) Plant trees and landscape in the medians.
- 3) Install an automatic irrigation system, where water service is feasible, to maintain the landscape efficiently. If water service is not available, the landscape will be maintained via truck watering.

There is no road widening, major curb replacement or median re-configuration proposed in the current scope of work.

**Operating Budget Impact:**

The operating cost impact of this project is unknown at this time.

**Madison Avenue Tree Planting Project**

Project Costs	Prior Years	Fiscal Year 2007-08	Fiscal Year 2008-09	Fiscal Year 2009-10	Fiscal Year 2010-11	Fiscal Year 2011-12	Total
Construction Costs	0	830,000	0	0	0	0	830,000
Project Management/ Design	41,000	24,000	0	0	0	0	65,000
Construction Inspection	0	45,000	0	0	0	0	45,000
<b>TOTAL</b>	<b>41,000</b>	<b>899,000</b>	<b>0</b>	<b>0</b>	<b>0</b>	<b>0</b>	<b>940,000</b>

Funding Sources	Prior Years	Fiscal Year 2007-08	Fiscal Year 2008-09	Fiscal Year 2009-10	Fiscal Year 2010-11	Fiscal Year 2011-12	Total
Tree Preservation Fund	41,000	899,000	0	0	0	0	940,000



**Major Intersection Projects - Various Locations**

**Department:** Transportation

**Estimated Project Cost:** \$3,780,000\*

**Expected Completion Date:** Ongoing

**Funding Sources:** Measure A Sales Tax,  
New Measure A Sales Tax

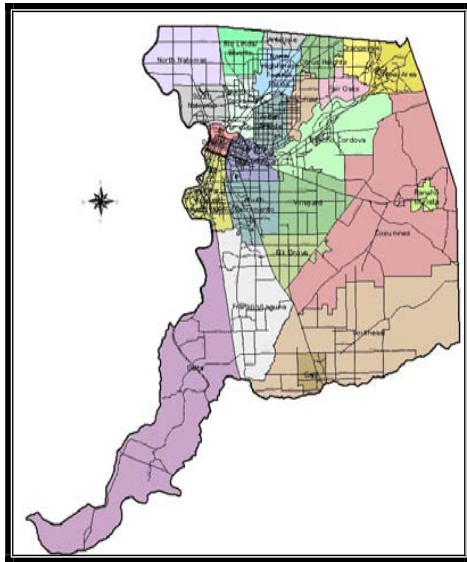

**Project Description:**

This project provides for the construction of major intersection projects in accordance with the Project Priority List. Specific locations will be approved by the Board of Supervisors when funding is committed and project development begins.

\*The total estimated project schedule exceeds the 5 year plan, therefore the project budget is greater than the five year plan shown on the following page.

Major Intersection Projects - Various Locations							
Project Costs	Prior Years	Fiscal Year 2007-08	Fiscal Year 2008-09	Fiscal Year 2009-10	Fiscal Year 2010-11	Fiscal Year 2011-12	Total
Construction Costs	0	0	0	1,240,000	0	0	1,240,000
Project Management/ Design	0	100,000	200,000	0	100,000	200,000	600,000
Right-of-Way Purchase	0	0	0	160,000	0	0	160,000
<b>TOTAL</b>	<b>0</b>	<b>100,000</b>	<b>200,000</b>	<b>1,400,000</b>	<b>100,000</b>	<b>200,000</b>	<b>2,000,000</b>

Funding Sources	Prior Years	Fiscal Year 2007-08	Fiscal Year 2008-09	Fiscal Year 2009-10	Fiscal Year 2010-11	Fiscal Year 2011-12	Total
Measure A Sales Tax	0	100,000	200,000	0	0	0	300,000
New Measure A Sales Tax	0	0	0	1,400,000	100,000	200,000	1,700,000
<b>TOTAL</b>	<b>0</b>	<b>100,000</b>	<b>200,000</b>	<b>1,400,000</b>	<b>100,000</b>	<b>200,000</b>	<b>2,000,000</b>



**Neighborhood Traffic Management Program**

**Department:** Transportation

**Estimated Project Cost:** \$6,550,000\*

**Expected Completion Date:** Ongoing

**Funding Sources:** Measure A Sales Tax  
New Measure A Sales Tax

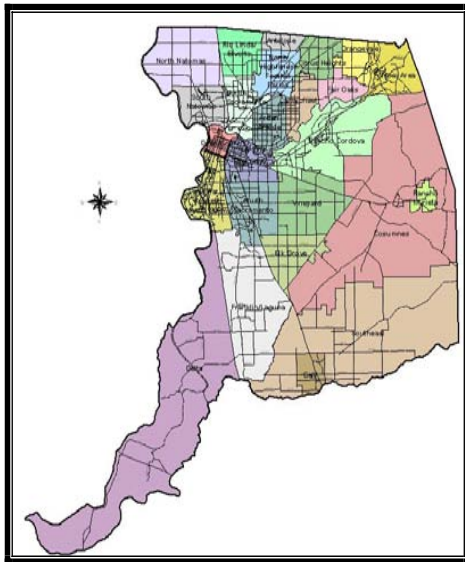

**Project Description:**

The development of the Neighborhood Traffic Management Program (NTMP) represents a comprehensive update to Sacramento County’s current approach towards addressing neighborhood traffic related issues. The NTMP will develop a manual to educate residents on what tools are available and their effects. The NTMP will also provide a systematic approach to initiating citizen requests to treat neighborhood traffic issues. A key element that will be developed is the neighborhood involvement in developing and approving a neighborhood traffic management plan. The NTMP will be considered a “Toolbox” for more options to treat traffic related issues. Implementation of the new NTMP will lead to new street design guidelines for new developments to reduce the future need for neighborhood traffic management devices.

\*The total estimated project schedule exceeds the 5 year plan, therefore the project budget is greater than the five year plan shown on the following page.

Project Costs	Prior Years	Fiscal Year 2007-08	Fiscal Year 2008-09	Fiscal Year 2009-10	Fiscal Year 2010-11	Fiscal Year 2011-12	Total
Construction Costs	150,000	250,000	375,000	500,000	500,000	500,000	2,275,000
Project Management/ Design	150,000	250,000	375,000	500,000	500,000	500,000	2,275,000
<b>TOTAL</b>	<b>300,000</b>	<b>500,000</b>	<b>750,000</b>	<b>1,000,000</b>	<b>1,000,000</b>	<b>1,000,000</b>	<b>4,550,000</b>

Funding Sources	Prior Years	Fiscal Year 2007-08	Fiscal Year 2008-09	Fiscal Year 2009-10	Fiscal Year 2010-11	Fiscal Year 2011-12	Total
Measure A Sales Tax	300,000	500,000	750,000	0	0	0	1,550,000
New Measure A Sales Tax	0	0	0	1,000,000	1,000,000	1,000,000	3,000,000
<b>TOTAL</b>	<b>300,000</b>	<b>500,000</b>	<b>750,000</b>	<b>1,000,000</b>	<b>1,000,000</b>	<b>1,000,000</b>	<b>4,550,000</b>

**North Kiefer Boulevard - Closure at Kiefer Boulevard**

Department: Transportation

Estimated Project Cost: \$1,029,000

Expected Completion Date: 2008

Funding Sources: Road Fund  
Fair Share/In Lieu  
Measure A Sales Tax

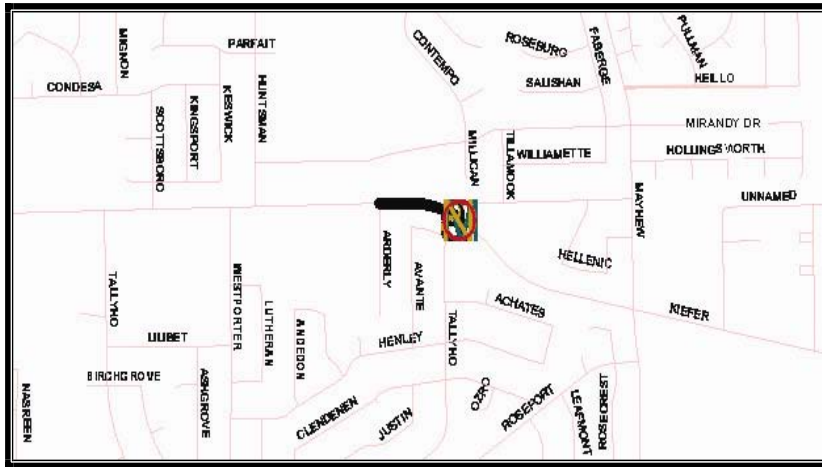

**Project Description:**

This project will provide a disconnection for vehicle access to North Kiefer Boulevard from Kiefer Boulevard by installing a cul-de-sac bulb on North Kiefer Boulevard. The project will also install a new traffic signal at the “T” intersection of Kiefer Boulevard at Tallyho Drive (east). Other improvements include the installation of curb, gutter, sidewalk, and asphalt paving that will connect the existing sidewalk improvements on the north side of Kiefer Boulevard from Arderly Court, east to the intersection at Kiefer Boulevard and Tallyho Drive (east). Existing sidewalk ramps at the intersection will be upgraded to comply with current Americans with Disabilities Act (ADA) standards. Landscaping will be included in the cul-de-sac area. Slurry seal and new striping will be included throughout the length of the project.

**North Kiefer Boulevard - Closure at Kiefer Boulevard**

Project Costs	Prior Years	Fiscal Year 2007-08	Fiscal Year 2008-09	Fiscal Year 2009-10	Fiscal Year 2010-11	Fiscal Year 2011-12	Total
Construction Costs	0	300,000	423,000	0	0	0	723,000
Project Management/ Design	131,000	18,000	0	0	0	0	149,000
Right-of-Way Purchase	3,000	19,000	0	0	0	0	22,000
Construction Inspection	0	33,000	102,000	0	0	0	135,000
<b>TOTAL</b>	<b>134,000</b>	<b>370,000</b>	<b>525,000</b>	<b>0</b>	<b>0</b>	<b>0</b>	<b>1,029,000</b>

Funding Sources	Prior Years	Fiscal Year 2007-08	Fiscal Year 2008-09	Fiscal Year 2009-10	Fiscal Year 2010-11	Fiscal Year 2011-12	Total
Road Fund	0	202,000	0	0	0	0	202,000
Measure A Sales Tax	0	0	370,000	0	0	0	370,000
Fair Share/In Lieu	134,000	168,000	155,000	0	0	0	457,000
<b>TOTAL</b>	<b>134,000</b>	<b>370,000</b>	<b>525,000</b>	<b>0</b>	<b>0</b>	<b>0</b>	<b>1,029,000</b>

**North Vineyard Traffic Signals**

**Department:** Transportation

**Estimated Project Cost:** \$3,630,000

**Expected Completion Date:** 2009

**Funding Sources:** Finance District (NVS)

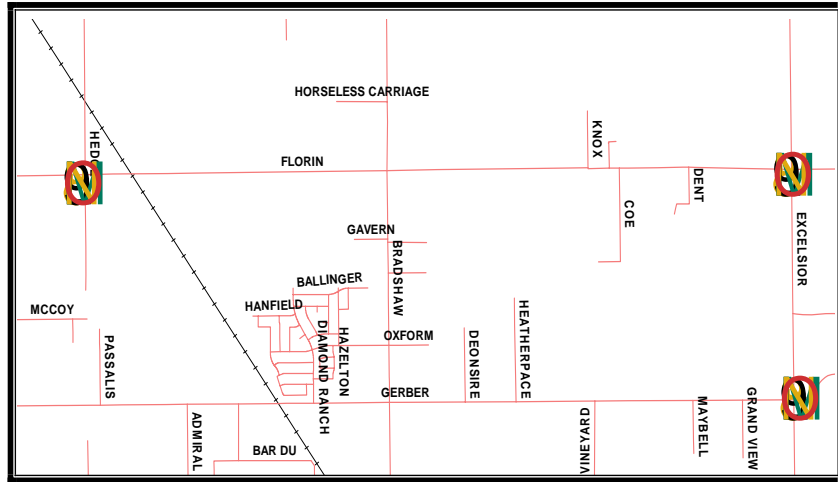

**Project Description:**

This project consists of the installation of traffic signals at the intersections of Excelsior Road at Gerber Road/Birch Ranch Drive, Excelsior Road at Florin Road, and Florin Road at Hedge Avenue.

The construction of these traffic signals is triggered by the North Vineyard Station Specific Plan.

North Vineyard Traffic Signals

Project Costs	Prior Years	Fiscal Year 2007-08	Fiscal Year 2008-09	Fiscal Year 2009-10	Fiscal Year 2010-11	Fiscal Year 2011-12	Total
Construction Costs	0	735,000	1,925,000	0	0	0	2,660,000
Project Management/Design	522,000	0	0	0	0	0	522,000
Right-of-Way Purchase	181,000	0	0	0	0	0	181,000
Construction Inspection	0	87,000	180,000	0	0	0	267,000
<b>TOTAL</b>	<b>703,000</b>	<b>822,000</b>	<b>2,105,000</b>	<b>0</b>	<b>0</b>	<b>0</b>	<b>3,630,000</b>

Funding Sources	Prior Years	Fiscal Year 2007-08	Fiscal Year 2008-09	Fiscal Year 2009-10	Fiscal Year 2010-11	Fiscal Year 2011-12	Total
Finance District (NVS)	703,000	822,000	2,105,000	0	0	0	3,630,000

**Pavement Maintenance Project 06/07**

**Department:** Transportation

**Estimated Project Cost:** \$7,860,000

**Expected Completion Date:** 2008

**Funding Sources:** Other State (GTIP)

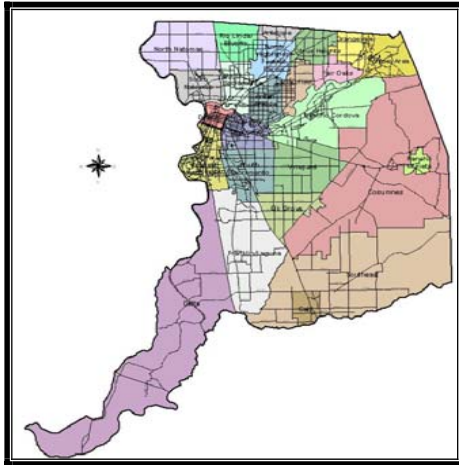

**Project Description:**

This project consist of placing conventional asphalt concrete pavement, placing slurry seal, base repair, cold planing asphalt concrete pavements, adjusting manholes to grade, removing and replacing concrete curb, gutter, and sidewalk, installing sidewalk accessibility curb ramps, replacing inductive loop detectors, installing hand holes and re-striping the pavement to conform to the existing configuration to the striping plans.

**Project Locations:**

- Arden Way - Hurley Way / Morse Avenue - Watt Avenue
- Arden Way - Hurley Way / County Line - Fulton Avenue
- Cottage Way - Arden Way / Morse Avenue - Watt Avenue
- Don Julio Boulevard - Karl Drive / Walerga Road - Watt Avenue
- Highway 99 - County Line / 47<sup>th</sup> Avenue - Morrison Creek
- Madison Avenue - Sunset Avenue / Sunrise Boulevard / San Juan Avenue
- Steiner Drive - County Line / 47<sup>th</sup> Avenue - Morrison Creek
- Kiefer Boulevard - Jackson Road / Tallyho Drive / Westporter Drive - Bradshaw Road
- Sunset Avenue - American River / Illinois Avenue - Folsom Lake Recreation Area

**Operating Budget Impact:**

The operating cost impact of this project is unknown at this time.

**Pavement Maintenance Project 06/07**

<b>Project Costs</b>	<b>Prior Years</b>	<b>Fiscal Year 2007-08</b>	<b>Fiscal Year 2008-09</b>	<b>Fiscal Year 2009-10</b>	<b>Fiscal Year 2010-11</b>	<b>Fiscal Year 2011-12</b>	<b>Total</b>
Construction Costs	0	7,630,000	0	0	0	0	7,630,000
Project Management/ Design	123,000	0	0	0	0	0	123,000
Construction Inspection	0	107,000	0	0	0	0	107,000
<b>TOTAL</b>	<b>123,000</b>	<b>7,737,000</b>	<b>0</b>	<b>0</b>	<b>0</b>	<b>0</b>	<b>7,860,000</b>

<b>Funding Sources</b>	<b>Prior Years</b>	<b>Fiscal Year 2007-08</b>	<b>Fiscal Year 2008-09</b>	<b>Fiscal Year 2009-10</b>	<b>Fiscal Year 2010-11</b>	<b>Fiscal Year 2011-12</b>	<b>Total</b>
Other State (GTIP)	123,000	7,737,000	0	0	0	0	7,860,000

**Pedestrian Master Plan Implementation Project - Various Locations**

**Department:** Transportation

**Estimated Project Cost:** \$6,000,000

**Expected Completion Date:** 2009

**Funding Sources:** Measure A Sales Tax  
Federal Funds (TEA-21: CMAQ)

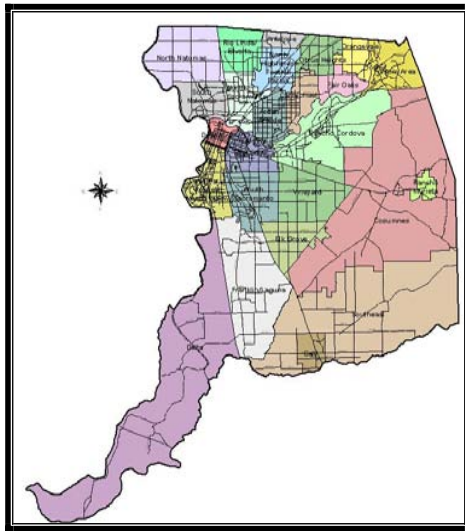

**Project Description:**

This project will construct pedestrian facilities and improvements on El Camino Avenue from Ethan Way to Mission Avenue and Marconi Avenue from Fair Oaks Boulevard to Walnut Avenue in accordance with the adopted Sacramento County Pedestrian Master Plan. The project includes improvements to existing corridors to enhance pedestrian safety and mobility, including sidewalk and walkway construction, pedestrian signal installation, improvements to existing signalized and non-signalized intersections, pedestrian crossings and other improvements to benefit pedestrian access and safety. All improvements will be constructed in compliance with pedestrian facility improvement standards set forth in the Master Plan.

**Pedestrian Master Plan Implementation Project - Various Locations**

Project Costs	Prior Years	Fiscal Year 2007-08	Fiscal Year 2008-09	Fiscal Year 2009-10	Fiscal Year 2010-11	Fiscal Year 2011-12	Total
Construction Costs	0	0	4,706,000	0	0	0	4,706,000
Project Management/Design	116,000	449,000	0	0	0	0	565,000
Construction Inspection	0	0	729,000	0	0	0	729,000
<b>TOTAL</b>	<b>116,000</b>	<b>449,000</b>	<b>5,435,000</b>	<b>0</b>	<b>0</b>	<b>0</b>	<b>6,000,000</b>

Funding Sources	Prior Years	Fiscal Year 2007-08	Fiscal Year 2008-09	Fiscal Year 2009-10	Fiscal Year 2010-11	Fiscal Year 2011-12	Total
Measure A Sales Tax	14,000	51,000	2,206,000	0	0	0	2,271,000
Federal Funds (TEA-21: CMAQ)	102,000	398,000	3,229,000	0	0	0	3,729,000
<b>TOTAL</b>	<b>116,000</b>	<b>449,000</b>	<b>5,435,000</b>	<b>0</b>	<b>0</b>	<b>0</b>	<b>6,000,000</b>

**Power Inn Road - Florin Road to Elder Creek Road**

Department: Transportation

Estimated Project Cost: \$1,662,000

Expected Completion Date: 2010

Funding Sources: Road Fund  
Other (None Identified)

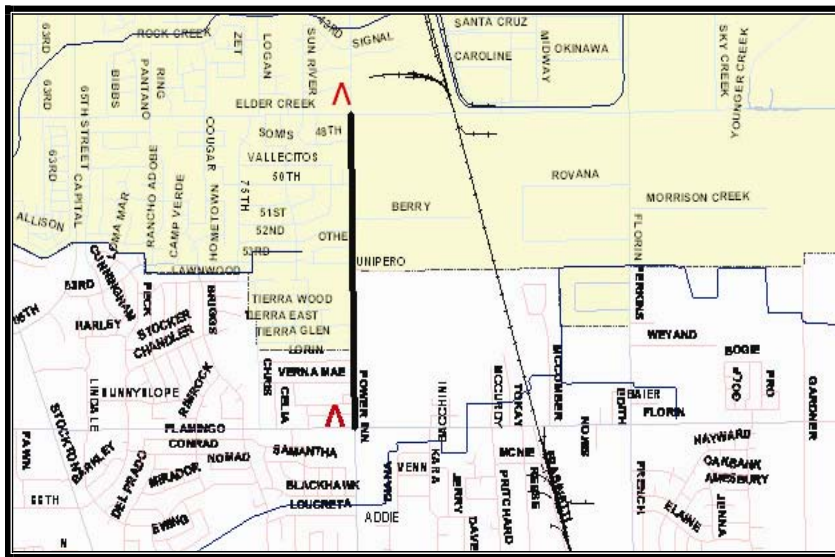

**Project Description:**

This project will include the widening of Power Inn Road between Florin Road and Elder Creek Road to accommodate two through-lanes in each direction, a center two-way left turn lane, a 6-foot bike lane on the east side, and a 5-foot bike lane with curb, gutter, and sidewalk on the west side. New curb ramps will also be installed at appropriate intersection crossings and in compliance with Americans with Disabilities Act (ADA) requirements.

Power Inn Road - Florin Road to Elder Creek Road

Project Costs	Prior Years	Fiscal Year 2007-08	Fiscal Year 2008-09	Fiscal Year 2009-10	Fiscal Year 2010-11	Fiscal Year 2011-12	Total
Construction Costs	0	0	0	0	1,000,000	0	1,000,000
Project Management/ Design	0	0	193,000	106,000	0	0	299,000
Right-of-Way Purchase	0	0	0	220,000	0	0	220,000
Construction Inspection	0	0	0	0	143,000	0	143,000
<b>TOTAL</b>	<b>0</b>	<b>0</b>	<b>193,000</b>	<b>326,000</b>	<b>1,143,000</b>	<b>0</b>	<b>1,662,000</b>

Funding Sources	Prior Years	Fiscal Year 2007-08	Fiscal Year 2008-09	Fiscal Year 2009-10	Fiscal Year 2010-11	Fiscal Year 2011-12	Total
Road Fund	0	0	193,000	0	0	0	193,000
Other (None Identified)	0	0	0	326,000	1,143,000	0	1,469,000
<b>TOTAL</b>	<b>0</b>	<b>0</b>	<b>193,000</b>	<b>326,000</b>	<b>1,143,000</b>	<b>0</b>	<b>1,662,000</b>



**Sloughhouse Road at Grantline Road Traffic Signal**

**Department:** Transportation                      **Estimated Project Cost:** \$650,000  
**Expected Completion Date:** 2008                      **Funding Sources:** Developer Funded

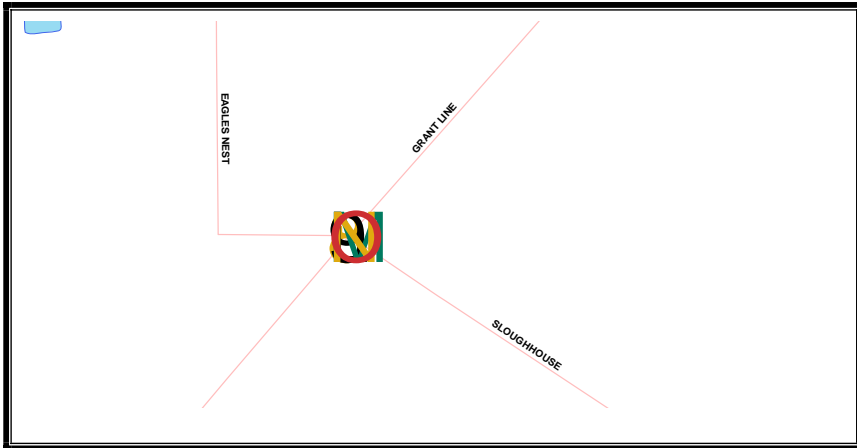

**Project Description:**  
 This project consists of the installation of a traffic signal at the intersection of Sloughhouse Road at Grantline Road.

**Operating Budget Impact:**  
 The operating cost impact of this project is unknown at this time.

Sloughhouse Road at Grantline Road Traffic Signal							
Project Costs	Prior Years	Fiscal Year 2007-08	Fiscal Year 2008-09	Fiscal Year 2009-10	Fiscal Year 2010-11	Fiscal Year 2011-12	Total
Construction Costs	0	450,000	0	0	0	0	450,000
Project Management/ Design	45,000	30,000	0	0	0	0	75,000
Construction Inspection	0	125,000	0	0	0	0	125,000
<b>TOTAL</b>	<b>45,000</b>	<b>605,000</b>	<b>0</b>	<b>0</b>	<b>0</b>	<b>0</b>	<b>650,000</b>

Funding Sources	Prior Years	Fiscal Year 2007-08	Fiscal Year 2008-09	Fiscal Year 2009-10	Fiscal Year 2010-11	Fiscal Year 2011-12	Total
Developer Funded	45,000	605,000	0	0	0	0	650,000

**South Mather Roadways Improvements**

**Department:** Transportation

**Estimated Project Cost:** \$80,000,000\*

**Expected Completion Date:** 2013

**Funding Sources:** Financing District  
(Mather Field)  
City of Rancho Cordova

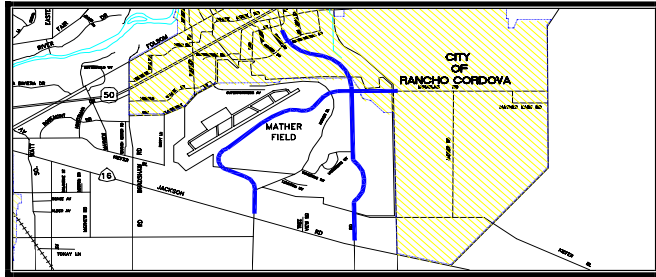

**Project Description:**

This project proposes to realign and construct several roadways in the south area of Mather Field. The first phase will involve development and analysis of alternative roadway alignments. Phase 2 will provide for preliminary design for the completion of the environmental document that will be prepared by Sacramento County and permitting for work at the Folsom South Canal. The final design will provide the construction of the project under separate contracts. Roadway segments may be advanced ahead of another to meet City of Rancho Cordova and County of Sacramento development in the area. Roadway segments proposed for improvements.

Zinfandel Drive – Douglas Road to Villages of Zinfandel

Construct six lanes with raised landscaped median, curb and gutter and installation of traffic signals at the intersections of Zinfandel/Douglas and Zinfandel/Villages of Zinfandel.

Douglas Road – Sunrise Boulevard to Zinfandel Drive

Widen from two to six lanes with raised landscaped median, curb, gutter and a bridge replacement over the Folsom South Canal with bike path.

Douglas Road Extension – Zinfandel Drive to Kiefer Boulevard

Construct approximately three miles of new four-lane roadway with raised landscaped median, curb, gutter and sidewalk. Installation of traffic signals at Douglas/Kiefer and Douglas/Excelsior Road.

Excelsior Road – Kiefer Boulevard to Jackson Road

Construct and widen to four lanes with raised landscaped median, curb, gutter and a pit pump station.

Eagles Nest Road – Jackson Road to Kiefer Boulevard

Construct two lanes with raised landscaped median and install of a traffic signal at Eagles Nest Road/Jackson Road.

Eagles Nest Road – Kiefer Boulevard to Douglas Road (Curve Alignment)

Construct and widen to four lanes with curb, gutter, sidewalk, raised landscaped median and 3” asphalt concrete overlay. Improvements also include installation of a box culvert and traffic signals at Eagles Nest Road/Douglas Road and Eagles Nest Road/Kiefer Boulevard.

\*The total estimated project schedule exceeds the 5 year plan, therefore the project budget is greater than the five year plan shown on the following page.

South Mather Roadways Improvements

Project Costs	Prior Years	Fiscal Year 2007-08	Fiscal Year 2008-09	Fiscal Year 2009-10	Fiscal Year 2010-11	Fiscal Year 2011-12	Total
Construction Costs	0	0	0	13,750,000	13,750,000	13,750,000	41,250,000
Project Management/Design	1,000,000	2,500,000	6,035,000	1,650,000	0	0	11,185,000
Right-of-Way Purchase	0	465,000	2,550,000	2,550,000	0	0	5,565,000
Construction Inspection	0	0	0	2,062,000	2,063,000	2,062,000	6,187,000
<b>TOTAL</b>	<b>1,000,000</b>	<b>2,965,000</b>	<b>8,585,000</b>	<b>20,012,000</b>	<b>15,813,000</b>	<b>15,812,000</b>	<b>64,187,000</b>

Funding Sources	Prior Years	Fiscal Year 2007-08	Fiscal Year 2008-09	Fiscal Year 2009-10	Fiscal Year 2010-11	Fiscal Year 2011-12	Total
City of Rancho Cordova	400,000	2,965,000	8,585,000	20,012,000	15,813,000	15,812,000	63,587,000
Financing District (Mather Field)	600,000	0	0	0	0	0	600,000
<b>TOTAL</b>	<b>1,000,000</b>	<b>2,965,000</b>	<b>8,585,000</b>	<b>20,012,000</b>	<b>15,813,000</b>	<b>15,812,000</b>	<b>64,187,000</b>

**South Sacramento Traffic Calming Project, Phase II**

**Department:** Transportation

**Estimated Project Cost:** \$190,000

**Expected Completion Date:** 2008

**Funding Sources:** Other (SHRA; CDBG)

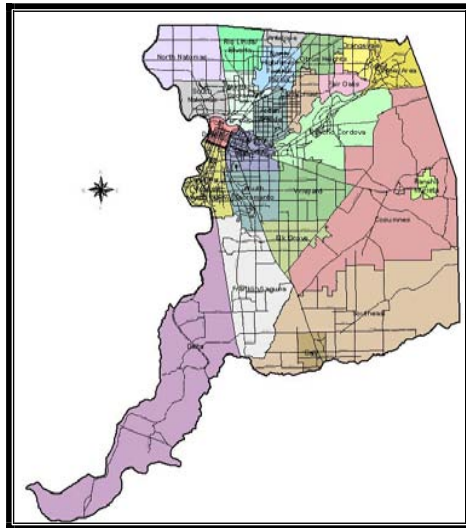

**Project Description:**

The Department of Transportation Operations and Maintenance will construct several raised crosswalks and install a traffic circle.

**Project Locations:**

- 42<sup>nd</sup> Street south of 20<sup>th</sup> Avenue
- 44<sup>th</sup> Street between 26<sup>th</sup> Avenue and Soledad Avenue
- 44<sup>th</sup> Street between 25<sup>th</sup> Avenue and 26<sup>th</sup> Avenue
- 68<sup>th</sup> Avenue between Florinda Way and Power Inn Road
- Del Norte Boulevard between Soledad Avenue
- Loucreta Drive between Florinda Way and Power Inn Road
- Mendocino Boulevard between 26<sup>th</sup> Avenue and Fruitridge Road
- Steiner Drive adjacent to school north of Frawley Way
- Stiener Drive at 53<sup>rd</sup> Avenue

**Operating Budget Impact:**

The operating cost impact of this project is unknown at this time.

South Sacramento Traffic Calming Project, Phase II							
Project Costs	Prior Years	Fiscal Year 2007-08	Fiscal Year 2008-09	Fiscal Year 2009-10	Fiscal Year 2010-11	Fiscal Year 2011-12	Total
Construction Costs	0	100,000	0	0	0	0	100,000
Project Management/Design	31,000	27,000	0	0	0	0	58,000
Construction Inspection	4,000	28,000	0	0	0	0	32,000
<b>TOTAL</b>	<b>35,000</b>	<b>155,000</b>	<b>0</b>	<b>0</b>	<b>0</b>	<b>0</b>	<b>190,000</b>

Funding Sources	Prior Years	Fiscal Year 2007-08	Fiscal Year 2008-09	Fiscal Year 2009-10	Fiscal Year 2010-11	Fiscal Year 2011-12	Total
Other (SHRA, CDBG)	35,000	155,000	0	0	0	0	190,000

**South Watt Avenue - Florin Road to State Route 16 (Jackson Road)**

**Department:** Transportation

**Estimated Project Cost:** \$10,103,000

**Expected Completion Date:** 2012

**Funding Sources:** Developer Fees  
Financing District (NVS)  
Other (Florin Vineyard)

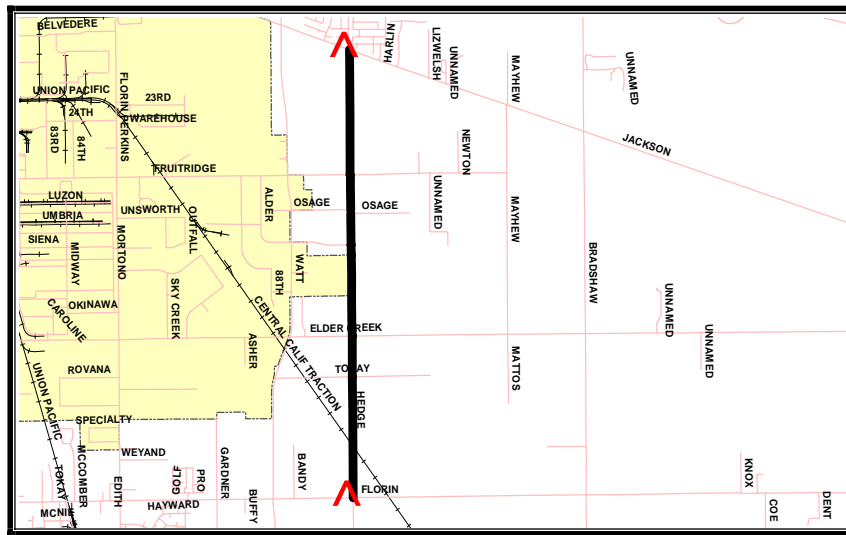

**Project Description:**

This project will widen South Watt Avenue from two to four lanes between Florin Road and State Route 16. The project is included in the proposed North Vineyard Station Capital Improvement Program. Partial funding will come from the North Vineyard Station Financing Plan.

**South Watt Avenue - Florin Road to State Route 16 (Jackson Road)**

Project Costs	Prior Years	Fiscal Year 2007-08	Fiscal Year 2008-09	Fiscal Year 2009-10	Fiscal Year 2010-11	Fiscal Year 2011-12	Total
Construction Costs	0	0	0	0	960,000	7,040,000	8,000,000
Project Management/Design	0	0	340,000	76,000	198,000	0	614,000
Right-of-Way Purchase	0	0	23,000	705,000	97,000	0	825,000
Construction Inspection	0	0	0	0	0	664,000	664,000
<b>TOTAL</b>	<b>0</b>	<b>0</b>	<b>363,000</b>	<b>781,000</b>	<b>1,255,000</b>	<b>7,704,000</b>	<b>10,103,000</b>

Funding Sources	Prior Years	Fiscal Year 2007-08	Fiscal Year 2008-09	Fiscal Year 2009-10	Fiscal Year 2010-11	Fiscal Year 2011-12	Total
Developer Fees	0	0	363,000	781,000	1,255,000	3,707,000	6,106,000
Financing District (NVS)	0	0	0	0	0	315,000	315,000
Other (Florin Vineyard)	0	0	0	0	0	3,682,000	3,682,000
<b>TOTAL</b>	<b>0</b>	<b>0</b>	<b>363,000</b>	<b>781,000</b>	<b>1,255,000</b>	<b>7,704,000</b>	<b>10,103,000</b>

**South Watt Avenue - State Route 16 (Jackson Road) to Kiefer Boulevard**

**Department:** Transportation

**Estimated Project Cost:** \$6,237,000

**Expected Completion Date:** 2009

**Funding Sources:** Developer Fees  
Measure A Sales Tax  
Other (SLPP) State Local Partnership Program

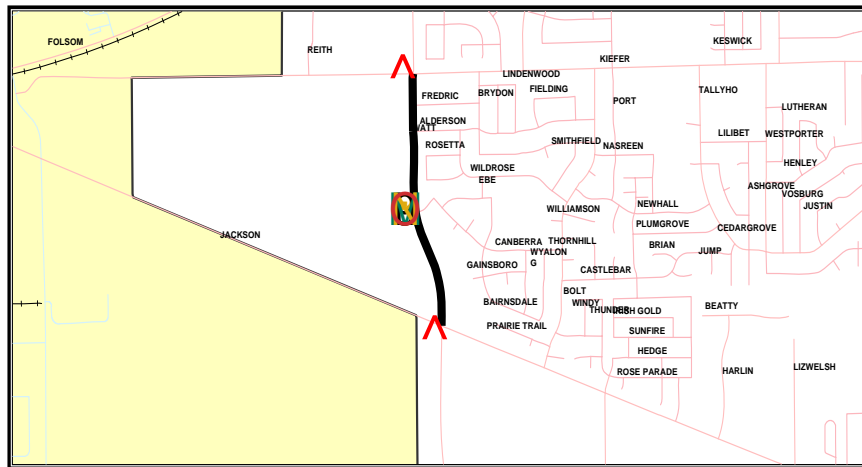

**Project Description:**

This project will widen South Watt Avenue from two to five lanes with landscape medians and left turn lanes between Kiefer Boulevard and State Route 16 in the Rosemont area. The project will also install a traffic signal at South Watt Avenue and Canberra Drive.

This project is Number 1 on the Department’s 2007 Major Highway Improvements Project Priority List. Volume/Capacity ratio is 2.14 and 24-hour traffic volume is 32,134 vehicles.

**South Watt Avenue - State Route 16 (Jackson Road) to Kiefer Boulevard**

Project Costs	Prior Years	Fiscal Year 2007-08	Fiscal Year 2008-09	Fiscal Year 2009-10	Fiscal Year 2010-11	Fiscal Year 2011-12	Total
Construction Costs	0	4,130,000	611,000	0	0	0	4,741,000
Project Management/ Design	587,000	72,000	0	0	0	0	659,000
Right-of-Way Purchase	520,000	0	0	0	0	0	520,000
Construction Inspection	0	258,000	59,000	0	0	0	317,000
<b>TOTAL</b>	<b>1,107,000</b>	<b>4,460,000</b>	<b>670,000</b>	<b>0</b>	<b>0</b>	<b>0</b>	<b>6,237,000</b>

Funding Sources	Prior Years	Fiscal Year 2007-08	Fiscal Year 2008-09	Fiscal Year 2009-10	Fiscal Year 2010-11	Fiscal Year 2011-12	Total
Developer Fees	1,107,000	1,566,000	338,000	0	0	0	3,011,000
Measure A Sales Tax	0	700,000	0	0	0	0	700,000
Other State (SLPP)	0	2,194,000	332,000	0	0	0	2,526,000
<b>TOTAL</b>	<b>1,107,000</b>	<b>4,460,000</b>	<b>670,000</b>	<b>0</b>	<b>0</b>	<b>0</b>	<b>6,237,000</b>

**State Route 99 at Elverta Road Interchange**

Department: Transportation

Estimated Project Cost: \$29,824,000

Expected Completion Date: 2012

Funding Sources: Finance District (Metro)  
Other State (SR99)

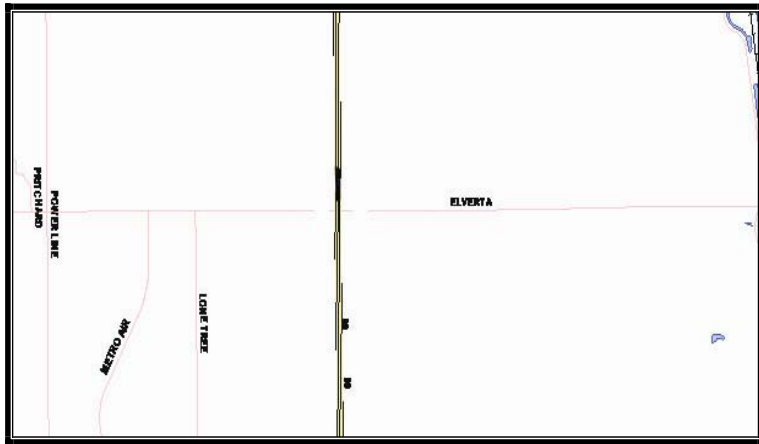

**Project Description:**

The project will construct a new interchange to replace the existing at-grade intersection in this location. The interchange will be constructed to its ultimate configuration including a standard Type L-9 two-quadrant partial cloverleaf interchange with ramp meters and High Occupancy Vehicle by-pass lanes. The four-lane overcrossing will have sufficient span to accommodate an eight-lane mainline. The project also includes off-ramp terminus traffic signals.

State Route 99 at Elverta Road Interchange

Project Costs	Prior Years	Fiscal Year 2007-08	Fiscal Year 2008-09	Fiscal Year 2009-10	Fiscal Year 2010-11	Fiscal Year 2011-12	Total
Construction Costs	0	0	0	0	10,796,000	10,796,000	21,592,000
Project Management/Design	14,000	250,000	1,800,000	0	0	0	2,064,000
Right-of-Way Purchase	0	0	0	3,360,000	0	0	3,360,000
Construction Inspection	0	0	0	0	1,404,000	1,404,000	2,808,000
<b>TOTAL</b>	<b>14,000</b>	<b>250,000</b>	<b>1,800,000</b>	<b>3,360,000</b>	<b>12,200,000</b>	<b>12,200,000</b>	<b>29,824,000</b>

Funding Sources	Prior Years	Fiscal Year 2007-08	Fiscal Year 2008-09	Fiscal Year 2009-10	Fiscal Year 2010-11	Fiscal Year 2011-12	Total
Finance District (Metro)	14,000	250,000	1,800,000	3,360,000	1,404,000	3,886,000	10,714,000
Other State (SR99)	0	0	0	0	10,796,000	8,314,000	19,110,000
<b>TOTAL</b>	<b>14,000</b>	<b>250,000</b>	<b>1,800,000</b>	<b>3,360,000</b>	<b>12,200,000</b>	<b>12,200,000</b>	<b>29,824,000</b>

**Tobacco Pavement Maintenance Project**

**Department:** Transportation

**Estimated Project Cost:** \$1,650,000

**Expected Completion Date:** 2008

**Funding Sources:** Other (Tobacco Fund)  
SHRA

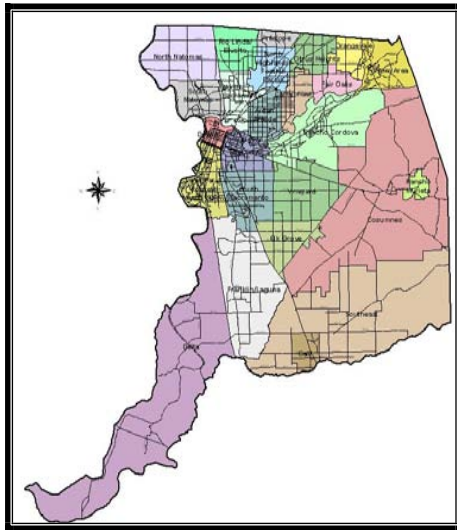

**Project Description:**

This project consist of placing either two or four inches of conventional asphalt concrete pavement, placing slurry seal, base repair, cold planing asphalt concrete pavements, adjusting manholes to grade, removing and replacing concrete curb, gutter, and sidewalk, installing sidewalk accessibility curb ramps, replacing inductive loop detectors, installing hand holes and re-striping.

**Project Locations:**

- Antelope Road - Monument Drive to Don Julio Boulevard
- Canberra Drive - South Watt Avenue to Thornhill Drive
- Castlebar Way - Thornhill Drive to Cedar Grove Drive
- Excelsior Road - Jackson Road to Woodring Drive
- South Watt Avenue - Kiefer Boulevard to Reith Court

**Operating Budget Impact:**

The operating cost impact of this project is unknown at this time.

**Tobacco Pavement Maintenance Project**

<b>Project Costs</b>	<b>Prior Years</b>	<b>Fiscal Year 2007-08</b>	<b>Fiscal Year 2008-09</b>	<b>Fiscal Year 2009-10</b>	<b>Fiscal Year 2010-11</b>	<b>Fiscal Year 2011-12</b>	<b>Total</b>
Construction Costs	0	1,500,000	0	0	0	0	1,500,000
Project Management/ Design	74,000	0	0	0	0	0	74,000
Construction Inspection	0	76,000	0	0	0	0	76,000
<b>TOTAL</b>	<b>74,000</b>	<b>1,576,000</b>	<b>0</b>	<b>0</b>	<b>0</b>	<b>0</b>	<b>1,650,000</b>

<b>Funding Sources</b>	<b>Prior Years</b>	<b>Fiscal Year 2007-08</b>	<b>Fiscal Year 2008-09</b>	<b>Fiscal Year 2009-10</b>	<b>Fiscal Year 2010-11</b>	<b>Fiscal Year 2011-12</b>	<b>Total</b>
SHRA	35,000	185,000	0	0	0	0	220,000
Other (Tobacco Fund)	39,000	1,391,000	0	0	0	0	1,430,000
<b>TOTAL</b>	<b>74,000</b>	<b>1,576,000</b>	<b>0</b>	<b>0</b>	<b>0</b>	<b>0</b>	<b>1,650,000</b>

**Vineyard Road Bridge at Laguna Creek**

Department: Transportation

Estimated Project Cost: \$5,431,000

Expected Completion Date: 2010

Funding Sources: Financing District (VIN)  
Federal (HBRRP)

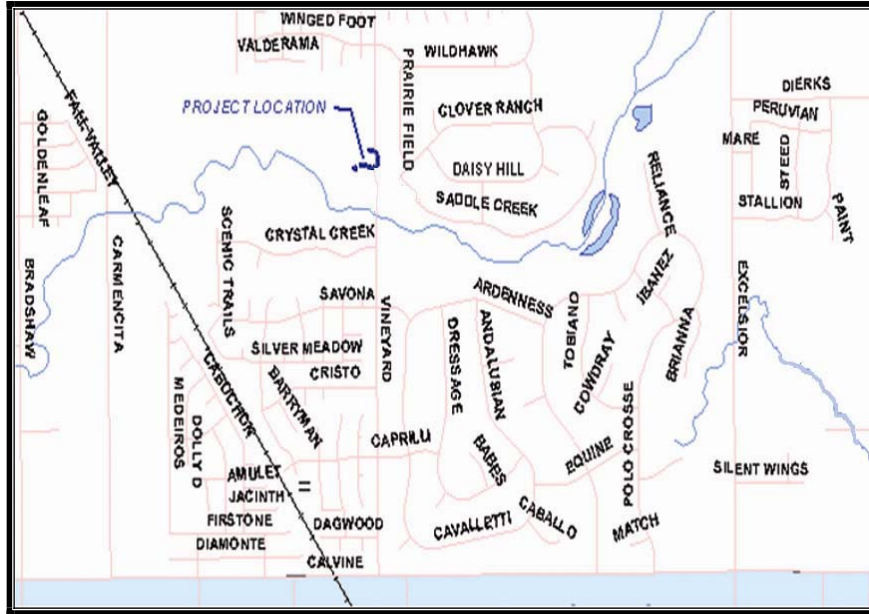

**Project Description:**

This project proposes the replacement of the Vineyard Road Bridge at Laguna Creek with a wider structure with a 4-lane Arterial Roadway section, the roadway widening at bridge approaches to accommodate the median at its ultimate location while maintaining one lane of travel way in each direction. The project also includes the construction of sidewalks along Vineyard Road as necessary to provide continuity of sidewalk in the area.

Vineyard Road Bridge at Laguna Creek

Project Costs	Prior Years	Fiscal Year 2007-08	Fiscal Year 2008-09	Fiscal Year 2009-10	Fiscal Year 2010-11	Fiscal Year 2011-12	Total
Construction Costs	0	0	1,495,000	2,005,000	0	0	3,500,000
Project Management/Design	114,000	611,000	103,000	0	0	0	828,000
Right-of-Way Purchase	0	14,000	134,000	0	0	0	148,000
Construction Inspection	0	0	284,000	671,000	0	0	955,000
<b>TOTAL</b>	<b>114,000</b>	<b>625,000</b>	<b>2,016,000</b>	<b>2,676,000</b>	<b>0</b>	<b>0</b>	<b>5,431,000</b>

Funding Sources	Prior Years	Fiscal Year 2007-08	Fiscal Year 2008-09	Fiscal Year 2009-10	Fiscal Year 2010-11	Fiscal Year 2011-12	Total
Federal (HBRRP)	45,000	613,000	1,762,000	2,422,000	0	0	4,842,000
Financing District (VIN)	69,000	12,000	254,000	254,000	0	0	589,000
<b>TOTAL</b>	<b>114,000</b>	<b>625,000</b>	<b>2,016,000</b>	<b>2,676,000</b>	<b>0</b>	<b>0</b>	<b>5,431,000</b>







**Walerga Road Corridor Improvements**

**Department:** Transportation

**Estimated Project Cost:** \$1,725,000

**Expected Completion Date:** 2008

**Funding Sources:** SAFETEA-LU (CMAQ)  
Other (New Phase Dev)

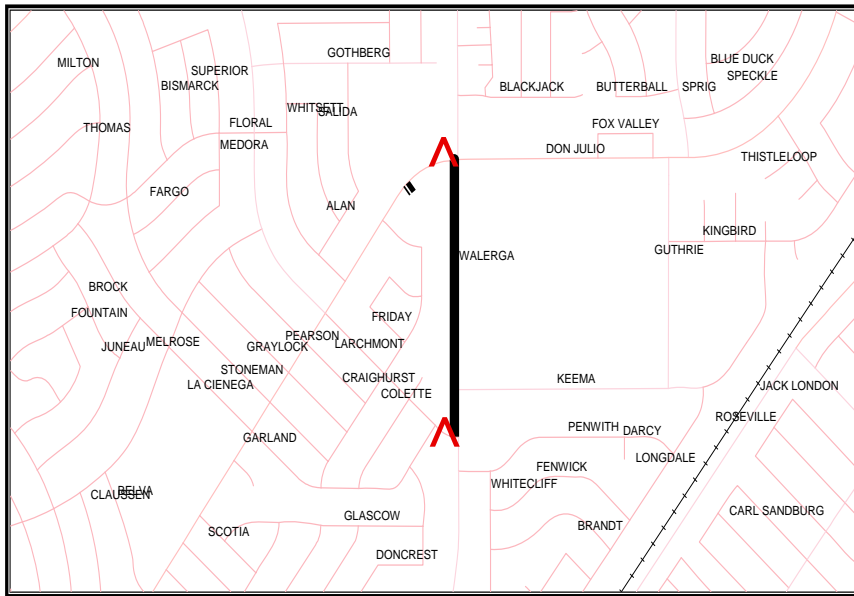

**Project Description:**

This project proposes to construct sidewalks, landscape/streetscape, parking and accessibility, and other bicycle, pedestrian and transit access safety enhancements.

Walerga Road Corridor Improvements

Project Costs	Prior Years	Fiscal Year 2007-08	Fiscal Year 2008-09	Fiscal Year 2009-10	Fiscal Year 2010-11	Fiscal Year 2011-12	Total
Construction Costs	0	0	1,200,000	0	0	0	1,200,000
Project Management/ Design	0	250,000	0	0	0	0	250,000
Construction Inspection	0	0	275,000	0	0	0	275,000
<b>TOTAL</b>	<b>0</b>	<b>250,000</b>	<b>1,475,000</b>	<b>0</b>	<b>0</b>	<b>0</b>	<b>1,725,000</b>

Funding Sources	Prior Years	Fiscal Year 2007-08	Fiscal Year 2008-09	Fiscal Year 2009-10	Fiscal Year 2010-11	Fiscal Year 2011-12	Total
SAFETEA-LU (CMAQ)	0	250,000	1,200,000	0	0	0	1,450,000
Other (New Phase Development)	0	0	275,000	0	0	0	275,000
<b>TOTAL</b>	<b>0</b>	<b>250,000</b>	<b>1,475,000</b>	<b>0</b>	<b>0</b>	<b>0</b>	<b>1,725,000</b>

**Calvine Road to Vintage Park Drive Waterman Road Landscaping Project –**

Department: Transportation

Estimated Project Cost: \$1,878,000

Expected Completion Date: 2009

Funding Sources: Financing District (VIN)

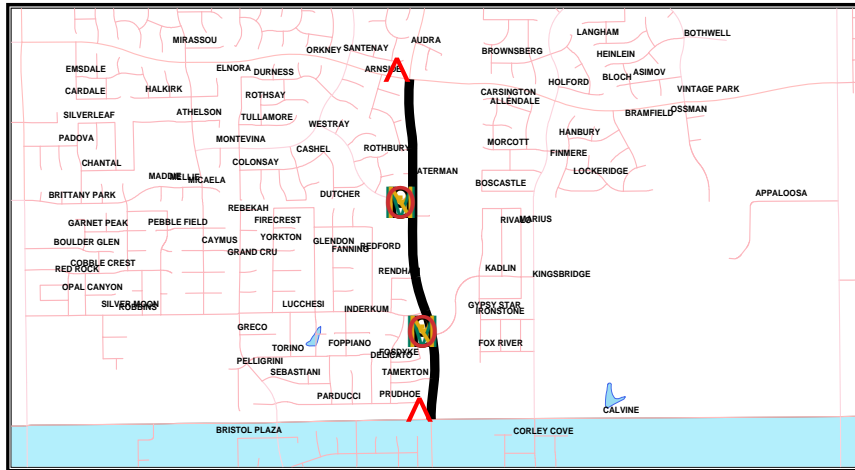

**Project Description:**

The project proposes to install a landscape median on Waterman Road between Calvine Road and Vintage Park Drive. The project will also include the installation of two traffic signals at the intersection of Waterman Road at Kadlin Drive and Waterman Road at Westray Drive. The work will include the construction of concrete curbs, installation of irrigation system, water connection, excavation, planting of trees, plants and shrubs, and decorative concrete.

Waterman Road Landscaping Project - Calvine Road to Vintage park Drive

Project Costs	Prior Years	Fiscal Year 2007-08	Fiscal Year 2008-09	Fiscal Year 2009-10	Fiscal Year 2010-11	Fiscal Year 2011-12	Total
Construction Costs	0	0	1,430,000	0	0	0	1,430,000
Project Management/ Design	88,000	180,000	0	0	0	0	268,000
Right-of-Way Purchase	2,000	42,000	29,000	0	0	0	73,000
Construction Inspection	0	0	107,000	0	0	0	107,000
<b>TOTAL</b>	<b>90,000</b>	<b>222,000</b>	<b>1,566,000</b>	<b>0</b>	<b>0</b>	<b>0</b>	<b>1,878,000</b>

Funding Sources	Prior Years	Fiscal Year 2007-08	Fiscal Year 2008-09	Fiscal Year 2009-10	Fiscal Year 2010-11	Fiscal Year 2011-12	Total
Financing District (VIN)	90,000	222,000	1,566,000	0	0	0	1,878,000

**Watt Avenue at Light Rail Transit (LRT) - Grade Separation**

Department: Transportation

Estimated Project Cost: \$22,515,000

Expected Completion Date: 2008

Funding Sources: Measure A Sales Tax  
TEA-21(RSTP: CMAQ)  
Regional Transit

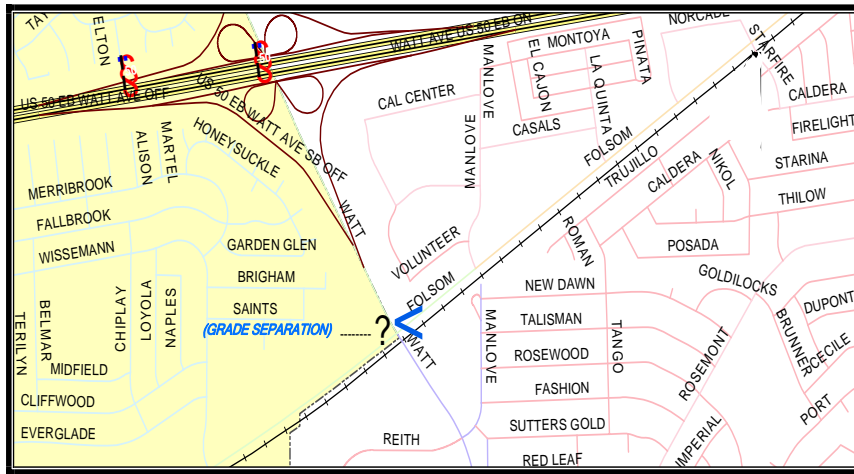

**Project Description:**

This project will construct a grade separation just south of the Folsom Boulevard and Watt Avenue intersection at the light rail tracks over Watt Avenue.

The project has been approved for Federal funding from the Regional Surface Transportation Program (RSTP). The local share is being jointly funded by the County and Regional Transit.

**Operating Budget Impact:**

The operating cost impact of this project is unknown at this time.

**Watt Avenue at Light Rail Transit (LRT) - Grade Separation**

Project Costs	Prior Years	Fiscal Year 2007-08	Fiscal Year 2008-09	Fiscal Year 2009-10	Fiscal Year 2010-11	Fiscal Year 2011-12	Total
Construction Costs	11,717,000	7,283,000	0	0	0	0	19,000,000
Project Management/ Design	1,975,000	0	0	0	0	0	1,975,000
Right-of-Way Purchase	31,000	0	0	0	0	0	31,000
Construction Inspection	831,000	678,000	0	0	0	0	1,509,000
<b>TOTAL</b>	<b>14,554,000</b>	<b>7,961,000</b>	<b>0</b>	<b>0</b>	<b>0</b>	<b>0</b>	<b>22,515,000</b>

Funding Sources	Prior Years	Fiscal Year 2007-08	Fiscal Year 2008-09	Fiscal Year 2009-10	Fiscal Year 2010-11	Fiscal Year 2011-12	Total
Measure A Sales Tax	2,448,000	656,000	0	0	0	0	3,104,000
TEA-21 (RSTP: CMAQ)	12,106,000	6,797,000	0	0	0	0	18,903,000
Other (Regional Transit)	0	508,000	0	0	0	0	508,000
<b>TOTAL</b>	<b>14,554,000</b>	<b>7,961,000</b>	<b>0</b>	<b>0</b>	<b>0</b>	<b>0</b>	<b>22,515,000</b>

**Watt Avenue at Light Rail Transit (LRT) - Grade Separation Landscaping Project**

**Department:** Transportation

**Estimated Project Cost:** \$725,000

**Expected Completion Date:** 2009

**Funding Sources:** Measure A Sales Tax

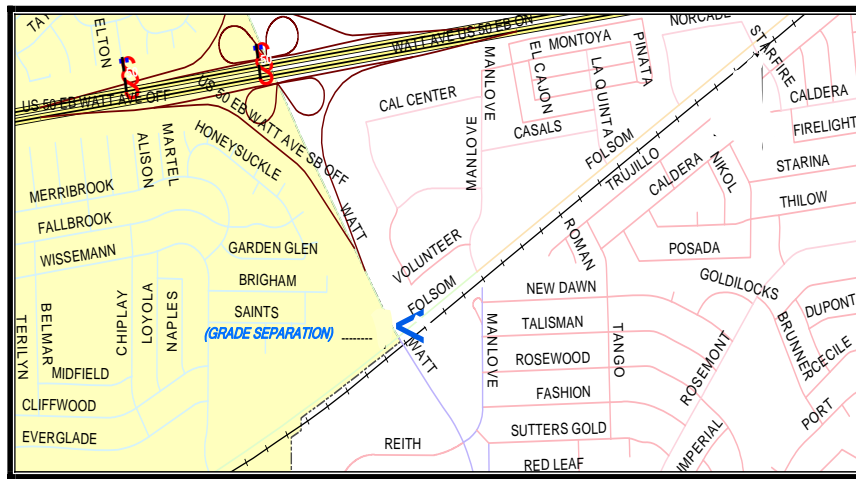

**Project Description:**

This project proposes to install landscaping improvements that will complement the light rail grade separation in and around the intersection of Folsom Boulevard and Watt Avenue. The project's anticipated start of construction is tentatively proposed for April 2009.

**Watt Avenue at Light Rail Transit (LRT) - Grade Separation Landscaping Project**

Project Costs	Prior Years	Fiscal Year 2007-08	Fiscal Year 2008-09	Fiscal Year 2009-10	Fiscal Year 2010-11	Fiscal Year 2011-12	Total
Construction Costs	0	0	550,000	0	0	0	550,000
Project Management/ Design	0	75,000	0	0	0	0	75,000
Construction Inspection	0	0	100,000	0	0	0	100,000
<b>TOTAL</b>	<b>0</b>	<b>75,000</b>	<b>650,000</b>	<b>0</b>	<b>0</b>	<b>0</b>	<b>725,000</b>

Funding Sources	Prior Years	Fiscal Year 2007-08	Fiscal Year 2008-09	Fiscal Year 2009-10	Fiscal Year 2010-11	Fiscal Year 2011-12	Total
Measure A Sales Tax	0	75,000	650,000	0	0	0	725,000

**Watt Avenue at Roseville Road - Pedestrian and Bicycle Access Improvements**

**Department:** Transportation

**Estimated Project Cost:** \$150,000

**Expected Completion Date:** 2007

**Funding Sources:** Measure A Sales Tax  
Other (SACOG)

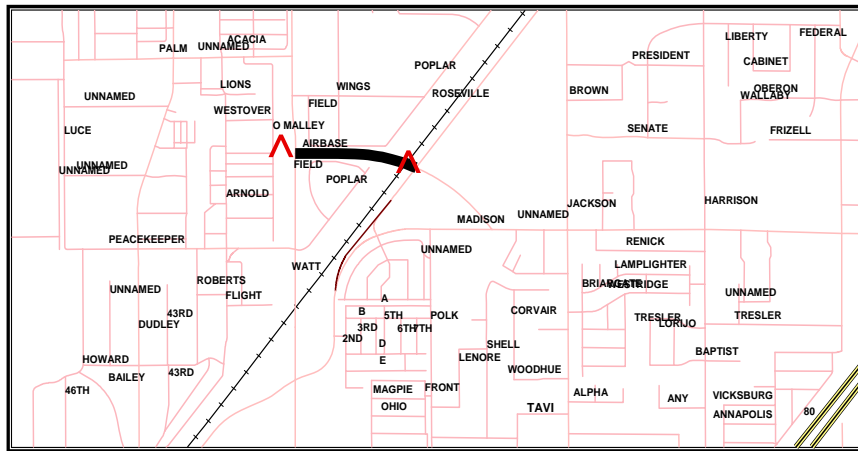

**Project Description:**

This project will examine alternatives for creating a continuous walk and bike path under the Union Pacific Railroad over-crossing at North Watt Avenue and Roseville Road.

**Operating Budget Impact:**

The operating cost impact of this project is unknown at this time.

Watt Avenue at Roseville Road - Pedestrian and Bicycle Access Improvements

Project Costs	Prior Years	Fiscal Year 2007-08	Fiscal Year 2008-09	Fiscal Year 2009-10	Fiscal Year 2010-11	Fiscal Year 2011-12	Total
Project Management/ Design	30,000	120,000	0	0	0	0	150,000

Funding Sources	Prior Years	Fiscal Year 2007-08	Fiscal Year 2008-09	Fiscal Year 2009-10	Fiscal Year 2010-11	Fiscal Year 2011-12	Total
Measure A Sales Tax	4,000	16,000	0	0	0	0	20,000
Other (SACOG)	26,000	104,000	0	0	0	0	130,000
<b>TOTAL</b>	<b>30,000</b>	<b>120,000</b>	<b>0</b>	<b>0</b>	<b>0</b>	<b>0</b>	<b>150,000</b>

**Watt Avenue at U.S. Highway 50 Interchange**

**Department:** Transportation

**Estimated Project Cost:** \$52,520,000

**Expected Completion Date:** 2011

**Funding Sources:** Measure A Sales Tax  
 New Measure A Sales Tax  
 Other (Local Funds)  
 Federal Funds Needed  
 TEA-21 (RSTP) and TCRP  
 Other (None Identified)

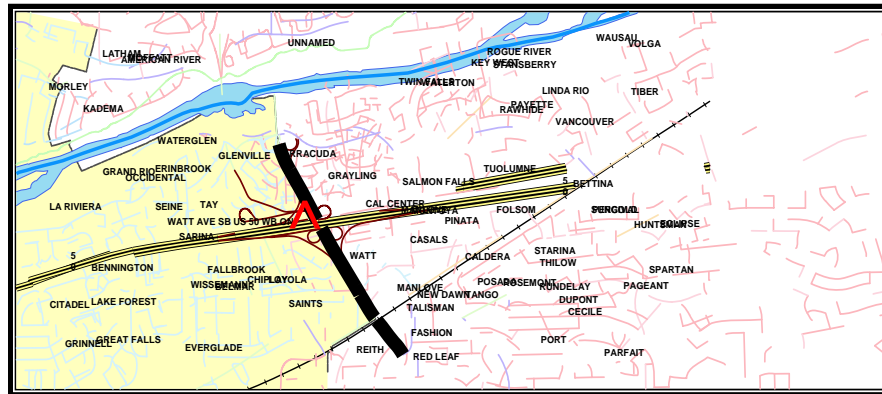

**Project Description:**

This is a State Highway improvement project to modify the existing interchange on U.S. Highway 50 at Watt Avenue, and the intersection of Folsom Boulevard and Watt Avenue. Improvements will be based on the South Watt Area Transportation Study, which is developing a master plan for improvements in the Watt Avenue corridor between the American River and State Route 16.

The project proposes to reconfigure the existing cloverleaf (L-10) interchange to a partial cloverleaf (L-9); the realignment and widening of all freeway ramps, and installation of metering signals; elimination of the existing loop exit freeways; provide a northbound and southbound auxiliary lane on Watt Avenue between U.S. 50 interchange and Manlove Avenue; widen the existing Watt Avenue over crossing to accommodate six through-lanes, two auxiliary lanes, two separated bicycle/pedestrian pathways and a dedicated contra-flow bus rapid transit lane; construct a median bus rapid transit lane on Watt Avenue from the U.S. 50 eastbound exit freeway ramp to Manlove Avenue; north of the interchange, accommodate bus rapid transit lanes in the outside shoulders of northbound and southbound Watt Avenue; and construct separated northbound and southbound bicycle/pedestrian pathways along Watt Avenue between La Riviera Drive and the Folsom Boulevard intersection, including under-crossings at each of the six proposed interchange ramps.

Partial funding has been approved for this project from the State Traffic Congestion Relief Program (TCRP). It is anticipated that additional funding from Federal or State sources will be needed to finance the construction phase of this project.

Watt Avenue at U.S. Highway 50 Interchange

Project Costs	Prior Years	Fiscal Year 2007-08	Fiscal Year 2008-09	Fiscal Year 2009-10	Fiscal Year 2010-11	Fiscal Year 2011-12	Total
Construction Costs	0	0	0	24,845,000	17,355,000	0	42,200,000
Project Management/Design	1,393,000	2,866,000	1,046,000	0	0	0	5,305,000
Right-of-Way Purchase	0	16,000	2,095,000	0	0	0	2,111,000
Construction Inspection	0	0	0	1,382,000	1,522,000	0	2,904,000
<b>TOTAL</b>	<b>1,393,000</b>	<b>2,882,000</b>	<b>3,141,000</b>	<b>26,227,000</b>	<b>18,877,000</b>	<b>0</b>	<b>52,520,000</b>

Funding Sources	Prior Years	Fiscal Year 2007-08	Fiscal Year 2008-09	Fiscal Year 2009-10	Fiscal Year 2010-11	Fiscal Year 2011-12	Total
Measure A Sales Tax	304,000	474,000	1,290,000	6,868,000	0	0	8,936,000
New Measure A Sales Tax	0	0	0	519,000	7,581,000	0	8,100,000
Other (Local Funds)	0	0	0	0	5,000,000	0	5,000,000
Other (None Identified)	0	0	0	12,488,000	6,296,000	0	18,784,000
Federal Funds Needed	0	1,349,000	1,851,000	0	0	0	3,200,000
TEA-21 (RSTP)	441,000	1,059,000	0	0	0	0	1,500,000
TCRP	648,000	0	0	6,352,000	0	0	7,000,000
<b>TOTAL</b>	<b>1,393,000</b>	<b>2,882,000</b>	<b>3,141,000</b>	<b>26,227,000</b>	<b>18,877,000</b>	<b>0</b>	<b>52,520,000</b>



**Watt Avenue Enhancements, Phase II**

**Department:** Transportation

**Estimated Project Cost:** \$9,492,000

**Expected Completion Date:** 2008

**Funding Sources:** Measure A Sales Tax  
STIP (STEA)

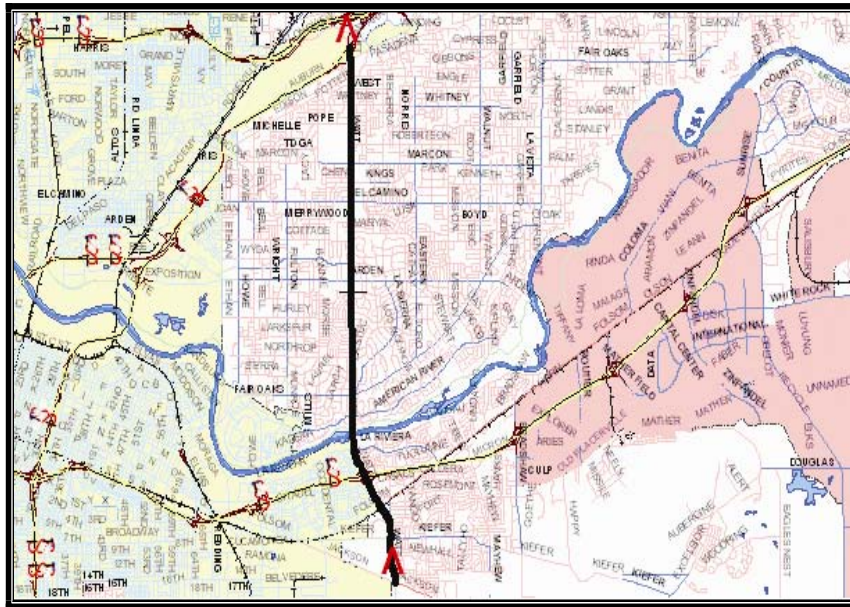

**Project Description:**

This project will implement elements of the Watt Avenue Beautification Master Plan, including the design and construction of improvements and enhancements recommended in the Plan. Proposed improvements include landscape median enhancements between 500 feet north of Fair Oaks Boulevard and Whitney Avenue. In addition, intersection enhancements and sidewalks will be installed at Edison Avenue.

The project has been approved for Federal funding from the State Transportation Improvement Program (STIP).

**Operating Budget Impact:**

The operating cost impact of this project is unknown at this time.

Watt Avenue Enhancements, Phase II

Project Costs	Prior Years	Fiscal Year 2007-08	Fiscal Year 2008-09	Fiscal Year 2009-10	Fiscal Year 2010-11	Fiscal Year 2011-12	Total
Construction Costs	4,040,000	2,560,000	0	0	0	0	6,600,000
Project Management/Design	1,801,000	0	0	0	0	0	1,801,000
Right-of-Way Purchase	287,000	0	0	0	0	0	287,000
Construction Inspection	488,000	316,000	0	0	0	0	804,000
<b>TOTAL</b>	<b>6,616,000</b>	<b>2,876,000</b>	<b>0</b>	<b>0</b>	<b>0</b>	<b>0</b>	<b>9,492,000</b>

Funding Sources	Prior Years	Fiscal Year 2007-08	Fiscal Year 2008-09	Fiscal Year 2009-10	Fiscal Year 2010-11	Fiscal Year 2011-12	Total
Measure A Sales Tax	2,283,000	209,000	0	0	0	0	2,492,000
STIP (STEA)	4,333,000	2,667,000	0	0	0	0	7,000,000
<b>TOTAL</b>	<b>6,616,000</b>	<b>2,876,000</b>	<b>0</b>	<b>0</b>	<b>0</b>	<b>0</b>	<b>9,492,000</b>

**Watt Avenue Queue Jump and Right Turn Lane Project**

**Department:** Transportation

**Estimated Project Cost:** \$2,210,000

**Expected Completion Date:** 2009

**Funding Sources:** Measure A Sales Tax  
TEA-21 (ITS)

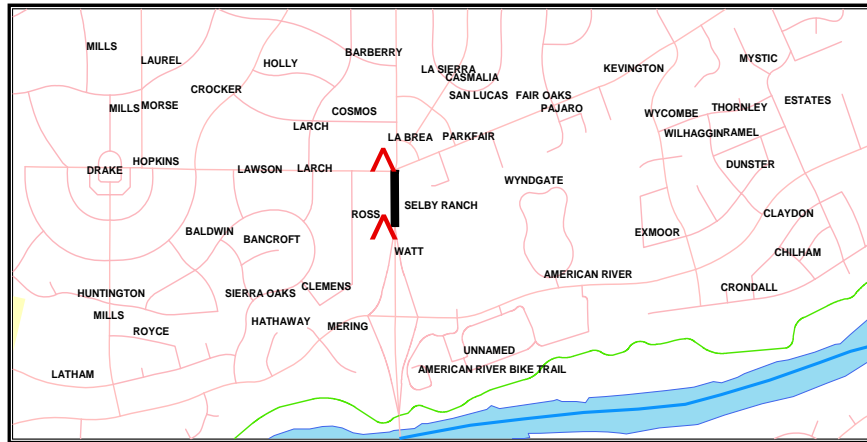

**Project Description:**

The proposed project will add a right turn lane on Watt Avenue approaching the southeast corner of Fair Oaks Boulevard and Watt Avenue. The right turn lane will also serve as a “queue jump” for the buses that use the corridor, thus allowing for a more efficient transit route at this location. All four corners of the intersection will need to be upgraded for Americans with Disabilities Act (ADA) improvements, including audible signals, push buttons, sidewalk ramps, and re-striping. The four corners of the intersection will also be landscaped and will have a decorative wall treatment consistent with Watt Avenue corridor master plan. The objectives of the project are to improve traffic safety, pedestrian safety, transit efficiency, and the overall aesthetics of the intersection.

Watt Avenue Queue Jump and Right Turn Lane Project

Project Costs	Prior Years	Fiscal Year 2007-08	Fiscal Year 2008-09	Fiscal Year 2009-10	Fiscal Year 2010-11	Fiscal Year 2011-12	Total
Construction Costs	0	703,000	506,000	0	0	0	1,209,000
Project Management/Design	278,000	48,000	0	0	0	0	326,000
Right-of-Way Purchase	28,000	581,000	0	0	0	0	609,000
Construction Inspection	0	48,000	18,000	0	0	0	66,000
<b>TOTAL</b>	<b>306,000</b>	<b>1,380,000</b>	<b>524,000</b>	<b>0</b>	<b>0</b>	<b>0</b>	<b>2,210,000</b>

Funding Sources	Prior Years	Fiscal Year 2007-08	Fiscal Year 2008-09	Fiscal Year 2009-10	Fiscal Year 2010-11	Fiscal Year 2011-12	Total
Measure A Sales Tax	206,000	1,005,000	274,000	0	0	0	1,485,000
TEA-21 (ITS)	100,000	375,000	250,000	0	0	0	725,000
<b>TOTAL</b>	<b>306,000</b>	<b>1,380,000</b>	<b>524,000</b>	<b>0</b>	<b>0</b>	<b>0</b>	<b>2,210,000</b>

**White Rock Road Improvements**

**Department:** Transportation

**Estimated Project Cost:** \$26,600,000

**Expected Completion Date:** 2012

**Funding Sources:** Other (CMIA)  
Other (Local)

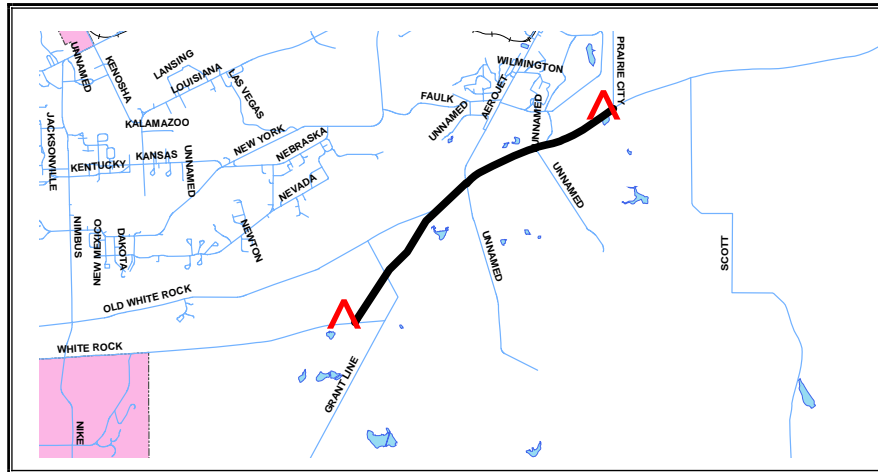

**Project Description:**

In order to relieve congestion and improve regional traffic circulation in eastern Sacramento County, the 50 Corridor Mobility Partnership has identified the need for improvements along White Rock Road from Grant Line Road to Prairie City Road. The proposed improvements consist of constructing a four-lane roadway along the existing road alignment of White Rock Road.

This project has approved funding from the Corridor Management Improvement Account (CMIA).

White Rock Road Improvements

Project Costs	Prior Years	Fiscal Year 2007-08	Fiscal Year 2008-09	Fiscal Year 2009-10	Fiscal Year 2010-11	Fiscal Year 2011-12	Total
Construction Costs	0	0	0	0	7,375,000	9,875,000	17,250,000
Project Management/ Design	100,000	1,300,000	100,000	2,000,000	0	0	3,500,000
Right-of-Way Purchase	0	0	0	4,000,000	0	0	4,000,000
Construction Inspection	0	0	0	0	925,000	925,000	1,850,000
<b>TOTAL</b>	<b>100,000</b>	<b>1,300,000</b>	<b>100,000</b>	<b>6,000,000</b>	<b>8,300,000</b>	<b>10,800,000</b>	<b>26,600,000</b>

Funding Sources	Prior Years	Fiscal Year 2007-08	Fiscal Year 2008-09	Fiscal Year 2009-10	Fiscal Year 2010-11	Fiscal Year 2011-12	Total
Other (CMIA)	100,000	1,300,000	100,000	2,000,000	7,700,000	10,800,000	22,000,000
Other (Local)	0	0	0	4,000,000	600,000	0	4,600,000
<b>TOTAL</b>	<b>100,000</b>	<b>1,300,000</b>	<b>100,000</b>	<b>6,000,000</b>	<b>8,300,000</b>	<b>10,800,000</b>	<b>26,600,000</b>